

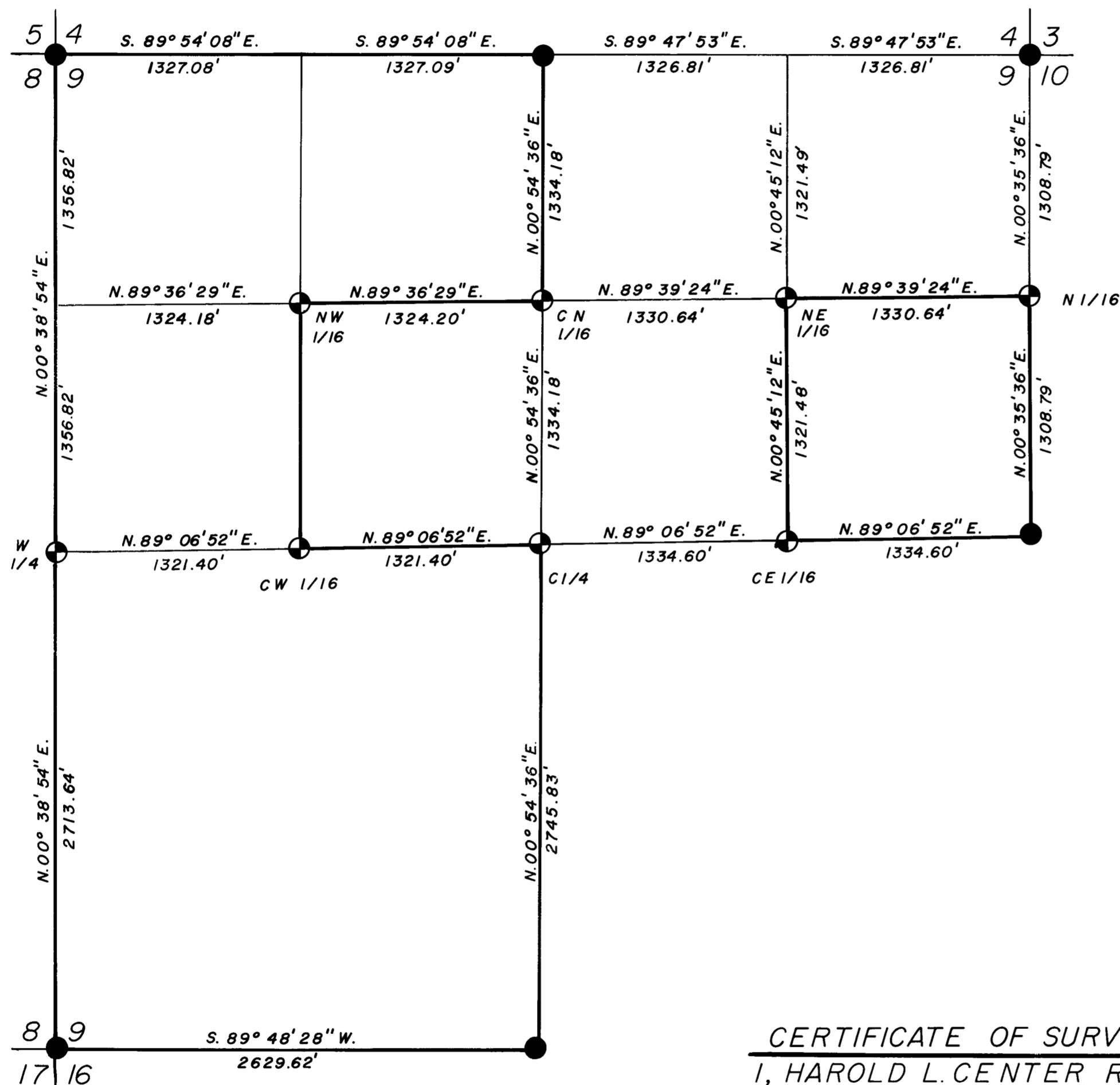

R. 3 E.

T. 36 S.



MAP OF SURVEY  
 LOCATED IN  
 SEC. 9 T.36S., R.3 E., W.M.  
 JACKSON CO. OREGON  
 FOR  
**ROGUE RIVER NAT. FOREST**  
 AND  
**MEDFORD RESOURCES CORP.**

DECEMBER 20, 1977

BASIS OF BEARING-SOLAR OBSERVATION  
 SCALE 1" = 600'

- FOUND STANDARD B.L.M. MONUMENT
- ⊕ SET 2 1/2" DIA. X 30" LG. IRON POST WITH 2 1/2" DIA. BRASS CAP



CERTIFICATE OF SURVEY  
 I, HAROLD L. CENTER REGISTRATION N° 1071  
 REGISTERED PROFESSIONAL LAND SURVEYOR  
 STATE OF OREGON, HEREBY CERTIFY THAT  
 THIS MAP CORRECTLY REPRESENTS A SURVEY  
 MADE BY ME OR UNDER MY DIRECTION IN  
 CONFORMANCE WITH THE LAWS OF THE  
 STATE OF OREGON, AT THE REQUEST OF  
 THE U.S. FOREST SERVICE.



U.S. DEPARTMENT OF AGRICULTURE FOREST SERVICE	
REGION 6	ROGUE RIVER NAT. FOREST
DEPENDENT RESURVEY AND SECTION SUBDIVISION; T.36S., R.3E., SEC. 9, W.M.	
SURVEYED BY <u>Harold L. Center</u>	DATE <u>Dec. 12, 1977</u>
FOREST SURVEYOR	
REVIEWED BY <u>Donald L. McDonald</u>	DATE <u>Jan 4, 1978</u>
OPS. ENG.	
APPROVED BY <u>R.J. Hathaway</u>	DATE <u>1-4-78</u>
FOREST ENG.	

S9 36.3E (TL 1000, 1200)

From which the following references:

A fir 17 inches in diameter bears S87° 23'E, 13.10 feet distance, scribed NW 1/16 S9 LS 1071 BT.

A fir 22 inches in diameter bears N03° 44'W, 17.80 feet distance, scribed NW 1/16 S9 LS 1071 BT.

HAROLD L. CENTER  
Registered Professional Surveyor  
Oregon Certificate No. 1071

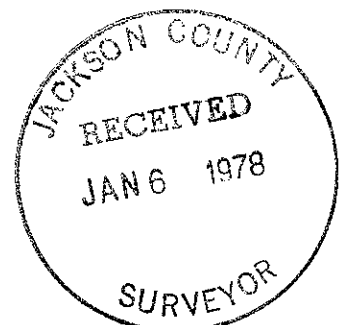
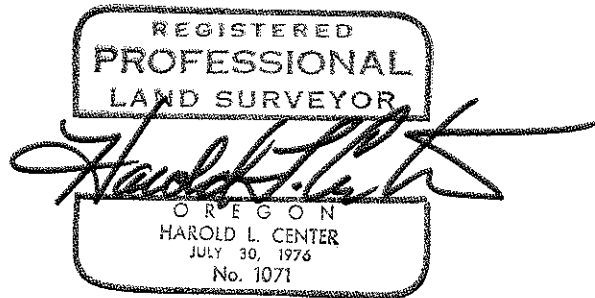

From which the following references:

A fir 9 inches in diameter bears N84° 24'E, 13.00 feet distance, scribed  
C 1/4 S9 LS 1071 BT.

A yew 6 inches in diameter bears N11° 16'W, 19.50 feet distance, scribed  
C 1/4 S9 LS 1071 BT.

Centernorth one-sixteenth corner Section 9, Township 36 South, Range 3 East,  
Willamette Meridian.

At the corner location I set a 2 1/2 inch diameter galvanized iron post with  
2 1/2 inch diameter brass cap marked:

T36S            |            R3E  
                 CN 1/16 — | — S9  
                                 |  
                                 1977  
                                 LS 1071

From which the following references:

A fir 12 inches in diameter bears S66° 07'W, 17.20 feet distance, scribed  
CN 1/16 S9 LS 1071 BT.

A fir 8 inches in diameter bears N18° 46'E, 27.40 feet distance, scribed  
CN 1/16 S9 LS 1071 BT.

Centerwest one-sixteenth corner Section 9, Township 36 South, Range 3 East,  
Willamette Meridian.

At the corner position I set a 2 1/2 inch diameter galvanized iron post with  
2 1/2 inch diameter brass cap marked:

T36S            |            R3E  
                 CW 1/16 — | — S9  
                                 |  
                                 1977  
                                 LS 1071

From which the following references:

A fir 17 inches in diameter bears S50° 56'E, 17.50 feet distance, scribed  
CW 1/16 S9 LS 1071 BT.

A pine 19 inches in diameter bears S66° 00'W, 4.00 feet distance, scribed  
CW 1/16 S9 LS 1071 BT.

Northwest one-sixteenth corner Section 9, Township 36 South, Range 3 East,  
Willamette Meridian.

At the corner position I set a 2 1/2 inch diameter galvanized iron post with  
2 1/2 inch diameter brass cap marked:

T36S            |            R3E  
                 NW 1/16 — | — S9  
                                 |  
                                 1977  
                                 LS 1071

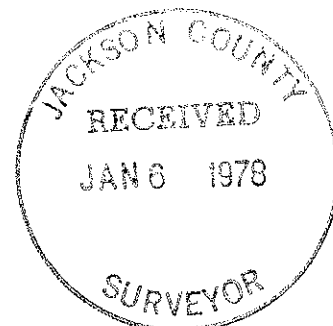

From which the following references:

A fir 10 inches in diameter bears S30° 47'E, 49.90 feet distance, scribed N 1/16 S10 LS 1071 BT.

A cedar 17 inches in diameter bears N21° 41'W, 23.80 feet distance, scribed N 1/16 S9 LS 1071 BT.

Center east one-sixteenth corner Section 9, Township 36 South, Range 3 East, Willamette Meridian.

At the corner position I set a 2 1/2 inch diameter galvanized iron post with a 2 1/2 inch diameter brass cap marked:

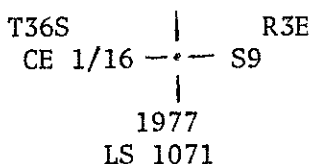

From which the following references:

A fir 8 inches in diameter bears S11° 57'W, 6.21 feet distance, scribed CE 1/16 S9 LS 1071 BT.

A fir 10 inches in diameter bears N48° 28'E, 11.70 feet distance, scribed CE 1/16 S9 LS 1071 BT.

Northeast one-sixteenth corner Section 9, Township 36 South, Range 3 East, Willamette Meridian.

At the corner position I set a 2 1/2 inch diameter galvanized iron post with a 2 1/2 inch diameter brass cap marked:

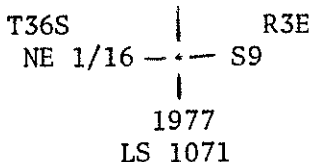

From which the following references:

A fir 8 inches in diameter bears N83° 26'E, 7.50 feet distance, scribed NE 1/16 S9 LS 1071 BT.

A fir 12 inches in diameter bears S28° 37'W, 10.90 feet distance, scribed NE 1/16 S9 LS 1071 BT.

Center one-quarter corner Section 9, Township 36 South, Range 3 East, Willamette Meridian.

At the corner position I set a 2 1/2 inch diameter galvanized iron post with a 2 1/2 inch diameter brass cap marked:

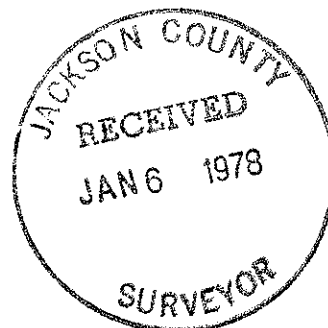
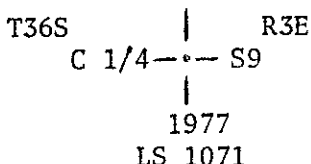





A fir 11 inches in diameter, bears S26°, 00'W, 41.06 feet distance.

A pine stump 19 inches in diameter, bears S83° 12'W, 22.78 feet distance, scribe visible.

One quarter corner common to Sections 9 and 10, Township 36 South, Range 3 East, Willamette Meridian.

At the corner location I found a standard BLM monument marked:

U. S. Dept. of Interior  
Cadastral Surveys  
Unlawful to Disturb

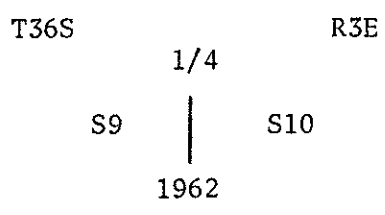

From which the following references:

A fir 19 inches in diameter, bears S80° 38'E, 9.65 feet distance, healed scar.

A fir 14 inches in diameter bears S48° 56'E, 13.35 feet distance, healed scar.

A fir 8 inches in diameter bears S34° 29'W, 13.60 feet distance, healed scar.

A cedar 19 inches in diameter bears N48° 40'W, 8.05 feet distance, healed scar.

One-quarter corner common to Sections 9 and 16, Township 36 South, Range 3 East, Willamette Meridian.

At the corner location I found a standard BLM monument marked:

U. S. Dept. of Interior  
Cadastral Surveys  
Unlawful to Disturb

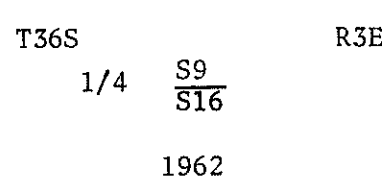

From which the following references:

A fir 10 inches in diameter bears N62° 22'E, 8.62 feet distance, healed scar.

A fir 18 inches in diameter bears S28° 26'W, 42.35 feet distance, healed scar.

A fir 19 inches in diameter bears S55° 14'W, 10.70 feet distance, scribe visible. This tree is now dead.

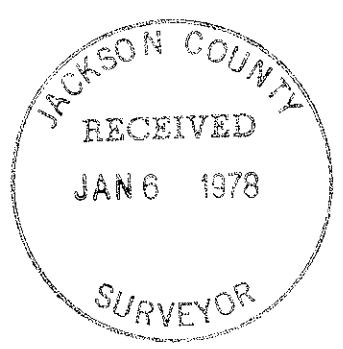

7056

Survey No. \_\_\_\_\_

Page 1 of 7

SURVEY NARRATIVE TO COMPLY WITH  
PARAGRAPH 209.50 OREGON REVISED STATUTES

Survey for: Rogue River National Forest  
P. O. Box 520  
Medford, Oregon 97501

and

Medford Resources Corporation  
P. O. Box 550  
Medford, Oregon 97501

Location: Section 9, Township 36, South, Range 3 East,  
Willamette Meridian, Jackson County, Oregon

Purpose: To establish common boundaries between Rogue  
River National Forest and Medford Resources  
Corporation ownership.

Procedure: Enclosed traverse was ran tying corners around  
the perimeter of Section 9 with interior traverse  
lines run tying to the perimeter traverse. From  
this data true lines were computed and corners  
were established at the locations as shown on  
the attached map.

Corners Accepted for Control

Section corner common to Sections 3, 4, 9 and 10, Township 36 South, Range 3  
East, Willamette Meridian.

At the corner location I found a standard Bureau of Land Management 2 1/2 inch  
iron post with brass cap marked:

U. S. Dept. of Interior  
Cadastral Surveys  
Unlawful to Disturb

T36S		R3E				
	<table border="1"> <tr> <td>S4</td> <td>S3</td> </tr> <tr> <td>S9</td> <td>S10</td> </tr> </table>	S4	S3	S9	S10	
S4	S3					
S9	S10					

1962

From which the following references:

A fir 8 inches in diameter, bears N32° 20'W, 33.75 feet distance.

A fir 8 inches in diameter, bears N37° 31'E, 13.65 feet distance.

A yew 9 inches in diameter, bears S63° 56'E, 32.50 feet distance, scribe  
visible.

A fir 25 inches in diameter, bears S17° 00'E, 22.40 feet distance. This  
tree is dead.

