

MAP OF SURVEY
 LOCATED IN
 SEC. 32 T. 40S., R. 3W., W. M.
 JACKSON CO. OREGON
 FOR
 ROGUE RIVER NATIONAL FOREST
 AND
 LORIN SEVERSON
 SEPTEMBER 15, 1977

LEGEND

- STANDARD B.L.M. MONUMENT
- ⊕ SET 2 1/2" DIA. X 30" LG. IRON POST WITH 2 1/2" DIA. BRASS CAP
- ⊠ SET 1/2" REBAR IN TREE ROOT OR MARKED TREE FOR CORNER (SEE NARRATIVE FOR DETAILS)
- ==== NATIONAL FOREST BOUNDARY
- BASIS OF BEARING — SOLAR OBSERVATION

CERTIFICATE OF SURVEY

I, HAROLD L. CENTER REGISTRATION NO 1071 REGISTERED PROFESSIONAL LAND SURVEYOR, STATE OF OREGON, HEREBY CERTIFY THAT THIS PLAT CORRECTLY REPRESENTS A SURVEY MADE BY ME OR UNDER MY DIRECTION IN CONFORMANCE WITH THE LAWS OF THE STATE OF OREGON, AT THE REQUEST OF THE U.S. FOREST SERVICE.

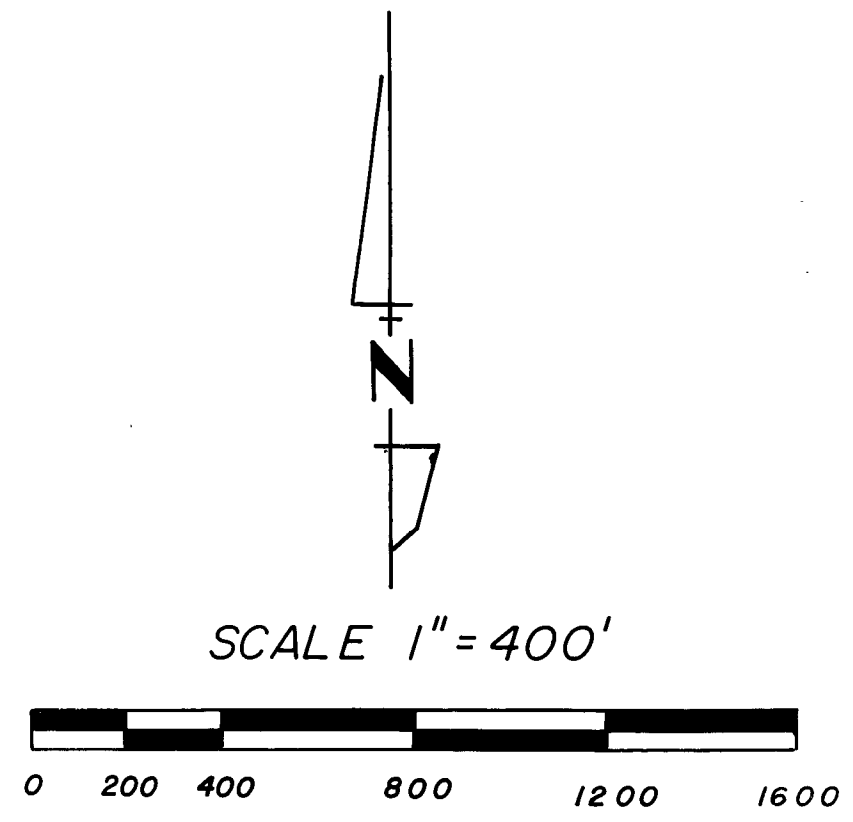
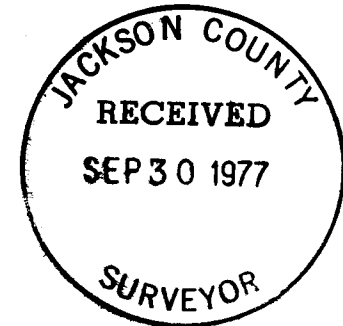
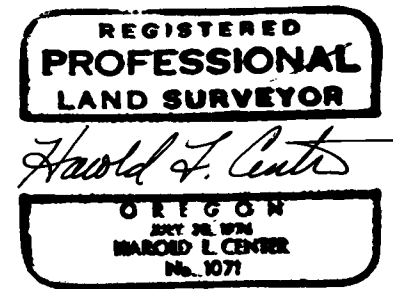

U.S. DEPARTMENT OF AGRICULTURE	
FOREST SERVICE	
REGION 6	ROGUE RIVER NAT. FOR.
DEPENDENT SURVEY AND SECTION SUBDIVISION	
TOWNSHIP 40 SOUTH, RANGE 3 WEST, SECTION 32 WILLAMETTE MERIDIAN, JACKSON CO. OREGON	
SURVEYED BY <i>M.L. Center</i>	DATE <u>9-77</u>
CHECKED BY <i>H.L. Center</i>	DATE <u>9-77</u>
APPROVED <i>H.L. Center</i>	OPERATIONS DATE <u>9-77</u>
APPROVED <i>R.J. Hathaway</i>	FOREST ENG. DATE <u>9-77</u>

Southeast-Northwest 1/64, Section 32, Township 40 South, Range 3 West, Willamette Meridian.

At the corner location I set a ½ inch diameter iron rebar in a root on the Northeast quadrant of a 26 inch diameter Douglas-fir

From which the following references:

A Douglas-fir 26 inch in diameter bears S16°30'E, 3.00 feet distance; scribed MT on single blaze.

A Douglas-fir 22 inch diameter bears N61°05'E, 22.20 feet distance; scribed SE NW 1/64 S32 LS 1071 BT.

A ponderosa pine 24 inch diameter bears N37°22'W, 30.80 feet distance; scribed SE NW 1/64 S32 LS 1071 BT.

HAROLD L. CENTER
Registered Professional Land Surveyor
Oregon Certificate No. 1071

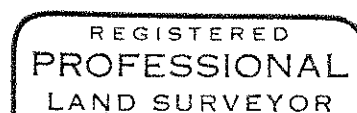

Harold L. Center

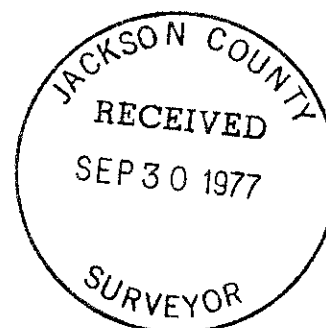
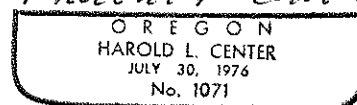

North 1/16 Sections 31 and 32, Township 40 South, Range 3 West, Willamette Meridian.

At the corner location I set a 2½ inch diameter galvanized iron post with a 2½ inch diameter brass cap, marked:

T. 40 S., R. 3 W., W.M.
 N 1/16
 S.31 S.32
 L.S.1071
 1977

From which the following references:

A 8 inch diameter Douglas-fir bears S5°27'E, 40.20 feet distance; scribed N 1/16 S32 LS 1071 BT.

A 16 inch diameter Douglas-fir bears N88°53'W, 48.50 feet distance; scribed N 1/16 S32 LS 1071 BT.

South-North 1/64, Sections 31 and 32, Township 40 South, Range 3 West, Willamette Meridian.

At the corner location I set a 2½ inch diameter galvanized iron post with a 2½ inch diameter brass cap, marked:

T. 40 S., R. 3 W. W.M.
 S.N. 1/64
 S.31 S.32
 L.S. 1071
 1977

From which the following references:

A 9 inch diameter Douglas-fir bears N13°23'E, 21.20 feet distance; scribed SN 1/64 S32 LS 1071 BT.

A 9 inch diameter sugar pine bears S80°35'W, 33.60 feet distance; scribed SN 1/64 S31 LS 1071 BT.

Center 1/4, Section 32, Township 40 South, Range 3 West, W.M.

At the corner location I set a 2½ inch diameter galvanized iron post with a 2½ inch diameter brass cap, marked:

T. 40 S., R. 3 W., W.M.
 C¼
 S.32
 LS 1071
 1977

From which the following references:

A 9 inch diameter ponderosa pine bears N21°52'E, 7.10 feet distance; scribed C¼ S32 LS 1071 BT.

A 13 inch diameter Douglas-fir bears N71°05'W, 10.80 feet distance; scribed C¼ S32 LS 1071 BT.

Center North-Northwest 1/64, Section 32, Township 40 South, Range 3 West, Willamette Meridian.

At the corner location, I set a 2½ inch diameter galvanized iron post with a 2½ inch diameter brass cap, marked:

T. 40 S., R. 3 W., W.M.
C.N.NW.
1/64
S.32
L.S. 1071
1977

From which the following references:

A 18 inch diameter Douglas-fir bears S23°12'W, 5.47 feet distance; scribed CNNW 1/64 S32 LS 1071 BT.

A 9 inch diameter Douglas-fir bears S87°15'W, 29.40 feet distance; scribed CNNW 1/64 S32 LS 1071 BT.

Northwest-Northwest 1/64, Section 32, Township 40 South, Range 3 West, Willamette Meridian.

At the corner location I set a 2½ inch diameter galvanized iron post with a 2½ inch diameter brass cap, marked:

T. 40 S., R. 3 W., W.M.
NW.NW
1/64
S32
L.S. 1071
1977

From which the following references:

A 12 inch diameter Douglas-fir bears N36°30'E, 21.50 feet distance; scribed NW NW 1/64 S32 LS 1071 BT.

A 10 inch diameter Douglas-fir bears S34°55'E, 14.70 feet distance; scribed NW NW 1/64 S32 LS 1071 BT.

North-North 1/64, Sections 31 and 32, Township 40 South, Range 3 West, Willamette Meridian.

At the corner location, I set a 2½ inch diameter galvanized iron post with a 2½ inch diameter brass cap, marked:

T. 40 S., R. 3 W., W.M.
N.N. 1/64
S.31 | S.32
LS 1071
1977

From which the following references:

A 18 inch diameter ponderosa pine bears S67°55'E, 39.40 feet distance; (both corner and pine BT lie in old mining flue) scribed NN 1/64 S32 LS 1071 BT.

A 9 inch diameter black oak bears N15°02'W, 38.00 feet distance; scribed NN 1/64 S31 LS 1071 BT.

Center-North-Northeast-Northwest 1/256, Section 32, Township 40 South, Range 3 West, Willamette Meridian.

At the corner location I set a 2½ inch diameter galvanized iron post with a 2½ inch diameter brass cap, marked:

T. 40 S., R. 3 W., W.M.
 C.N.NE.
 NW
 1/256 S.32
 L.S. 1071
 1977

From which the following references:

A 12 inch diameter Douglas-fir bears S69°44'E, 7.30 feet distance; scribed CNNENW 1/256 S32 LS 1071 BT.

A 14 inch diameter Douglas-fir bears N4°36'E, 8.50 feet distance; scribed CNNENW 1/256 S32 LS 1071 BT.

East-West 1/64 of Sections 29 and 32, Township 40 South, Range 3 West, Willamette Meridian.

At the corner location I set a 2½ inch diameter galvanized iron post with a 2½ inch diameter brass cap, marked:

T. 40 S., R. 3 W., W.M.
 E.W. 1/64
 S.29

 S.32
 L.S. 1071
 1977

From which the following references:

A 10 inch diameter Douglas-fir bears S34°10'W, 4.70 feet distance; scribed EW 1/64 S32 LS 1071 BT.

A 10 inch diameter ponderosa pine bears N75°36'W, 55.60 feet distance; scribed EW 1/64 S29 LS 1071 BT.

West 1/16 of Section 29 and 32, Township 40 South, Range 3 West, Willamette Meridian.

At the corner location I set a 2½ inch diameter galvanized iron post with a 2½ inch diameter brass cap, marked:

T. 40 S., R. 3 W., W.M.
 W 1/16
 S. 29

 S. 32
 L.S. 1071
 1977

From which the following references:

A 27 inch diameter ponderosa pine bears N36°34'W, 70.50 feet distance; scribed W 1/16 S29, LS 1071, BT.

A ½ inch diameter iron rebar set in a 5-foot by 5 foot by 2-foot high mound of rock, bears S83°06'E, 16.04 feet distance.

Center-South-Northeast-Northwest 1/256 corner Section 32, Township 40 South, Range 3 West, Willamette Meridian.

At the corner location I set a 2½ inch diameter galvanized iron post with a 2½ inch diameter brass cap, marked:

T. 40 S., R. 3 W., W.M.
C.S.NE.NW.
1/256
S.32
L.S. 1071
1977

From which the following reference:

A 10 inch diameter pine, bears S75°54'E, 30.10 feet distance; scribed CS NE NW 1/256 S32 LS 1071 BT.

A 16 inch diameter Douglas-fir bears S26°57'W, 20.30 feet distance; scribed CS NE NW 1/256 S32 LS 1071 BT.

Center-South-North-North 1/256, Section 32, Township 40 South, Range 3 West, Willamette Meridian.

The corner location falls on the northwest face of a 16 inch diameter black oak. I established this tree a monument tree and scribed the northwest face of the tree:

MT T40S R3W S32
LS 1071 MT
CS NN 1/256

From which the following reference:

A 37 inch diameter Douglas-fir bears N49°38'E, 39.60 feet distance; scribed CSNN 1/256 S32 LS 1071 BT.

A 12 inch diameter Douglas-fir bears S21°52'E, 32.20 feet distance; scribed CSNN 1/256 S32 LS 1071 BT.

Center-North-North 1/64, Section 32, Township 40 South, Range 3 West, Willamette Meridian.

At the corner location, I set a 2½ inch diameter galvanized iron post with a 2½ inch diameter brass cap, marked:

T. 40 S, R. 3 W., W.M.
CNN
S.32
1/64
L.S. 1071
1977

From which the following references:

A 25 inch diameter ponderosa pine, bears N77°33'E, 19.36 feet distance; scribed CNN 1/64 S32 LS 1071 BT.

A 20 inch diameter Douglas-fir bears N29°32'W, 28.40 feet distance; scribed CNN 1/64 S32 LS 1071 BT.

Center-West-Northwest, 1/64, Section 32, Township 40 South, Range 3 West, Willamette Meridian.

At the corner location I set a 2½ inch diameter galvanized iron post with a 2½ inch diameter brass cap, marked:

T. 40 S., R. 3 W., W.M.
C.W.NW. 1/64

S32
L.S. 1071
1977

From which the following references:

A 9 inch diameter Douglas-fir bears S14°36'E, 18.20 feet distance; scribed CWNW 1/64 S32 LS 1071 BT.

A 9 inch diameter Douglas-fir bears N69°41'W, 4.70 feet distance; scribed CWNW 1/64, LS 1071 BT.

Northwest 1/16, Section 32, Township 40 South, Range 3 West, Willamette Meridian.

At the corner location I set a 2½ inch diameter galvanized iron post with a 2½ inch diameter brass cap, marked:

T. 40 S., R. 3 W., W.M.
NW 1/16

S32
L.S. 1071
1977

From which the following references:

A 15 inch diameter Douglas-fir bears N40°30'E, 35.30 feet distance; scribed NW 1/16 S32 LS 1071 BT.

A 12 inch diameter Douglas-fir bears S35°50'E 23.70 feet distance; scribed NW 1/16 S32 LS 1071 BT.

Center-East-Northwest 1/64, Section 32, Township 40 South, Range 3 West, Willamette Meridian.

At the corner location I set a 2½ inch diameter galvanized iron post with a 2½ inch diameter brass cap, marked:

T. 40 S., R. 3 W., W.M.
C.E.NW.
1/64

S32
L.S. 1071
1977

From which the following references:

An 11 inch diameter pine bears S7°44'W, 22.30 feet distance; scribed CENW 1/64 S32 LS 1071 BT.

A 14 inch diameter pine bears N42°55'W, 23.00 feet distance; scribed CENW 1/64 S32 LS 1071 BT.

Section corner common to Sections 30, 29, 31 and 32 of Township 40 South, Range 3 West, Willamette Meridian.

At corner point I found a 2½" diameter galvanized iron post with a 3" diameter brass cap set in a mound of stones, marked:

U.S. Bureau of Land Management
Cadastral Survey
Unlawful to Disturb
T. 40 S., R. 3 W.
S30 | S29
S31 | S32
1964

From which the following references:

- A 10 inch diameter black oak with no blaze visible but has a BT tag bears N40°12'E for 93.29 feet distance.
- A 29 inch diameter ponderosa pine with healed scar bears S21°51'E for 200.36 feet distance.
- A 19 inch diameter black oak with healed scar bears S13°03'W for 14.01 feet distance.
- A 7 inch diameter black oak with visible scribing bears S61°58'W for 38.89 feet distance.
- A pile of rocks with scribing "BX0" bears N8°05'W for 56.89 feet distance.

Quarter corner common to Sections 29 and 32, Township 40 South, Range 3 West, Willamette Meridian.

At the corner I found a 2½" diameter galvanized iron post with a 3" diameter brass cap set in a mound of stones marked:

U.S. Bureau of Land Management
Cadastral Survey
Unlawful to Disturb
T. 40 S., R. 3 W.
¼ | S29
S32
1964

From which the following references:

- A 8 inch diameter canyon live oak with healed scar bears N45°05'E for 49.23 feet distance.
- A 10 inch diameter black oak with healed scar bears S56°30'E for 46.41 feet distance.
- A 5 inch diameter black oak with healed scar bears S18°42'E for 28.36 feet distance.

Corners Established This Survey:

Center-North-North-North 1/256, Section 32, Township 40 South, Range 3 West, Willamette Meridian.

At the corner location I set a 2½ inch diameter galvanized iron post with a 2½ inch diameter brass cap. Brass cap marked:

T. 40 S., R. 3 W., W.M.
C.N.N.N. 1/256
S32
L.S. 1071
1977

From which the following reference:

- A 15 inch diameter Douglas-fir bears N11°30'E, 14.02 feet distance; scribed CNNN 1/256, LS 1071, BT.
- A 12 inch diameter ponderosa pine, bears S70°00'W, 49.27 feet distance; scribed CNNN 1/256 LS 1071 BT.

Corners Accepted for Control:

Quarter corner to Township 40 South, Range 3 West, Section 32 and
Township 41 South, Range 3 West, Section 5, Willamette Meridian.

At the corner point I found a 2½" diameter galvanized iron post with a 3" diameter brass cap set in a mound of stones, marked:

U.S. Bureau of Land Management
Cadastral Survey
Unlawful to disturb
T. 40 S. R. 3 W.
¼ cor. S32
 S5
T. 41 S. R. 3 W.
1974

From which the following references:

A 8 inch diameter, yellow pine with visible scribing bears S08°00'E, 4.40 feet distance.
A 6 inch diameter, yellow pine with visible scribing bears N35°00'W 6.60 feet distance.

Quarter corner common to Sections 32 and 33, Township 40 South, Range 3 West, Willamette Meridian.

At the corner point I found a 2½" diameter galvanized iron post with a 3 inch diameter brass cap marked:

U.S. Bureau of Land Management
Cadastral Survey
Unlawful to Disturb
T. 40 S. R. 3 W.
 ¼
S32 | S 33
 |
 1964

From which the following references:

A 16 inch diameter ponderosa pine with visible scribing bears S45°04'E for 24.39 feet distance.

A 10 inch diameter ponderosa pine stump with healed scar bears S58°20'W for 29.33 feet distance. Tree dead and down.

Quarter corner common to Sections 31 and 32, Township 40 South, Range 3 West, Willamette Meridian.

At the corner point I found a 2½" diameter galvanized iron post with a 3" diameter brass cap marked:

U.S. Bureau of Land Management
Cadastral Survey
Unlawful to Disturb
T. 40 S., R. 3 W.
S31 | S32
 |
 ¼
 1964

From which the following references:

A 22 inch diameter Douglas-fir with healed scar bears N33°13'E for 24.33 feet distance.
A 8 inch diameter Douglas-fir with healed scar bears S59°13'E for 15.89 feet distance.
A 13 inch diameter Douglas -fir with healed scar bears S47°51'W for 39.32 feet distance.
A 40 inch diameter Douglas-fir with healed scar bears N15°44'W for 35.08 feet distance.

SURVEY NARRATIVE TO COMPLY WITH
OREGON REVISED STATUTES ORS. 209.250

Survey For: Rogue River National Forest
 P. O. Box 520
 Medford, Oregon 97501
 and
 Lorin Severson
 2002 French Gulch Road
 Jacksonville, Oregon 97530

Location: Township 40 South, Range 3 West, Willamette
 Meridian, Section 32, Northwest Quarter (¼)

Basis of Bearing: Solar observation

Purpose: To monument the property as shown on the
 attached map of survey.

Procedure:

A traverse was run tying the north, south, east, west quarter corners and northwest section corner of Section 32. The above corners were incorporated in a closed traverse, from this control the northwest quarter was subdivided and corners set to monument the tract of land as shown on the accompanying map. Work was performed using a Wild T-16 Theodolite and Hewlett Packard 3805A Electronic Distance Meter.