

BASIS OF BEARINGS:  
RECORDED SURVEY 3140

SCALE 1"=200'

6882

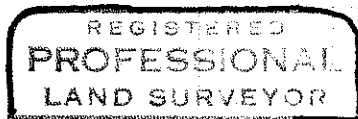
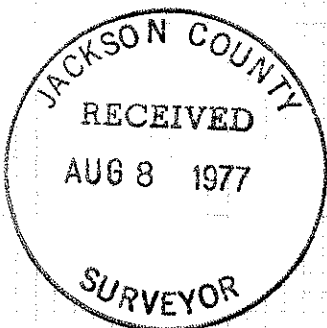

*George Burrell*

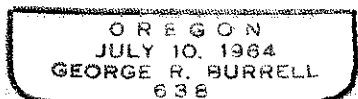

**MAP OF SURVEY**

Located in NE<sub>4</sub> Sec. II, T40S R3E

For: HAROLD WALTERS

By: Geo. Burrell, Surveyor

July 20, 1977

6882

S11 T40S3E (T.L. 1100)

SURVEY NARRATIVE TO COMPLY WITH C.R.S. 209,250

FOR: Harold Walters  
1205 W Cypress Sp. 22  
San Dimas, Calif. 91773

PURPOSE: To locate and mark the West boundary of the Walters ownership according to a contract description furnished by the client.

PROCEDURE: Said boundary was established at record distance East of the 1/4 corner to sections 2 and 11. the line was then run due South and marked with wood stakes at approx. 200' intervals.

REGISTERED  
PROFESSIONAL  
LAND SURVEYOR  
*George Burrell*  
OREGON  
JULY 10, 1964  
GEORGE R. BURRELL  
638

JACKSON COUNTY  
RECEIVED  
AUG 8 1977  
SURVEYOR