



6817

SURVEY NARRATIVE TO COMPLY WITH PARAGRAPH 209.250  
OREGON REVISED STATUTES

Survey for: Joseph D. Sturges  
5645 Tolo Road  
Central Point, Ore.

Survey by : Charles H. Hurst  
304 South Holly  
Medford, Ore.

Meridian : As determined by Survey No. 3388.

Purpose : To determine the location of Lots 3 and 4, Block 13  
of College Hill Addition.

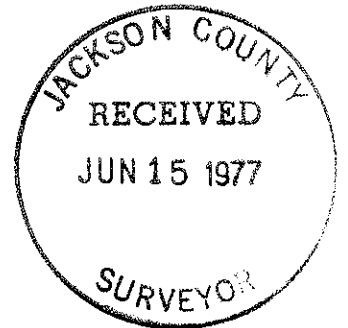

Procedure

In that the official plats for Fairview South Childers Eastern Addition and College Hill Addition make no reference to the 1/4 corner common to Sections 19 and 20, it is readily apparent that holding the platted centerline for Spring Street 30 feet Southerly therefrom in accordance with the 1910 road petition would be an unverified assumption.

With the recovery of the northwest corner of College Hill Addition during the course of Survey No. 4296 and the agreement with the inversed location for the southwest corner of Fairview as derived from College Hill plat data, the present location for the northeast corner of Laurelhurst Addition was held as a common corner and the prorata determination for block corners was thus accomplished along the entire westerly line of College Hill Addition.

Inspection of original field notes pertaining to said Addition by Astbury and Tee make no reference to the above mentioned 1/4 corner. However, the field notes do indicate A&T held the southwest corner of Fairview at or very close to the presently monumented northeast corner of Laurelhurst Addition which appears reasonable since both Additions are of 1911 vintage.

In consideration that A&T were attempting to retrace Fairview, it is apparent that the aforementioned 1/4 corner, if found, would have been held for line only.

A slight deviation from proportionate remeasurement was made in order to hold the location of the 5/8" iron pin on the as monumented centerline of Spring Street at Waverly (now Keene Way). This deviation amounts to 14 seconds of angle clockwise added to the computed bearing of said Street.

An unrecorded survey by Hugh Ingle was made in Block 13 resulting in the location of some fencelines at monumented positions some 5 feet Westerly from the locations for lot corners as determined by this survey.

It should be noted that the foregoing procedure is at variance with that utilized by some surveyors who adhere to the notion that the College Hill location for the centerline of Spring Street should be held 30 feet South of the 1/4 corner at Wabash Avenue. This surveyor cannot agree that the resulting 4.41 foot excess should be added proportionately to record dimensions South of Spring Street and subtracted proportionately from those to the North.

May 2, 1977

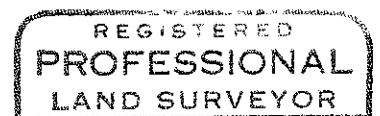

*Charles H. Hurst*

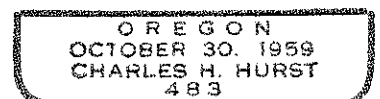

6817