

FOUND NORTHWEST CORNER
D.L.C. 66 A 1/2" IRON PIPE
8" BELOW PAVEMENT SURFACE
SET 1" DIA. IRON PIPE WITH 2 1/2"
DIA. BRASS CAP FLUSH WITH
PAVEMENT.

INTERSECTION
BEAL LN. &
HANLEY RD.
FOUND BRASS CAP
IN MONU. CASE

FOUND NORTHEAST COR. D.L.C. 44
BRASS CAP 2 1/2" DIA.
IN MONU. CASE

FOUND 2" IRON PIPE
4 REFERENCES

FOUND SOUTHEAST COR.
D.L.C. 44 ALSO NORTHEAST
COR. D.L.C. 43
1 1/2" IRON PIPE

SOUTHEAST CORNER
D.L.C. 43
1" IRON PIPE
REFERENCE

NORTHEAST CORNER
D.L.C. 68
1 1/2" IRON PIPE

MAP OF SURVEY
LOCATED IN
S.W. 1/4 SEC. 10 &
WEST 1/2 SEC. 15
T.37 S., R.2W., W.M.
JACKSON CO. ORE.
FOR
ROGUE RIVER NAT. FOREST
APRIL 5, 1977
SCALE 1" = 200'
BASIS OF BEARING
R. S. 5173

- FOUND IRON PIN
- SET IRON PIN
5/8" DIA. 24" LG.

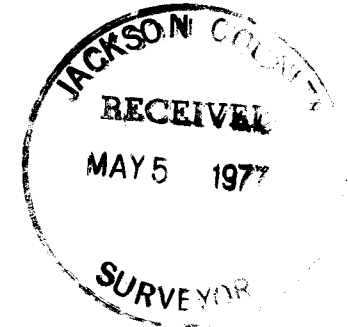

COURSE	BEARING	DIST.	REC. BEARING	REC. DIST.
1	N 26° 47' 42" E	200.80'	N 26° 47' 42" E	197.53'
2	S 26° 47' 42" W	15.00'		
3	S 63° 00' 17" E	276.06'	S 63° 12' 18" E	266.83'
4	S 35° 50' 21" W	15.00'		
5	S 45° 19' 02" E	803.27'	S 46° 18' 18" E	819.78'
6	S 50° 34' 54" W	15.00'		
7	S 33° 31' 09" E	81.93'	S 46° 18' 18" E	30.39'
8	S 60° 36' 18" W	15.00'		
9	S 25° 16' 15" E	365.28'	S 23° 42' 36" E	412.40'
10	S 36° 21' 53" W	15.00'		
11	S 82° 00' 00" E	34.08'		
12	N 00° 04' 50" E	65.60'	S 00° 05' 30" W	65.60'
13	S 89° 57' 10" E	85.83'	S 89° 59' 00" E	84.48'
14	S 89° 57' 10" E	149.58'	S 89° 59' 00" E	138.87'
15	S 89° 48' 16" E	84.68'	EAST	84.48'
16	N 00° 02' 25" W	32.84'		

I HAROLD L. CENTER, A REGISTERED PROFESSIONAL LAND SURVEYOR IN THE STATE OF OREGON, DO HEREBY CERTIFY THAT THIS MAP AND THE NOTES THEREON, OR ATTACHED TO, ARE A CORRECT REPRESENTATION OF A SURVEY PERFORMED BY ME OR UNDER MY DIRECTION DURING APRIL 1977 FOR THE U.S. FOREST SERVICE IN ACCORDANCE WITH THE LAWS OF THE STATE OF OREGON.

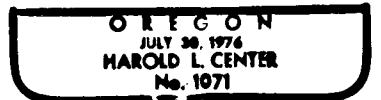
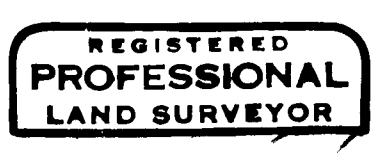

Survey No. 6763

SURVEY NARRATIVE TO COMPLY WITH PARAGRAPH 209.250
OREGON REVISED STATUTES

SURVEY FOR: Rogue River National Forest
P.O. Box 520
Medford, Oregon 97501

LOCATION: West half (1/2) Section 15, Township 37
South, Range 2 West, Willamette Meridian,
Jackson County, Oregon

BASIS OF BEARING: Record survey No. 5173

PURPOSE: To locate and monument the tract of land
owned by the U. S. Forest Service lying
south of the Hopkins Canal centerline as
shown on the attached map of survey.

PROCEDURE: From deed records and recorded surveys,
monuments were recovered and a subsequent
traverse ran tying found monuments. From
this data, control was established and
monuments set as shown on the attached map.

CORNERS ACCEPTED FOR CONTROL:

Southeast Corner Donation Land Claim No. 43.

At this corner I found a 1" inside diameter iron pipe set as reference for corner. I found no other evidence as described in November 21, 1951, Jackson County reestablishment records. I accepted this monument only after verification with other accepted control monuments. This corner was incorporated into a separate reference network with corners found to west. (This survey recorded under separate survey.)

Northeast Corner Donation Land Claim No. 68.

At this corner I found a 1 1/2" diameter iron pipe 14" below the ground surface. References found included a 36" yellow pine and chisled 'x' in Bridge No. 113 as described in Jackson County Second Reestablishment Records of November 8, 1939.

Northwest Corner Donation Land Claim Corner No. 66.

At this corner I opened road pavement and found 8-10" below pavement surface a 1/2" diameter iron pipe with brass fitting, said fitting now broken from top of pipe. My findings were identical to County Road Department findings of May 20, 1970. Original stone reported to be 24-30" below iron rod. At the position held by the found pipe I set a 1" diameter 12" long section of galvanized iron pipe with 2 1/2" diameter bronze cap over the smaller pipe to same elevation as pavement surface. I then backfilled with asphalt to stabilize monument.

Intersection of Hanley Road centerline and Beal Lane centerline.

At this corner I found a standard monument case with properly marked 2 1/2" diameter brass cap monument 12" below surface.

Northeast Corner Donation Land Claim No. 44.

At this corner I found a standard monument case with properly marked 2 1/2" diameter brass cap monument 12" below surface.

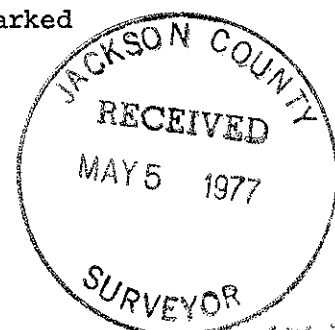

Survey No. **6763**

Section Corner common to 9, 10, 15 and 16 Township 37 South, Range 2 West, W.M.

At this corner I find a 2" diameter iron pipe 6" below surface. Respective references as described in Jackson County reestablishment records of November 21, 1951.

Southeast Corner Donation Land Claim Corner No. 44 also Northeast Corner Donation Land Claim Corner No. 43.

At this corner I found a 1 1/2" diameter iron pipe and respective references as described in Jackson County reestablishment records of November 21, 1951.

In execution of this survey an attempt was made to correlate the deed courses along the centerline of Hopkins Canal with the actual location of the canal centerline. After careful evaluation of the deed description and record courses, I elected to hold the canal centerline as I found the canal this date. (Deed calls are to and along the Hopkins Canal centerline). Longtime residents of the area were questioned to "how long the canal has been in the position as it now exists?" Verbal testimony shows the canal has been in its present position for over 20 years. This is substantiated by dates found on irrigation structures along the canal. (Dates found to October 18, 1957.) I then monumented the tract as shown on the attached map. Witness corners were set at 15.0 foot offset along the southerly line of Hopkins Canal to mark the right-of-way limits of the canal.

Survey was performed using Wild T-2 Theololite and Hewlett-Packard 3800 Electronic Distance Meter.

HAROLD L. CENTER
Registered Professional Land Surveyor
Certificate No. 1071

