

SCALE 1" = 400'
Basis of Bearings R.S.No.6496

LEGEND

- ⊙ = Gov't. cor. (Fd. 1" galv. iron pipe with 2 1/2" brass disc per C.S. Re-estab. record)
- ⊙ = Gov't. cor. (Set 1" x 36" galv. iron pipe with 2 1/2" brass disc, stamped per B.L.M. manual)
- = Set 1" x 30" galv. iron pipe

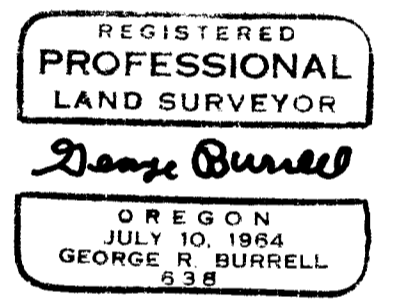
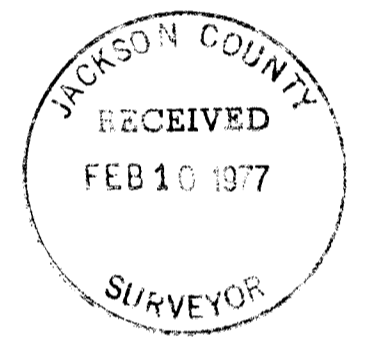

MAP OF SURVEY

Located in Section 27, Twp 38S, R2E
For: DAVID HARRINGTON
By: Geo. Burrell, Surveyor, Nov. 1976

SURVEY NO. 6654

SURVEY NARRATIVE TO COMPLY WITH O.R.S. 209.250

FOR: David Harrington
1352 E. Borchard
Santa Ana, Calif 92705

PURPOSE: To monument the N.E. 1/4 S.W. 1/4 of Section 27, T38S, R2E
lying East of Dead Indian Road.

PROCEDURE: All Government corners found or set were tied in through systems of closed traverse's utilizing a 20" Franke Theodilite and a H.P. 3805 Distance Meter. No original evidence was found for the section corner common to sections 26, 27, 34 and 35, however considerable rock rubble was found around the proportional corner set by my survey. At the 1/4 corner common to sections 26 and 27, I reestablished said corner S 87° 00' W 323.40 feet (record bearing and distance) from the center of a 24" Black Oak stump shell (No scribing visible). This B.O. stump was shown to me by 2 old time resident's of the area to be the original B.T. A Mr. Ray Mitchell and William Gibson related to me that Chester Applegate, a former early resident told them that it was the N.E. B.T. to said 1/4 corner and that he had seen the original scribing. This 1/4 corner position as remonumented by my survey is approx. 80 ft. to far South for the original creek call to the North, but the overall distance for the 1 1/2 miles N-S returned by my survey is in harmony with the record distance: therefore the Creek call was rejected. Moreover, the 1931 County Road Survey of Dead Indian Road and Cove Road tied to this B.O. stump. The Cove Road Survey of 1931 also tied the 1/4 corner to sections 34 and 35. Tying to these former County Road Survey's and calculating the B.T. position I find the present B.T. position confirmed, thus I accept it for the true position as remonumented by my survey. No original evidence was found of the 1/4 corner to section's 27 and 34, however, a E-W and N-S fence corner bears approx. West 40 ft. from my proportional position. From the data thus determined, sec. 27 was subdivided and corners set as shown. The existing centerline of Dead Indian Road was traversed and the area as shown was calc. from a line 30' Easterly and parallel to said centerline.

Survey Completed: 2/10/77

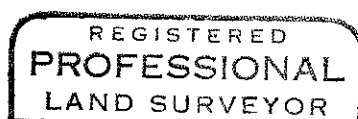

George R. Burrell

