

6628

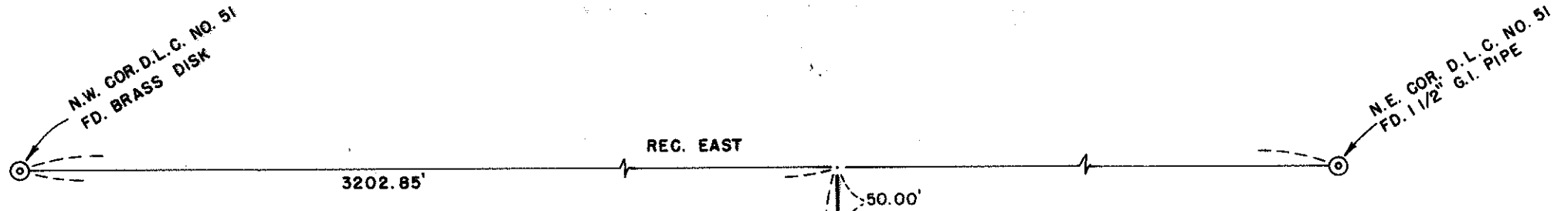

SET 5/8" IRON PIN  
WITNESS CORNER



MAP OF SURVEY  
 LOCATED IN  
 N.E. 1/4 OF SEC. 28, T. 36 S., R. 2 W., W.M.  
 JACKSON COUNTY, OREGON  
 FOR  
**JACK MEDINA**  
 J.A. HOFFBUHR, REG. L.S., MEDFORD, OREGON  
 SCALE: NONE                      DECEMBER 10, 1976  
 BASIS OF BEARING — RECORD

JACKSON COUNTY  
 RECEIVED  
 JAN 14 1977  
 SURVEYOR

REGISTERED  
 PROFESSIONAL  
 LAND SURVEYOR

*J.A. Hoffbuhr*

OREGON  
 NOV. 7, 1947  
 J.A. HOFFBUHR  
 222

6628

SURVEY NO. 6628

SURVEY NARRATIVE TO COMPLY WITH PARAGRAPH 209.250  
OREGON REVISED STATUTES

SURVEY FOR: Jack Medina  
7000 High Banks Road  
Central Point, Oregon 97502

LOCATION: Northeast one-quarter (1/4) of Section 28,  
Township 36 South, Range 2 West, Willamette  
Meridian, Jackson County, Oregon

PURPOSE: To locate a point 3202.85 feet East of the North-  
west corner of Donation Land Claim No. 51 as per  
client's request

PROCEDURE: Established the North line of Donation Land Claim  
No. 51 by use of E.D.M. equipment and theodolite. Set 5/8 inch  
iron pin witness corner 50.00 feet South of and at right angles to  
said North Donation Land Claim line as shown on the attached map.  
Basis of bearing--Record.

December 28, 1976

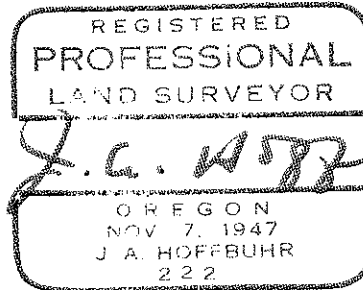
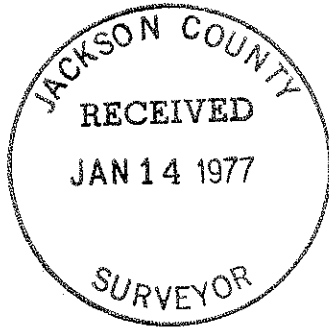

J. A. Hoffbuhr  
Professional Land Surveyor