

PROFESSIONAL LAND SURVEYOR

Charles H. Hurst

OREGON
OCTOBER 30, 1959
CHARLES H. HURST
483

SEP 30 1976

SURVEY NARRATIVE TO COMPLY WITH PARAGRAPH 209.250
OREGON REVISED STATUTES

Survey for: Estremado Brothers Logging
c/o Joe Estremado
2585 Galls Creek Road
Gold Hill, Oregon 97525

Survey by : Charles H. Hurst
304 South Holly
Medford, Oregon 97501

Bearing : Solar observation.

Purpose : To monument the corners of the NE $\frac{1}{4}$ NW $\frac{1}{4}$ and S $\frac{1}{2}$ NW $\frac{1}{4}$ of
Section 33, T. 37 S., R. 3 E., W.M.

PROCEDURE

Utilizing electronic distance measuring equipment, all corners shown were tied to a common base line either directly or by open traverse.

All angles measured were turned four times and closed through 360°.

The center 1/4 corner was set by open tie. The positions for the proportionate N 1/4 corner, W 1/16, NW 1/16 and N 1/16 corners were ascertained on the basis of a closed traverse.

Ultimately, the client will require the easterly and southerly boundaries to be marked at which time the center 1/4 and W 1/4 corners will be retied into a closed survey net.

The proportionate N 1/4 corner is located in a stand of pole timber. No evidence of the original corner set in 1882 could be found.

September 30, 1976

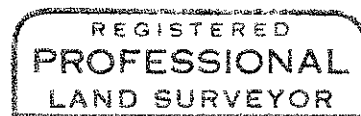
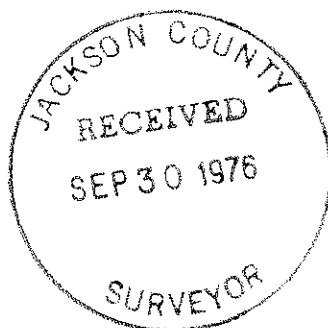

Charles H. Hurst

