

SURVEY SITUATE IN THE SE 1/4 SE 1/4  
OF SEC. 7, T. 37S., R. 1W., W. M.  
JACKSON COUNTY, OREGON

FOR  
PAULINE M. HILLYER

SCALE: 1" = 50'

REGISTERED  
PROFESSIONAL  
LAND SURVEYOR

*Charles H. Hurst*

OREGON  
OCTOBER 30, 1958  
CHARLES H. HURST  
483

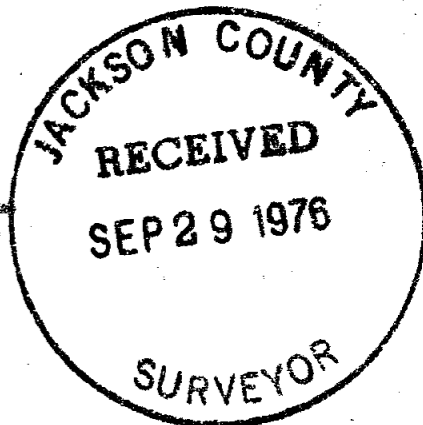

SEP 3 1976

SURVEY BY:  
CHARLES H. HURST  
MEDFORD, OREGON

LEGEND

- Set 5/8" x 24" Iron Pins
- ⊙ Fd. 5/8" Pins per Survey No. 2709
- Fd. 5/8" Pins per Survey No. 5134

NOTE:  
TIE TO SEC. COR. IS  
THAT SHOWN BY SURVEY  
NO. 2709.

DELTA WATERS ROAD

7 | 8  
18 | 17

**SURVEY NARRATIVE TO COMPLY WITH PARAGRAPH 209.250**

**OREGON REVISED STATUTES**

**Survey for:** Pauline M. Hillyer  
 c/o First National Bank of Oregon  
 Medford Main Branch  
 Medford, Oregon 97501

**Survey by :** Charles H. Hurst  
 304 South Holly  
 Medford, Oregon 97501

**Bearing :** Based on the meridian of Survey No. 1039

**Purpose :** To monument the southerly boundary of Tract A  
 of Volume 469, page 207 of Deed Records, Jackson  
 County, Oregon.

**PROCEDURE**

Survey control was established from the nearest monuments found per Survey Nos. 2709 and 5135.

The monument set on the spiral offset may be subject to slight adjustment depending on the accuracy of the right-of-way pins which were not indorsed by this survey.

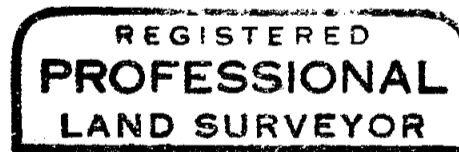
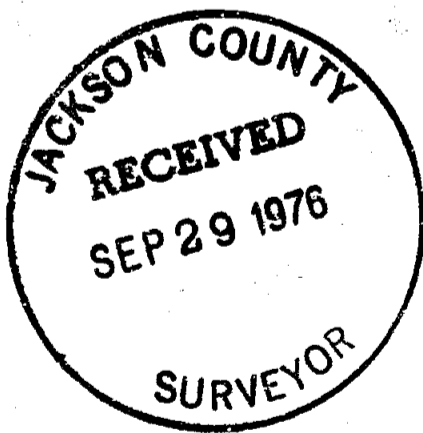

*Charles H. Hurst*

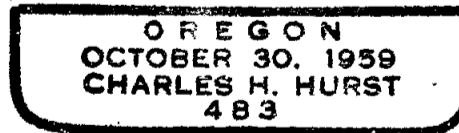

**SEP 3 1976**