

DEPARTMENT OF PUBLIC WORKS
LOCATED LINE

EAST EVANS CREEK ROAD

CITY LIMITS ROGUE RIVER - EARHART ROAD T.35S.

JACKSON COUNTY
OCTOBER 1973
SCALE 1" = 50'

- Indicates set 5/8" x 30" iron pin & guard post. All pins are at right angles to centerline and set flush, unless otherwise noted.
 - Indicates existing iron pin. All found pins are 5/8" diameter, unless otherwise noted.
- Basis of bearing: Interstate 5 - south zone
- Purpose of survey: To define the boundaries of the road right of way owned by Jackson County.
- Procedure: Right of way acquired by deed and petition.
- Survey completed October 1973

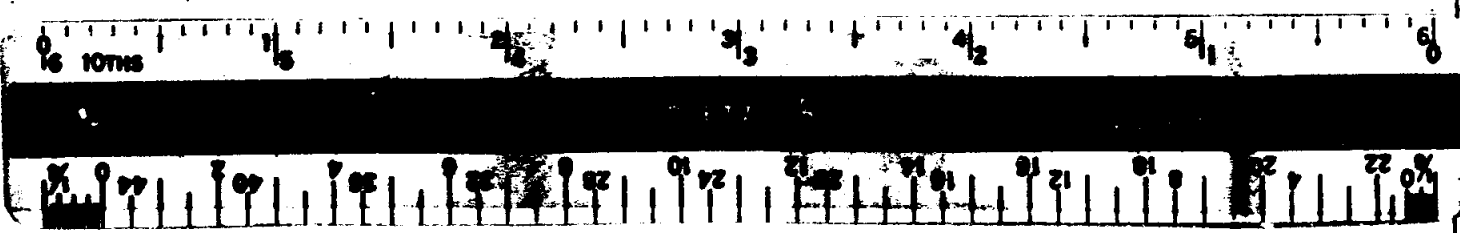
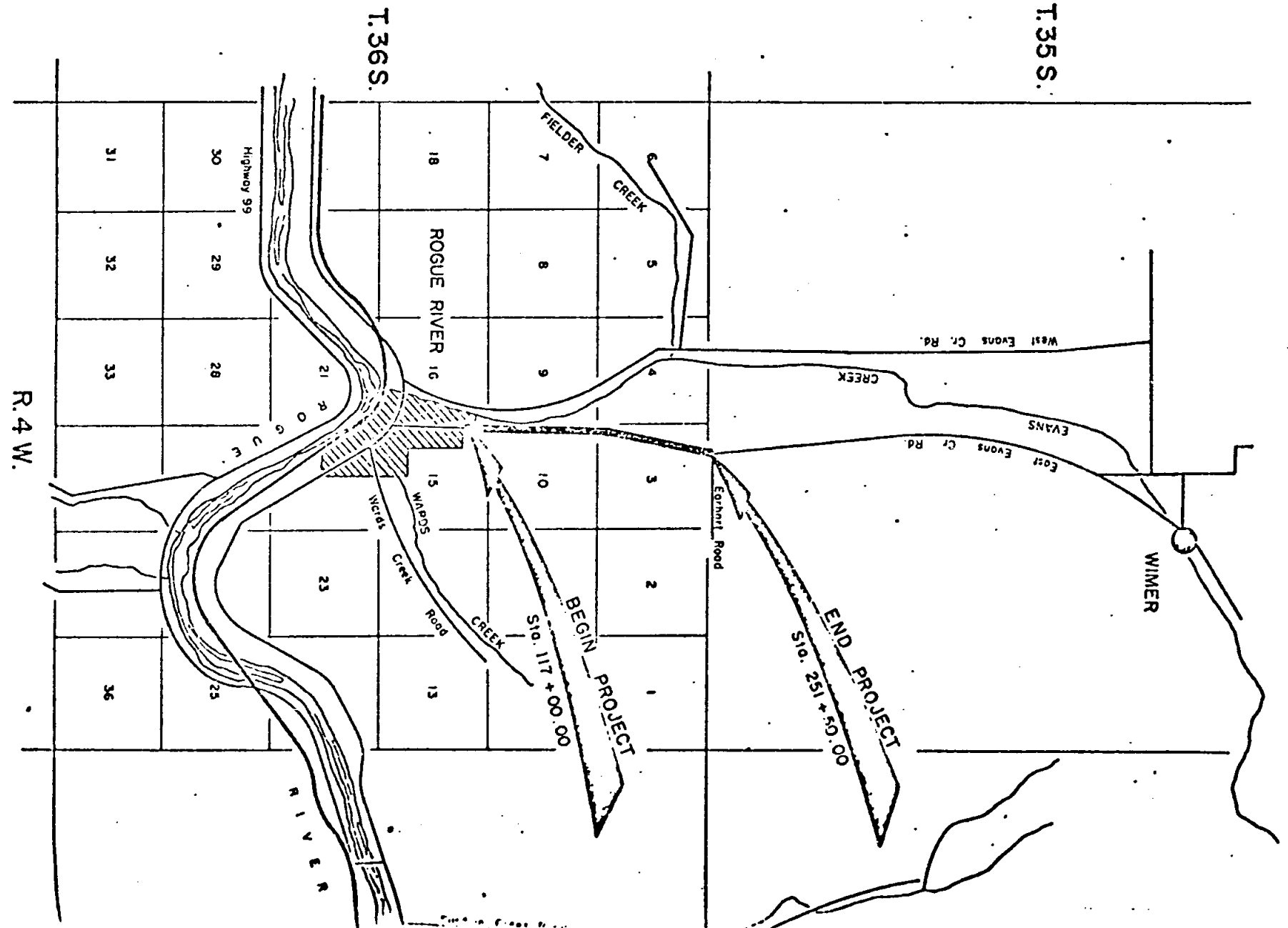
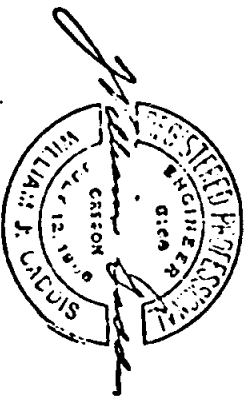

53/S10 T36 R4W

6379

DEPARTMENT OF PUBLIC WORKS

LOCATED LINE

EAST EVANS CREEK ROAD

CITY LIMITS ROGUE RIVER - EARHART ROAD T.35 S.

JACKSON COUNTY

OCTOBER 1973

SCALE 1" = 50'

⊙ Indicates set 5/8" x 30" iron pin & guard post. All pins are at right angles to centerline and set flush, unless otherwise noted.

⊙ Indicates existing iron pin. All found pins are 5/8" diameter, unless otherwise noted.

Basis of bearing: Interstate 5 - south zone

Purpose of survey: To define the boundaries of the road right of way owned by Jackson County.

Procedure: Right of way acquired by deed and petition.

Survey completed October 1973

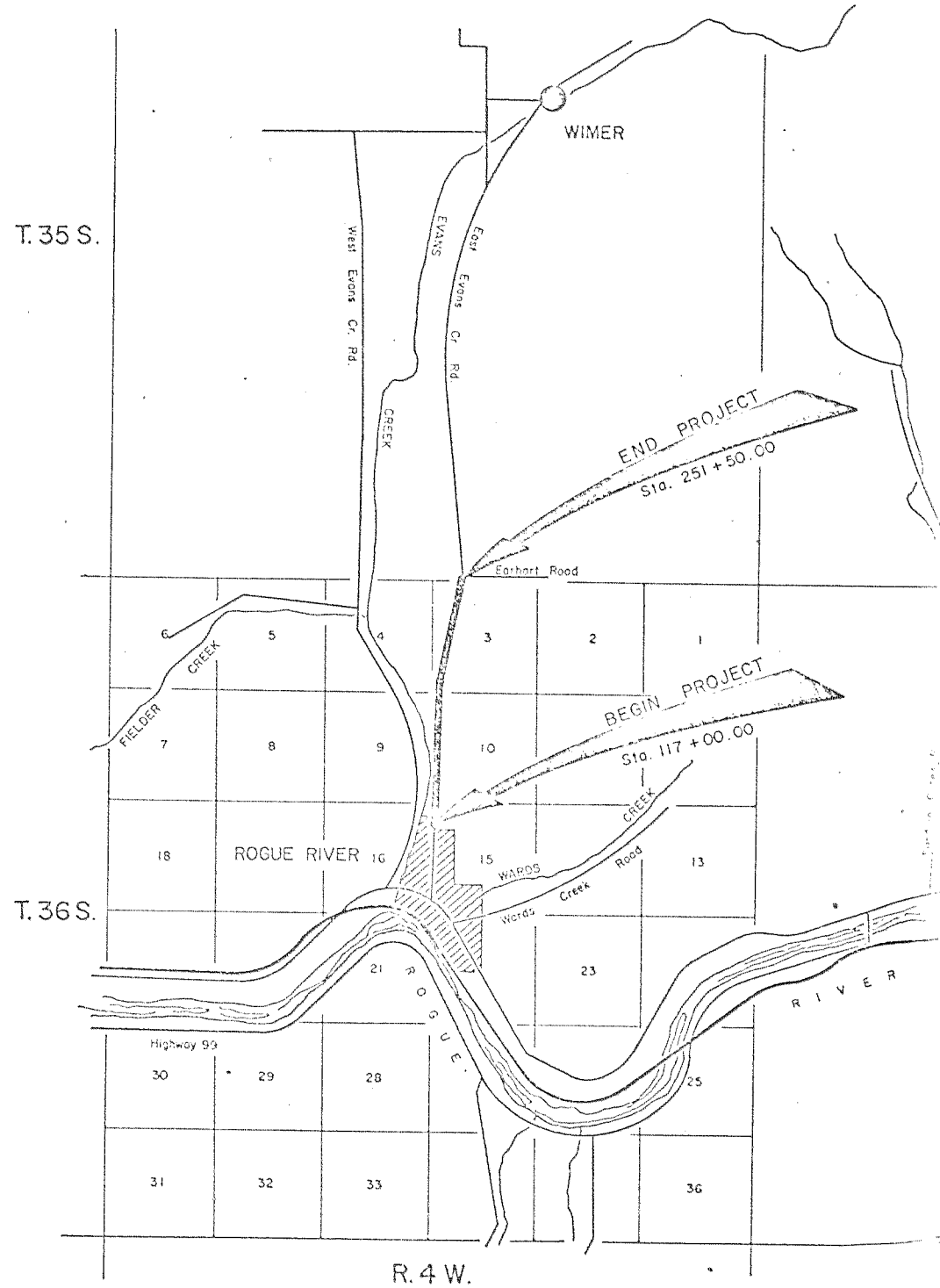
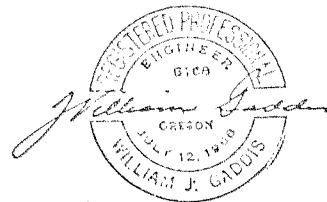

6379