

155

FD. 5/8" # FLUSH W/A.C.

FD. 5/8" # FLUSH W/A.C.

N 89° 44' 45" W 1290.78' (REC. N 89° 44' 35" W 1290.76')

S 89° 51' 15" E NORTH LINE OF LOT NO. 36

FD 5/8" # N.W. COR. LOT NO. 36

R/S NO. 4296

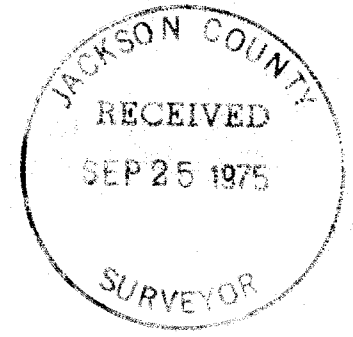

MAP OF SURVEY

LOCATED IN

FAIRVIEW SOUTH CHILDERS EASTERN ADDN.

SECTION 20, T. 37 S., R. 1 W., W.M.

JACKSON COUNTY, OREGON

FOR

ORIE MOORE & HAYES H. ROSSMAN

J. A. HOFFBUHR, REG. L.S., MEDFORD, OREGON

SCALE: 1" = 100'

NOV. 15, 1974

BASIS OF BEARING-

R/S NO. 4296

o = SET 5/8" X 24" IRON REINFORCING PIN (Ø)

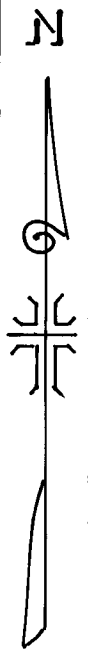

500° 15' 10" E REC. 1247.43 MEAS. 1247.33

BERKELEY WAY

FD. 1 1/2" IRON PIPE N 2.96' W 3.62' of record midpoint

622.38' 7.00'

N 00° 14' 35" W (REC. N 00° 13' 35" W) 155.59'

S 89° 54' 37" E NORTH LINE OF THE SOUTH 1/2 OF LOT NO. 36

307.30'

FD. 1/2" IRON PIPE N 1.58' W 8.17'

155.44' S 00° 14' 35" E

FD. 3/4" IRON PIPE N 1.87' W 5.27'

S 89° 56' 19" E

307.30'

S 89° 56' 19" E

N 00° 14' 35" W (REC. N 00° 13' 35" W) 155.60'

306.91'

N 00° 14' 00" W 155.44'

154.24'

141.63'

S.W. COR. LOT NO. 36

N 89° 58' 00" W

141.63'

N 00° 14' 00" W 77.88'

N 00° 14' 00" W 77.72'

77.65'

N 89° 58' 00" W (REC. 1320.28) MEAS. 1320.32

286.88'

121.63'

135.57'

S.E. COR. COLLEGE HILL ADDITION (1911) FD. 3/4" IRON PIPE 6" EXPOSED

BARNES AVE.

BLK. # 12

N.E. COR. EASTWOOD SUBD. FD 1" IRON PIPE

R/S NO. 5711

EASTWOOD SUBD.

BLK. # 11

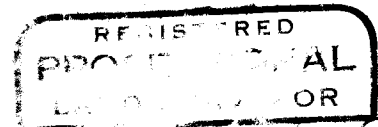

J. A. Hoffburr

NOV. 15, 1974

J. A. HOFFBUHR

6155

6155

SURVEY NO. 6155

SURVEY NARRATIVE TO COMPLY WITH PARAGRAPH 209.250
OREGON REVISED STATUTES

SURVEY FOR: Orië Moore
535 Barnes
Medford, Oregon 97501

Hayes H. Rossman
547 Barnes
Medford, Oregon 97501

LOCATION: Fairview South Childers Eastern Addition, Section
20, Township 37 South, Range 1 West, Willamette
Meridian, Jackson County, Oregon

PURPOSE: To survey, monument, and describe the tracts as
shown on the attached map as per client's request

PROCEDURE: Using monuments and boundary lines established by
Recorded Survey No. 4296 and 5711, set pins as shown on map. Pro-
portioned bearings and distances were established by found monuments
in Lot No. 36 of Fairview South Childers Eastern Addition. A 10.00
foot strip of land was established on the West side of Sunrise Avenue
as per City of Medford's request. Basis of bearings--Recorded
Survey No. 4296.

August 29, 1975

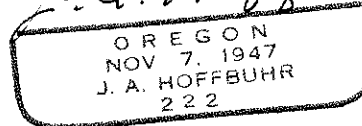
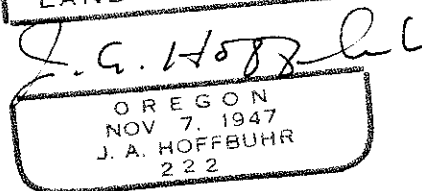
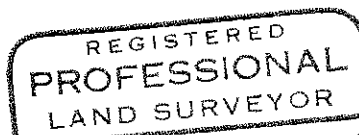
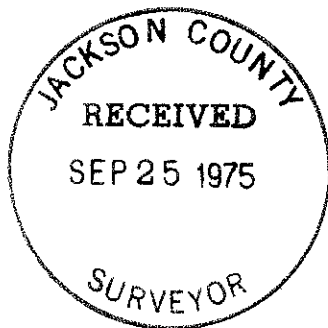

J. A. Hoffbuhr
Professional Land Surveyor