

8092

Rec. N89°58'40"W

Craiglea Drive

N89°56'29"W
263.32'
Rec 26325' Q.10'

S.N. 2188

SN. 2188

57

58

59

60

Rec = 50°06'17"E 1262.37
50°06'10"E 1263.26

1261.89

Rec = N 0°09'36"W 1261.27 = N 0°09'28"W 1261.99

Rec 264.48'
264.53'

S 89°46'53"W



JACKSON COUNTY
RECEIVED
AUG 11 1975
SURVEYOR

DEPENDANT SURVEY

IN NW. 1/4 - NE.1/4 SEC. 6, T.37 S., R.1 E., WM.
75 - 9

FOR DWIGHT THIEROFF

BY EDWARD A. MC GINTY
MEDFORD, OREGON
JUNE 1975

SCALE 1" = 200'
FD 5/8" I.PIN

REGISTERED
PROFESSIONAL
LAND SURVEYOR

Edward A. McGinty

OREGON
JULY 20, 1975
EDWARD A. M.
8092

6092

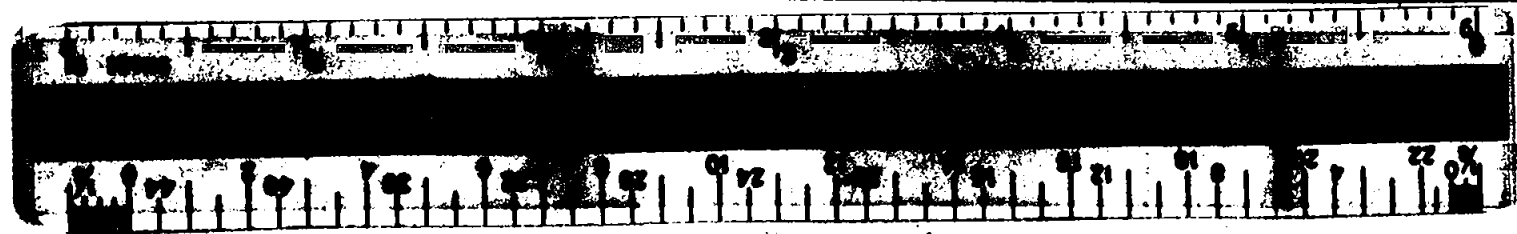

SURVEY NO. **6092**

SURVEY NARRATIVE TO COMPLY WITH O.R.S. 209-250

SURVEY FOR: Dwight Thierolf 75-9
4477 E. Antelope
Eagle Point, OR

SURVEY BY: Edward A. McGinty, R.S.
Medford, Oregon
June 1975

LOCATION: NW 1/4 of NE 1/4 of Sec. 6, T37S, R1E, W.M.

BASIS OF BEARING: Survey No. 2188
Southerly line of Tract #59

PRECEDENCE OF SURVEY:

This is a retracement of a portion of a previous survey, Survey No. 2188, showing remeasurement from monuments found. Previous survey on the North-South line was computed from traverse datum. Note: found monuments may shift as indications found small drive next to iron pin.

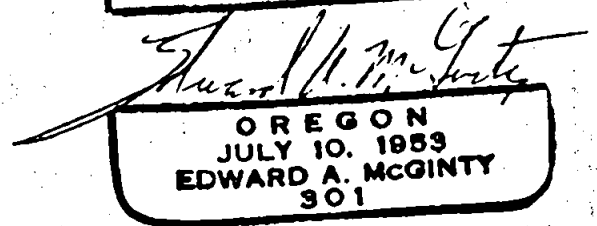
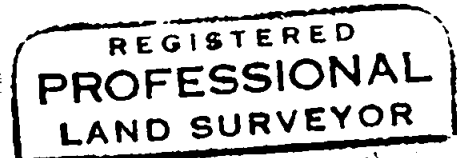
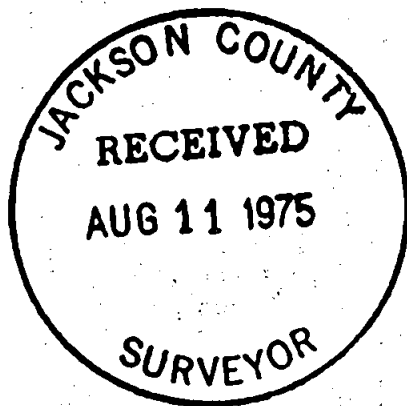

S6 T37 R1E

SURVEY NO. 6092

SURVEY NARRATIVE TO COMPLY WITH O.R.S. 209-250

SURVEY FOR: Dwight Thierolf 75-9
4477 E. Antelope
Eagle Point, OR

SURVEY BY: Edward A. McGinty, R.S.
Medford, Oregon
June 1975

LOCATION: NW 1/4 of NE 1/4 of Sec. 6, T37S, R1E, W.M.

BASIS OF BEARING: Survey No. 2188
Southerly line of Tract #59

PRECEDENCE OF SURVEY:

This is a retracement of a portion of a previous survey, Survey No. 2188, showing remeasurement from monuments found. Previous survey on the North-South line was computed from traverse datum. Note: found monuments may shift as indications found small drive next to iron pin.

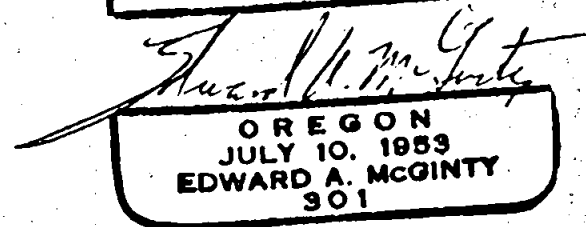
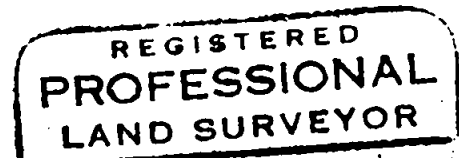
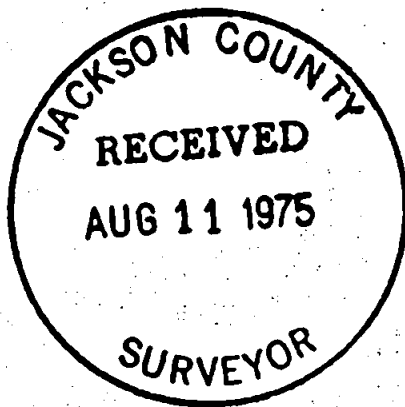

S6 T37 R1E