

MAP OF SURVEY
 LOCATED IN
 NW. 1/4 SEC. 16, T. 37 S., R. 2 W. W. M.
 JACKSON COUNTY OREGON
 FOR
 MANVILLE HEISEL

J. A. HOFFBUHR, REG. L.S., MEDFORD, OREGON
 SCALE: 1" = 50' NOV. 1970
 BASIS OF BEARING R/S 1430
 ° SET 5/8" X 24" IRON REINFORCING PIN

REGISTERED
OREGON
 LAND SURVEYOR
J. A. Hoffbuhr
 NOVEMBER 7 1947
 J. A. HOFFBUHR

17
 846.41'
 NORTH
 16
 1/4 SEC. COR.
 FD. GRANITE STONE
 WITH "X" IN TOP

SURVEY NARRATIVE TO COMPLY WITH PARAGRAPH 209.250
OREGON REVISED STATUTES

SURVEY FOR: Manville Heisel
Medical Center Bldg.
Medford, Oregon

LOCATION: Tract situated in the Northwest One Quarter (1/4)
of Section 16, Township 37 South, Range 2 West,
Willamette Meridian, Jackson County, Oregon.

PURPOSE: To survey and describe a tract, the boundaries
being determined by the client to correctly
describe a parcel to include a residence that
has been constructed within a dedicated road
(Westover Blvd.). The problem dates back to
the recording of the recorded plat of Westover
Heights Subdivision. Surveyor Powell submitted
the original plat for recording showing distances
acquired by field measurements, but the title
company refused to approve the plat unless the
plat was revised to correspond with the record.
He revised the plat as directed and the present
plat of record does not correspond with the
property lines located in the field.

The tract was monumented as shown, and the portion
of Westover Blvd. was vacated as shown.

Basis of Bearings--Recorded Survey No. 430.

January 24, 1975

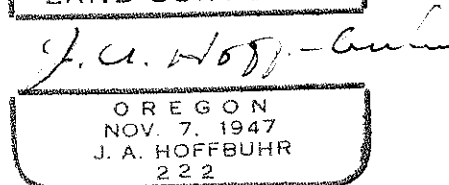
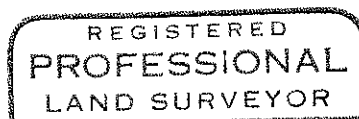
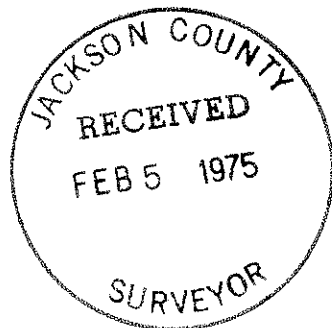

J. A. Hoffbuhr
Professional Land Surveyor