

20' ROAD EASEMENT COURSES

- ① S 24° 34' 00" E 77.79'
- ② S 00° 58' 41" W 274.12'
- ③ N 46° 04' 36" E 110.26'
- ④ N 30° 28' 51" E 64.75'
- ⑤ N 09° 11' 40" E 53.78'
- ⑥ N 85° 47' 22" E 21.89'
- ⑦ S 33° 16' 38" E 41.06'
- ⑧ S 19° 05' 33" E 205.09'
- ⑨ N 89° 24' 20" E 187.38'

JACKSON COUNTY
RECEIVED
JUL 24 1974
SURVEYOR

REGISTERED
PROFESSIONAL
LAND SURVEYOR
J. A. Hoffbuhr
OREGON
NOV 27 1947
J. A. HOFFBUHR
222

MAP OF SURVEY
LOCATED IN
N. E. 1/4 OF SECTION 8, T. 37 S., R. 2 W., W.M.
JACKSON COUNTY, OREGON
FOR
MRS. CURTIS HOPKINS
J. A. HOFFBUHR, REG. L.S., MEDFORD, OREGON
SCALE: 1"=100' JUNE 19, 1973
BASIS OF BEARING R/S NO. 3266
○=SET 5/8" X 24" IRON REINFORCING PIN
●= FOUND 5/8" IRON PIN

SURVEY NARRATIVE TO COMPLY WITH PARAGRAPH 209.250
OREGON REVISED STATUTES

SURVEY FOR: Mrs. Curtis Hopkins
3775 Roads End
Central Point, Oregon

LOCATION: Northeast One Quarter (1/4) of Section 8, Township
37 South, Range 2 West, Willamette Meridian, Jackson
County, Oregon.

PURPOSE: To locate, monument, and describe the property
corners of the tract as shown on the map accompany-
ing this narrative.

PROCEDURE: Utilized control between the section corner common
to Sections 4, 5, 8, 9, and the One Quarter (1/4) corner common to
Sections 5 and 8, Township 37 South, Range 2 West, Willamette Meridian,
Jackson County, Oregon. Located property corners set as per Recorded
Survey No. 3266 and Recorded Survey No. 4280, and set additional property
corners as shown on the map.

Basis of Bearings--Recorded Survey No. 3266.

July 23, 1974

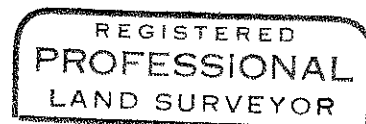
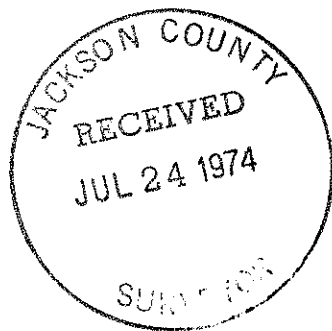

J. A. Hoffbuhr

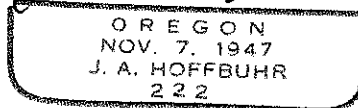

J. A. Hoffbuhr
Professional Land Surveyor