

5625

SURVEY FOR G & W CONTRACTORS

N.E. 1/4 SEC. 19, T. 37S., R. 1W., W.M.
JACKSON COUNTY, OREGON

March 29, 1974

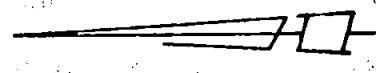
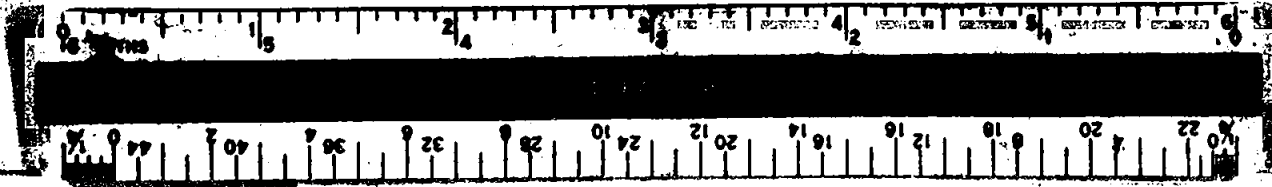

SCALE 1" = 100'

LEGEND

- Monument Found
- 5/8"x24" Iron Pin Set

BASIS OF BEARING:
SURVEY NO. 53183

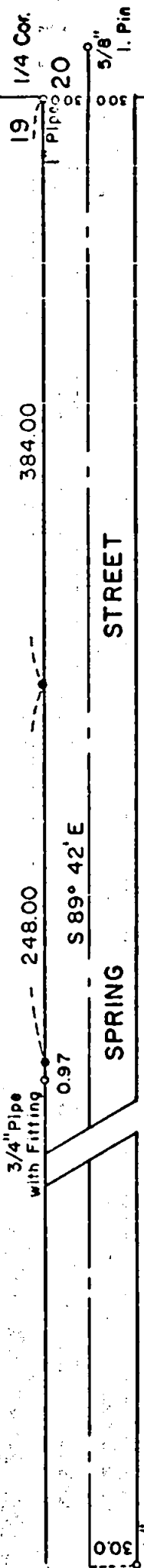
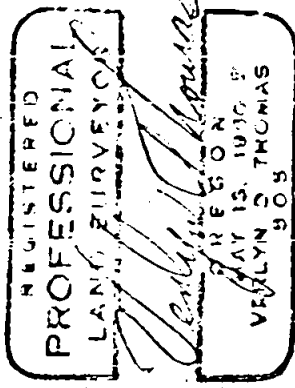
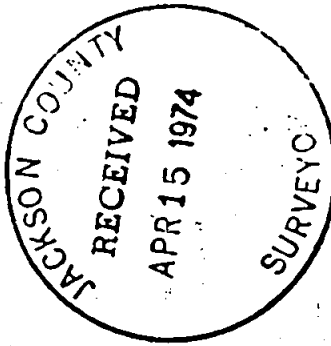

SURVEY # 5383

SURVEY BY VERLYN THOMAS, PROFESSIONAL LAND SURVEYOR, MEDFORD, OREGON

5625

SURVEY NARRATIVE TO COMPLY WITH O.R.S. 209.250
REVISED BY CHAPTER 555, O.L. 1963

FOR: G. & W. Contractors
4158 Anderson Creek Road
Talent, Oregon

PURPOSE: To establish front corners of parcel according to
existing legal description.

PROCEDURE: Determined location of front corners, relative to quarter
corner between Sections 19 and 20 by examining old legal descriptions
to establish original intent. Centerline of Spring Street determined
from control previously established in performing Recorded Survey
No. 5383. Set two $\frac{5}{8}$ " iron pins as shown on accompanying plat.

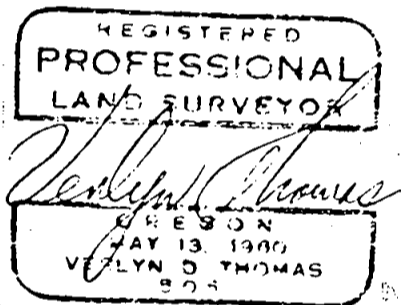
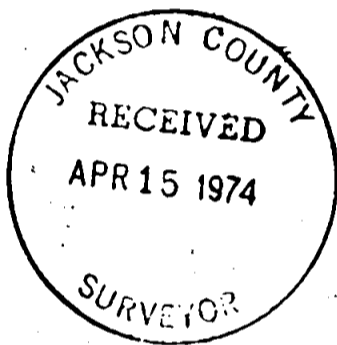

519 T378 RIW