

5557 E.N.E. CORNER D.L.C. NO. 42
FOUND BRASS DISK IN MONUMENT WELL

SURVEY NO. 3467

SURVEY NO. 4780

SALING STREET

N 89° 59' 35" E 559.69' (RECORD EAST)

FOUND 5/8" IRON PIN

FOUND 5/8" IRON PIN

CRATER LAKE AVENUE

659.56' N 00° 05' 10" E

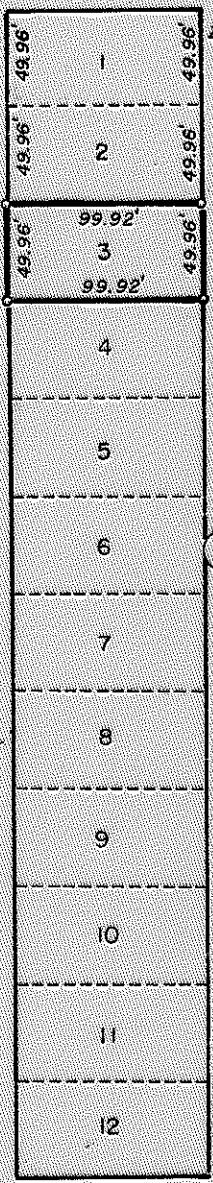

LAURELHURST STREET
MARY STREET

ADDITION

SURVEY NO. 2685

MAE STREET

659.65' S 00° 05' 20" W

MARIE STREET

EFFIE STREET

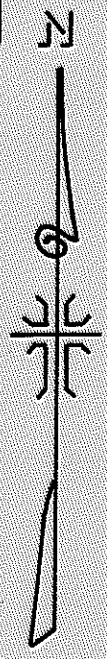

FOUND BRASS DISK IN MONUMENT WELL

N 89° 59' 50" W 559.68' (RECORD 559.73')

EAST JACKSON STREET

FOUND 5/8" IRON PIN

MAP OF SURVEY
LOCATED IN
BLOCK 8 LAURELHURST ADDITION
S.E. 1/4 OF SECTION 19, T. 37 S., R. 1 W., W.M.
JACKSON COUNTY OREGON

FOR
GEORGE YOUNG

J. A. HOFFBUHR, REG. L.S., MEDFORD, OREGON
SCALE: 1"=100' MAY 25 1973
BASIS OF BEARING R/S NO. 2685
o-SET 5/8" X 24" IRON REINFORCING PIN

REGISTERED
PROFESSIONAL
LAND SURVEYOR

J. A. Hoffbuhr

OREGON
NOV. 7, 1947
J. A. HOFFBUHR
282

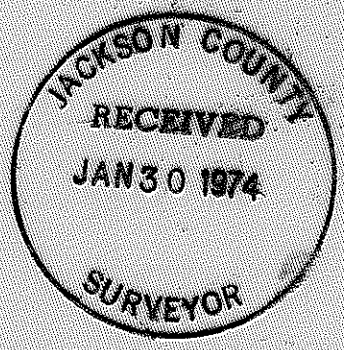

5557
5557

SURVEY NARRATIVE TO COMPLY WITH PARAGRAPH 209.250
OREGON REVISED STATUTES

SURVEY FOR: Mr. George Young
Cascade Dental Lab.
P. O. Box 1210
Redding, California 96001

LOCATION: Tract situated in Block 8, Laurelhurst Addition to
the City of Medford, Jackson County, Oregon.

PURPOSE: Locate, describe, and monument the property corners
of the tract as shown on the map accompanying this
narrative.

PROCEDURE: Located property corners and Donation Land Claim
corners as per Recorded Survey Nos. 3467, 4780, 2685, and set addi-
tional property corners as shown on the accompanying map.
Basis of Bearings--Recorded Survey No. 2685.

January 22, 1974

J. A. Hoffbuhr
Professional Land Surveyor

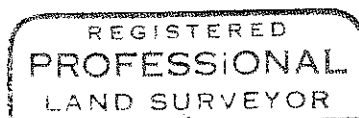
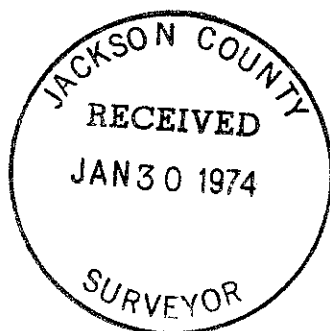

J. A. Hoffbuhr

