

SURVEY NARRATIVE TO COMPLY WITH PARAGRAPH 209.250
OREGON REVISED STATUTES

SURVEY FOR: Rogue River Paving Co., Inc.
1133 S. Riverside
Medford, Oregon

LOCATION: Tract situated in the Southwest One Quarter (1/4)
of Section 5, Township 37 South, Range 1 West,
Willamette Meridian, Jackson County, Oregon.

PURPOSE: To locate, describe, and monument the property corners
of the tract as shown on the map accompanying this
narrative.

PROCEDURE: Located the One Quarter (1/4) corner common to Sections
5 and 6, and the section corner common to Sections 5, 6, 7, and 8, and
established the centerline of Crater Lake Ave. Located property corners
set as per Recorded Survey No. 2806, and set additional property corners
as shown on the attached map.

Basis of Bearings--Recorded Survey No. 832.

January 25, 1974

J. A. Hoffbuhr
Professional Land Surveyor

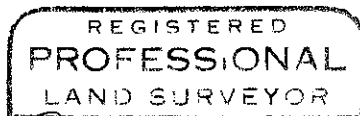
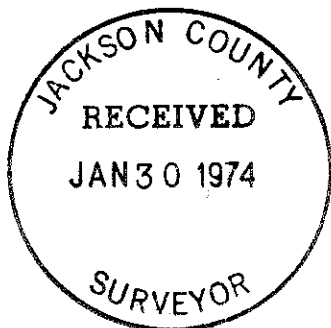

J. A. Hoffbuhr

