

MAP OF SURVEY

LOCATED IN
E 1/2 OF SEC. 29, TWR 40S, R. 2 E.W.M.
JACKSON COUNTY OREGON
FOR

ROBERT HARDY & RICHARD COTTLE

EVERETT L. SWAIN, R.L.S. ASHLAND, OREGON

SCALE: 1" = 400' NOVEMBER 30, 1973
BASIS OF BEARING: RECORDED SURVEY No. 4250

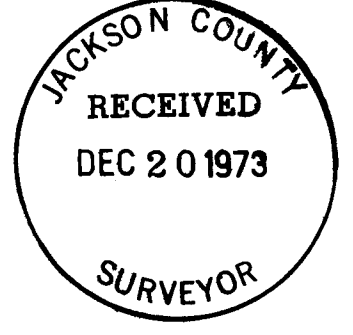

- FOUND MONUMENTS AS SHOWN
- SET 5/8 x 24 INCH IRON PIN TAGGED R.L.S. 759
- ⊙ SET MONUMENTS AS SHOWN





SURVEY NO. 5496

Page 7
Robert Hardy and Richard Cottle

from which

A Cedar, 13 inches dia., brs. S. 47°49' E., 29.0 feet dist., scribed NE 1/16 BT.

A White Fir, 8 inches diam., brs. S. 87°48' W., 75.7 feet dist., scribed NE 1/16 BT.

CENTER-EAST 1/16 SECTION CORNER, Section 29, Township 40 South, Range 2 East.

At the corner point set a 32 inch by 1 inch diam. galvanized iron pipe, 32 inches in the ground with 2½ inch diam. bronze cap mkd.

Survey Monument
T40S R2E

E 1/16 C-----C Cor
RLS 759 1973

This corner falls in the backslope of Interstate Highway No. 5. No trees near.

SOUTHEAST 1/16 SECTION CORNER, Section 29, Township 40 South, Range 2 East.

At the corner point set a 30 inch by 1 inch diam. galvanized iron pipe, 29 inches in the ground with 2½ inch diam. bronze cap mkd.

Survey Monument
T40S R2E

SE | Cor
1/16 |

RLS 759 1973

from which

A Red Fir, 13 inches diam., brs. N. 36°36' W., 46.2 feet dist., scribed SE 1/16 BT.

A White Fir, 13 inches diam., brs. S. 59°10' W., 62.1 feet dist., scribed SE 1/16 BT.

CENTER 1/4 SECTION CORNER, Section 29, Township 40 South, Range 2 East.

At the corner point set a 30 inch by 1 inch diam. galvanized iron pipe, 22 inches in the ground with 2½ inch diam. bronze cap mkd.

Survey Monument
T40S R2E

C 1/4 | Cor
S29 |

RLS 759 1973

raised mound stone around pipe
from which

A White Fir, 15 inches diam., brs. N. 30°47' W., 4.8 feet dist., scribed C 1/4 S29 BT.

A Cedar, 13 inches diam., brs. N. 81°31' E., 41.8 feet dist., scribed C 1/4 S29 BT.

November 30, 1973

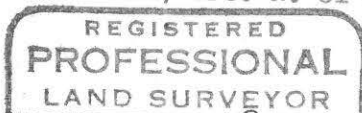

Everett L. Swain

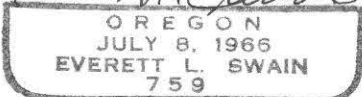

Everett L. Swain
Professional Land Surveyor
Ashland, Oregon

Page 6
Robert Hardy and Richard Cottle

from which

A White Oak, 11 inches diam., brs. N. 23°24' E., 146.5 feet dist., scribed 1/4 S29 BT.

A Juniper, 12 inches diam., brs. N. 08°50' W., 111.7 feet dist., scribed 1/4 S29 BT.

There are no trees South of section line within a reasonable distance.

This corner falls in the North edge of an Interstate Highway No. 5 fill slope.

WEST 1/16 SECTION CORNER common to Sections 20 and 29, Township 40 South, Range 2 East.

At the corner point set a 9 inch by 3/4 inch diam. iron pin, 7 inches into bedrock with 2 1/2 inch diam. bronze cap mkd.

Survey Monument
T40S R2E
1/16 — $\frac{S20}{S29}$ — Cor
RLS 759 1973

from which

A Juniper, 13 inches diam., brs. S. 27°11' E., 68.3 feet dist., scribed 1/16 S29 BT.

A Red Fir, 29 inches diam., brs. N. 63°57' E., 67.5 feet dist., scribed 1/16 S20 BT.

A wire fence, C S78°W-N78°E, brs. S27 1/4°E 22.3 feet dist.

CENTER-NORTH 1/16 SECTION CORNER, Section 29, Township 40 South, Range 2 East.

At the corner point set a 36 inch by 1 inch diam. galvanized iron pipe, 31 inches in the ground with 2 1/2 inch diam. bronze cap mkd.

T40S R2E
C
N1/16 — | — S29
C
RLS 759 1972

from which

A Pine, 19 inches diam., brs. S. 64°02' W., 8.5 feet dist., scribed CN 1/16 BT.

A Fir, 14 inches diam. brs. S. 84°40' E., 52.7 feet dist., scribed CN 1/16 BT.

NORTHEAST 1/16 SECTION CORNER, Section 29, Township 40 South, Range 2 East.

At the corner point set a 36 inch by 1 inch diam. galvanized iron pipe, 33 inches in the ground with 2 1/2 inch diam. bronze cap mkd.

T40S R2E
NE
1/16 — S29
RLS 759 1972

Page 5
Robert Hardy and Richard Cottle

Survey Monument			
T40S			
Sec	S31	S32	R2E
Cor	S6	S5	
T41S			

RLS 759 1973

and raise mound stone around pipe
from which

A Black Oak, 27 inches diam., brs. N. 20°00' E., 17.2 feet to chaining notch, scribing visible, OBT (Gov't. Rec. N. 20° E., 17.2 feet).

A Y. Pine, 15 inches diam., brs. N. 51°40' E., 44.9 feet dist., scribed T40S R2E S32 BT.

A Black Oak, 7 inches diam., brs. S. 44°08' E., 39.3 feet dist., scribed T41S R2E S5 BT.

A Y. Pine, 16 inches diam., brs. S. 82°00' W., 49.6 feet dist., scribed T.41S R2E S6 BT.

A Sugar Pine, 17 inches diam., brs. N. 41°16' W., 55.1 feet dist., scribed T40S R2E S31 BT.

A North-South fence brs. East 5.7 feet.

SECTION CORNER common to Sections 29, 30, 31 and 32, Township 40 South, Range 2 East.

At a proportional location, set a 24 inch by 2 inch diam. iron pipe, 18 inches in the ground with a 3inch diam. bronze cap mkd.

Survey Monument			
T40S		R2E	
Sec	S30	S29	Cor
	S31	S32	
RLS 759 1973			

from which

A White Oak, 6 inches diam., brs. N. 83°47' W., 7.8 feet dist., scribed T40S R2E S30 BT.

A White Oak, 4 inches diam., brs. S. 06°57' W., 19.3 feet dist., scribed S31 BT

A White Oak, 4 inches diam., brs. S.50°22' E., 15.0 feet, scribed S32 BT.

No other suitable trees near.

The SW BT has been blazed previously, blazes healed, on the South and West face.

1/4 CORNER common to Sections 29 and 32, Township 40 South, Range 2 East.

At a proportional location, set a 24 inch by 1 inch diam. iron pipe, 23 inches in the ground with a 2½ inch diam. bronze cap mkd.

Survey Monument			
T40S		R2E	
1/4	S29	Cor	
	S32		
RLS 759 1973			

Page 4
Robert Hardy and Richard Cottle

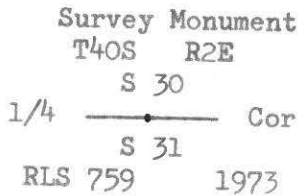

from which

A Black Oak, 43 inches diam., brs. N. 39°30' E., 107.75 feet dist. (Gov't. Rec. N. 40° E., 107.6 feet) opened tree and found evidence that tree had been opened at least three times before. Axe work quite evident. No scribing visible. OBT Dist. to face of blaze.

A White Oak, 22 inches diam., brs. S.69°48' E., 134.17 feet dist. (Gov't. Rec. S. 70° E., 133.3 feet) opened tree and found scribing. OBT Dist. to chaining notch.

A White Oak, 7 inches diam., brs. S.80°48' E., 40.9 feet dist., scribed 1/4 S31 BT.

A White Oak, 6 inches diam., brs. N. 52°19' E., 33.8 feet dist., scribed 1/4 S30 BT.

Found a 1 inch diam., iron pipe which brs. S. 60°12' E., 1.9 feet dist. Origin unknown.

1/4 CORNER common to Sections 31 and 32, Township 40 South, Range 2 East.

At the corner point set a 30 inch by 2 inch diam. iron pipe, 24 inches in the ground, with 3 inch diam. bronze cap mkd.

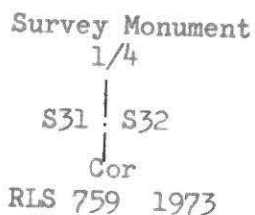

from which

A Y. Pine Stump badly burned, 36 inches diam. m.o.l., brs. N. 35°54' E., 50.8 feet dist. (Gov't. Rec. N. 40° E., 49.8 feet) Dist. to center.

A Y. Pine stump hole, with some remains, approx. 42 inches across, brs. S. 51°23' W., 65.3 feet dist., (Gov't. Rec. S. 55° W., 66.2 feet) Dist to center.

A Y. Pine, 21 inches diam., brs. S.78°35' E., 10.9 feet dist., scribed 1/4 S32 BT. Old fence wire approx. 5 inches deep in this tree. Fence brs. Easterly.

A Black Oak, 9 inches diam., brs. N. 31°05' W., 36.9 feet dist., scribed 1/4 S31 BT.

A North-South fence brs. West 7.6 feet dist.

Evidence of down fence bearing Easterly from corner.

SECTION CORNER common to Sections 31 and 32, Township 40 South, and Sections 5 and 6, Township 41 South, Range 2 East.

At the corner point set a 24 inch by 2 inch diam. galvanized iron pipe, 15 inches in the ground with 3 inch diam. bronze cap mkd.

Page 3
Robert Hardy and Richard Cottle

1/4 CORNER common to Sections 29 and 30, Township 40 South, Range 2 East.

No corner monument found.

A Y. Pine Stump, in a high state of deterioration was found and opened. The "BT & Chaining Notch" were found in relief. This stump was approx. 15-18 inches when scribed.

From this original bearing tree, set a 22 inch by 1 inch diam. iron pipe, 22 inches in the ground with a 2½ inch diam. bronze cap mkd.

Swain Surveying
T40S R2E
1/4 S30 | S29 Cor
Survey 1972 Monument

from which

A Y. Pine Stump, 22-28 inches diam., brs. N. 70°00' E., 158.4 feet (Gov't. Rec. N. 70° E., 158.4 feet) dist., scribing visible. Dist. to chaining notch. OBT

A Y. Pine, 18 inches diam., brs. S. 78°14' E., 19.5 feet dist., scribed 1/4 S29 BT.

A Y. Pine, 17 inches diam., brs. N. 27°13' W., 32.3 feet dist., scribed 1/4 S30 BT.

1/4 CORNER common to Sections 28 and 29, Township 40 South, Range 2 East. See Recorded Survey No. 1617.

At the corner point found a 1¼" diam. galvanized iron pipe, tagged RS 404, in the approx. center of a creek bed. Said pipe is exposed 14 inches, m.o.l.

from which

A Fir Stump, 28 inches diam., brs. S. 55°28' W., 23.25 feet dist. (Gov't. Rec. S. 56° W., 23.8 feet) scribing visible. Dist. to face of blaze. OBT

A Fir, 25 inches diam., brs. N. 19°09' W., 43.0 feet dist., with blazes healed. Dist. to center of tree.

A Red Fir Stump, 44 inches diam., brs. S. 07°42' E., 34.5 feet dist., scribing visible. Dist. to face of blaze.

SECTION CORNER common to Sections 28, 29, 32 and 33, Township 40 South, Range 2 East.

At the corner point found a 1½ inch diam. galvanized iron pipe, exposed 4" m.o.l., as set by the County Surveyor

from which

A White Fir, 18 inches diam., brs. N. 23° 54' E., 15.9 feet dist., with healed blazes. Dist. to center of tree.

A Fir, 42 inches diam., brs. N. 27°19' W., 79.9 feet (slope 81.2) dist., scribing visible. OBT Dist to center of tree (Gov't. Rec. N. 30° W., 81.8 feet to center)

1/4 CORNER common to Sections 30 and 31, Township 40 South, Range 2 East.

At the corner point set a 30 inch by 2 inch diam. galvanized iron pipe, 25 inches in the ground with 3 inch diam., bronze cap mkd.

Page 2
Robert Hardy and Richard Cottle

The Government corners as found and set are described below:

SECTION CORNER common to Sections 20, 21, 28 and 29, Township 40 South, Range 2 East.

At the corner point found a 1 inch galvanized iron pipe with 2½ inch diam. bronze cap per County Surveyor's records.

1/4 CORNER common to Sections 20 and 29, Township 40 South, Range 2 East.

At the corner point found a 5"x14"x? stone, exposed 9"±, with 1/4 chiseled on North face from which

A Cedar, 33 inches diam., brs. N.15°25' W., 40.8 feet (Gov't. Rec. N. 15° W., 41.6 feet) dist., to face of blaze OBT

A Fir, 46 inches diam., brs. S.77°02' W., 21.9 feet (Gov't. Rec. S. 75° W., 22.4 feet) dist., to face of blaze opened and found scribing. OBT

On August 17, 1972 a returned visit to this corner revealed a 3/4" iron pin with 2½" diam. bronze cap mkd.

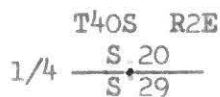

this pin is at the exact location of the above described stone. See Recorded Survey No. 5318.

SECTION CORNER common to Sections 19, 20, 29 and 30, Township 40 South, Range 2 East.

At the corner point found a 7"x7"x18" basalt stone with 5 notches on East and 2 notches on South face from which

A Y. Pine, 51 inches diam., brs. N. 35°14' E., 225.1 feet (Gov't. Rec. N. 36°20' E., 224.4 feet) dist., scribing visible. Dist. center of tree. OBT

A Fir Snag, 21 inches diam., brs. N. 74°55' W., 93.3 feet (Gov't. Rec. N. 70° W., 95.0 feet) dist., scribing visible. Dist. center of tree. OBT

At the exact location of said stone, set a 20 inch by 1½ inch diam. galvanized iron pipe, 22 inches in the ground with a 2 3/4 inch diam. bronze disk mkd.

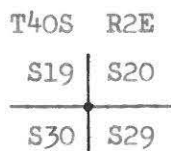

RLS 759 1972

deposited stone along side pipe from which new trees scribed are as follows:

A Cedar, 7½ inches diam., brs. N. 30°50' W., 14.96 feet dist., scribed T.40S R2E S19 BT.

A White Oak, 5½ inches diam., brs. S. 56°34' W., 27.45 feet dist., scribed T40S R2E S30 BT.

SURVEY NARRATIVE TO COMPLY WITH PARAGRAPH 209.250
OREGON REVISED STATUTES

- SURVEY FOR:** Robert Hardy and Richard Cottle
P. O. Box 627
Ashland, Oregon 97520
- LOCATION:** Situated in the East half of Section 29, Township 40 South, Range 2 East of the Willamette Base and Meridian, Jackson County, Oregon.
- PURPOSE:** To survey, monument and prepare legal descriptions for the tracts of land shown on the accompanying map, per clients request.
- PROCEDURE:** Commenced this survey June 7, 1972 by searching for the Government Section and Quarter Section Corners necessary to subdivide Section 29, Township 40 South, Range 2 East.

After a complete on the ground investigation of said corners it was learned that the South quarter corner of Section 29 had been destroyed by Interstate Highway No. 5 construction, if in fact this corner was in at the time of construction. Proceeding Westward to the section corner common to Sections 29, 30, 31 and 32 a search was made for the original post and mound of stones as placed there by Nathaniel Ford, Government Contract Surveyor, around September 25, 1855. Nothing was found at this corner that could be positively identified as the original corner. Therefore, a search for the quarter corner common to Sections 30 and 31, was necessary. Before this corner was found and positively identified, it was necessary to tie the section corner common to Sections 30 and 31, only, as reestablished by the Cadastral Surveyor, Dept. of Interior, Bureau of Land Management. Then the quarter corner common to Sections 31 and 32 was needed. This corner and its references were in a very high state of deterioration and therefore, required that I find the section corner common to Sections 31 and 32, Township 40 South, Range 2 East and Sections 5 and 6, Township 41 South, Range 2 East to help verify the position of this quarter corner. With this data compiled and computed, proceeded to subdivide Section 29 as shown on the accompanying map.

At this time it should be noted that in running the North-South center-line of the Northeast quarter of said section, it was found that a house had been built over the line and onto my clients property. After much discussion with the party owning said house it was learned that apparently someone, maybe the State Highway survey crew, had surveyed some lines in this area and were thought to be the sixteenth section lines. However, without a legal subdivision of Section 29, as provided by law, the legal interior sixteenth section lines cannot be established. This encroachment is being settled at this time.

It should be noted that the distance between the Northeast Section corner and the North quarter corner of Section 29, Township 40 South, Range 2 East as reported on the Interstate Highway No. 5 maps, is in error by some 100 to 140 feet. Therefore, caution should be exercised when using these state maps in this area.

Nathaniel Ford under Contract No. 58, dated April 18th, 1855 ran the exterior boundaries of Section 29, Township 40 South, Range 2 East. Rufus S. Moore under Contract No. 637, dated May 15th, 1895 resurveyed the North boundary of Section 29. However, the corners as set by Nathaniel Ford were held in place by Rufus S. Moore. Rufus S. Moore does show a different set of values on the North boundary of Section 29 and I have shown both sets of data on my map.

