

S.W. CORNER D.L.C. NO. 51  
FOUND 1-1/2" IRON PIPE

MAP OF SURVEY  
LOCATED IN  
N.E. 1/4 OF SECTION 4, T. 37 S., R. 2 W., W.M.  
JACKSON COUNTY OREGON  
FOR

MRS. EILEEN PETERSON

J. A. HOFFBUHR, REG. L.S., MEDFORD, OREGON  
SCALE: 1"=100' JULY 23, 1973  
BASIS OF BEARING - R/S NO. 4274  
= SET 5/8" X 24" IRON REINFORCING PIN

REGISTERED  
PROFESSIONAL  
LAND SURVEYOR

*J. A. Hoffbuh*

OREGON  
NOV. 7, 1947  
J. A. HOFFBUHR  
222

N 00° 02' 42" E 932.77'

FOUND 1" IRON PIPE

N 89° 45' 58" E 714.92'

R/S NO. 4274

S.E. CORNER D.L.C. NO. 46



AVERAGE & DITCH

6.00  
WITNESS CORNER

N 00° 53' 42" W 200.64'

S 88° 32' 37" E 477.85'

WITNESS CORNER

200.61'

30'

N 00° 41' 02" W

GRANT ROAD

200.61'

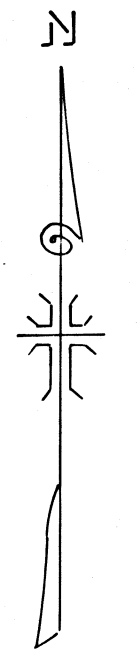

BOUNDARY LINE AGREEMENT

WITNESS CORNER

N 88° 32' 37" W 483.11'

30'

1/4 SECTION CORNER  
FOUND 1" IRON PIPE

WEST 530.12'

SOUTH 5.90'

SURVEY NARRATIVE TO COMPLY WITH PARAGRAPH 209.250  
OREGON REVISED STATUTES

SURVEY FOR: Mrs. Eileen M. Peterson  
4675 Grant Road  
Central Point, Oregon

LOCATION: Tract situated in the East One Half (1/2) of  
Section 4, Township 37 South, Range 2 West,  
Willamette Meridian, in Jackson County, Oregon.

PURPOSE: To monument and describe that tract of land  
as shown on the attached map.

PROCEDURE: Found Donation Land Claim, One Quarter (1/4)  
Section, and other corners as shown on map, and used as a basis for  
survey control. Average centerline of the irrigation lateral was  
established and used as the west boundary of the tract. A boundary  
line agreement was determined on existing fence on the south bound-  
ary. Set 5/8 inch iron pins as shown.

Basis of Bearings--Recorded Survey No. 4274.

November 29, 1973

J. A. Hoffbuhr  
Professional Land Surveyor

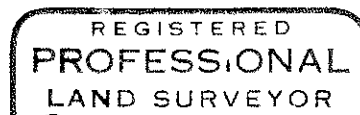
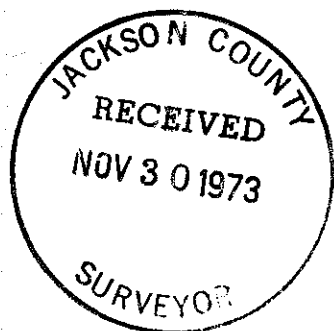

*J. A. Hoffbuhr*

