

5463

5463-A

FD 3/4" IRON BOLT

R/S NO. 951

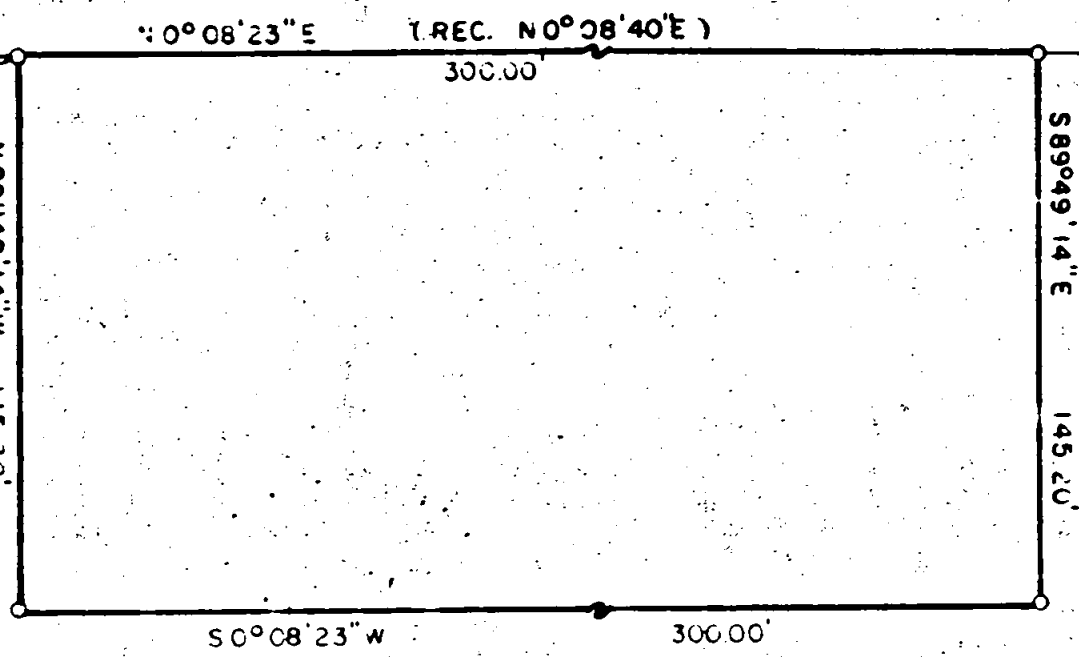

FD 1/4" IRON PIPE  
 22 S89°49'14"E 1783.09'  
 21 S89°49'14"E

RESTART SECUR O.L.C. NO 62  
 FD 1/2" IRON PIPE

FD STONE WITH LEAD PLUG

(REC. S89°48'30"E)  
 2632.15

FD STONE WITH LEAD PLUG  
 23  
 26

RECEIVED  
 NOV 20 1973  
 SURVEYOR

REGISTERED  
 J. A. HOFFBUHR  
 SURVEYOR

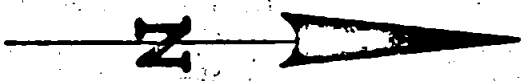

MAP OF SURVEY

LOCATED IN  
 SE 1/4 OF SEC. 22, T. 37 S., R. 1 W., W.M.  
 JACKSON COUNTY OREGON

FOR  
 MEDFORD WATER COMMISSION

J. A. HOFFBUHR, REG. S., MEDFORD, OREGON  
 SCALE 1" = 60'  
 DEC. 10, 1970  
 BASIS OF BEARING: HILLCREST HEIGHTS SUBD  
 ○ : SET 5/8" X 24" IRON PIN  
 ■ : FD 3/4" IRON BOLT

5463

SURVEY NARRATIVE TO COMPLY WITH PARAGRAPH 209.250  
OREGON REVISED STATUTES

SURVEY FOR: Medford Water Commission  
City of Medford  
Medford, Oregon

LOCATION: Tract situated in the Southeast One Quarter (1/4)  
of Section 22, Township 37 South, Range 1 West,  
Willamette Meridian, Jackson County, Oregon.

PURPOSE: To monument and describe the boundaries of the  
tract shown on the attached map.

PROCEDURE: The section line between the Northeast Corner of  
Section 27 and the One Quarter Corner common to Sections 22 and 27  
was traversed and intersected with the east line of Donation Land  
Claim No. 62. A difference was found in the location of the Donation  
Land Claim corner, and the re-established Donation Land Claim corner.  
The record calls for the Donation Land Claim corner to be situated on  
the section line. The tract was described from the One Quarter corner  
and the Donation Land Claim corner was disregarded. The tract was  
staked as directed by the client.

Basis of Bearings--Hillcrest Heights Subdivision.

November 29, 1973

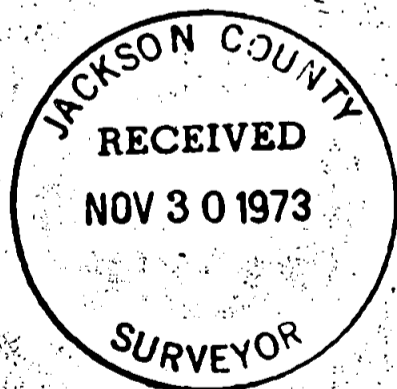

J. A. Hoffbuhr  
Professional Land Surveyor

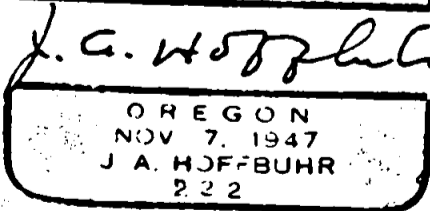
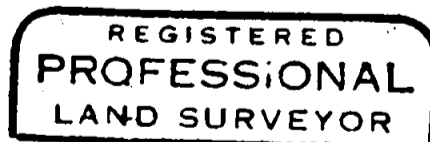

S22 T371W