

N 89° 06' 10" E
800.08' FD. 1" IRON PIPE

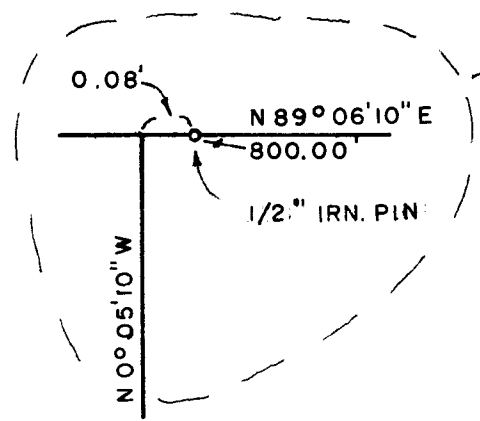

N 0° 05' 10" W 2094.58' Calc'd

EAST 800.00'

S 0° 05' 10" E

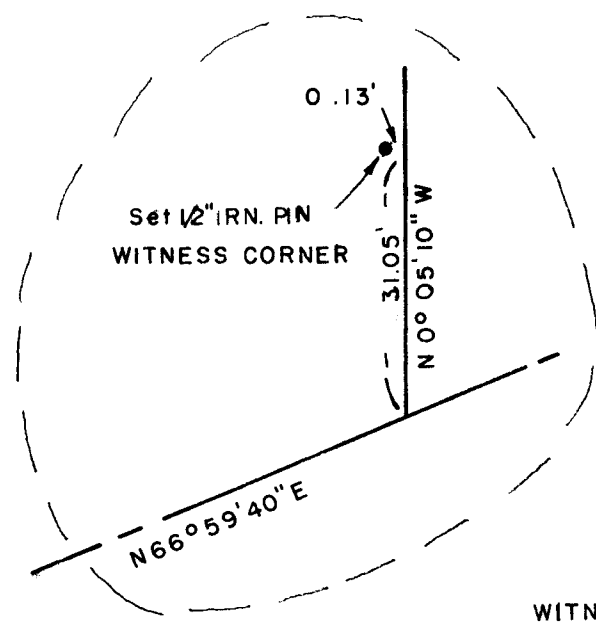
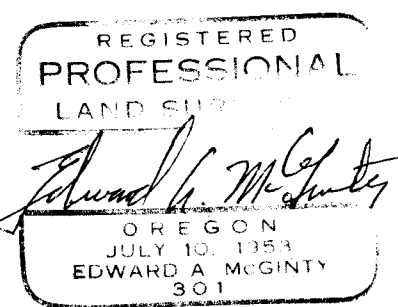
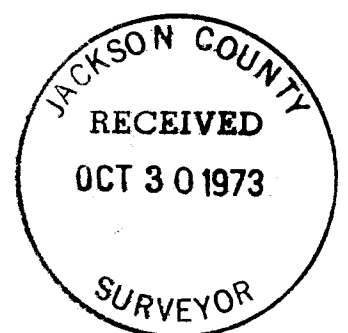

MAIN-TRAVELED R/W DEAD INDIAN COUNTY ROAD / Sur. No 4016

SURVEY IN
SEC. 1 AND SEC. 12, T. 39S., R. 1E., W. M.
FOR
HARRY C. FISHER

WITNESS CORNER
FD. 1" IRON PIPE
REC. SURVEY NO. 4016
53.30
28.97
N 78° 14' 50" E
R=954.93
L=187.55
95.69

BY EDWARD A. MCGINTY
MEDFORD, OREGON
SCALE 1" = 200'
SEPT. 20, 1973
73-32

SURVEY NO. 5432

SURVEY NARRATIVE TO COMPLY WITH O.R.S. 209-250

SURVEY FOR: Harry Fisher 73-32
5837 Calpine Drive
San Jose, Calif. 95123

SURVEY BY: Edward A. McGinty, R.S.
Medford, Oregon
September 1973

LOCATION: SE. 1/4 of Sec. 1 and NE. 1/4 of Sec. 12, T39S, R1E

BASIS OF BEARING: Survey No. 4016

PRECEDENCE OF SURVEY:

From previous survey No. 4016, computed division line being 800.00 feet westerly and parallel. This distance would be equivalent to 800.08 feet along the North-line. Ran southerly (bearing only) to intersect said survey as shown and computed intersection.

The center-line of Dead Indian Road is shown as on Survey No. 4016 which may not be the true center-line of said road. This should not be construed otherwise. This location was discussed with the County Road Department which could not find either the width or the location in this area.

