

..5418

R/S
4643

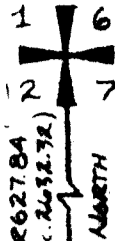

1" PIPE FOUND

R/S 195

2676.05
(REC. 2647.32)

NE 1/4 OF SW 1/4

EAST

N 76°45'16" E

N 20°52'02" W

15.43'

188.47'

Δ: 7°45'
R: 1438.69'
D: 4°00'
L: 192.96'

238
267.00'

N 69°02'16" E
OREGON STATE HIGHWAY

S 12°02'05" W

S 20°15'20" E



NW 1/4 OF SE 1/4

N 19°11'14" W
148.11'

SOUTH
1213.75'

BOUNDARY LINE AGREEMENT

MAP OF SURVEY
LOCATED IN
NE. 1/4 OF SECTION 12 T38S, R3W
JACKSON COUNTY
OREGON

FOR
WILLIAM C. HAYES
J.A. HOFFBUHR, REG. L.S., MEDFORD,
OREGON

SCALE: 1" = 100' 9 JULY, 1973
BASIS OF BEARING - R/S 4643

- SET 5/8" X 24" IRON PIN
- FOUND 1" GALV. IRON PIPE

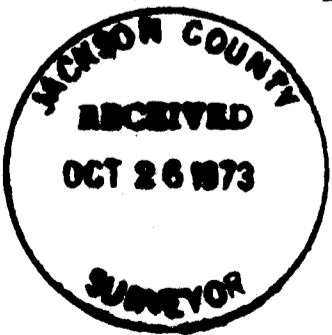

REGISTERED
PROFESSIONAL
LAND SURVEYOR

OREGON
NOV 7 1973
J.A. HOFFBUHR
272

SURVEY NARRATIVE TO COMPLY WITH PARAGRAPH 209.250
OREGON REVISED STATUTES

SURVEY FOR: William C. Hayes
3700 Hwy. No. 238
Jacksonville, Oregon

LOCATION: Tract situate in Section 12, Township 38 South, Range
3 West, Willamette Meridian, Jackson County, Oregon.

PURPOSE: To establish and monument property corners of tract
as shown by the attached map.

PROCEDURE: This section has never been legally subdivided but there
have been several corners established by previous surveys based on an
attempt made by Engineer Clabby to establish the Center One Quarter (1/4)
and other corners in Recorded Survey No. 195. These corners have been
used to dimension other descriptions over the years. These corners
were tied and used for this survey and the client's decision to agree
on the North Line as established by a Boundary Line Agreement.
Basis of Bearings--Recorded Survey No. 4643.

October 9, 1973

J. A. Hoffbuhr
Professional Land Surveyor

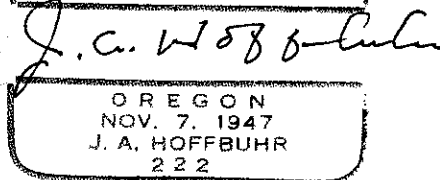
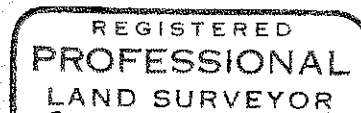
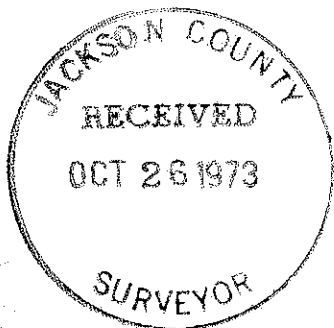

OREGON
NOV. 7, 1947
J. A. HOFFBUHR
222