

**SURVEY NARRATIVE TO COMPLY WITH PARAGRAPH 209.250
OREGON REVISED STATUTES**

SURVEY FOR: Wallace M. Larson
3327 Old Stage Road
Central Point, Oregon

LOCATION: Tract situate in Southwest One Quarter (1/4) of Section
9, Township 37 South, Range 2 West, Willamette Meridian,
Jackson County, Oregon.

PURPOSE: To survey, monument, and describe that tract of land
as shown on the attached map.

PROCEDURE: As shown on attached map and located Section Corner and
other monuments, and the existing Medford Irrigation District Canal as
control for the survey. Set 5/8 x 24 inch iron pins as indicated for
the property boundary.

Basis of Bearings--Recorded Survey No. 2286.

October 8, 1973

J. A. Hoffbuhr
Professional Land Surveyor

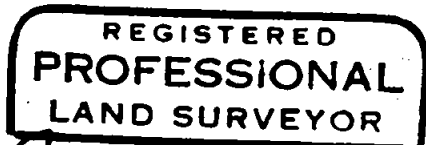
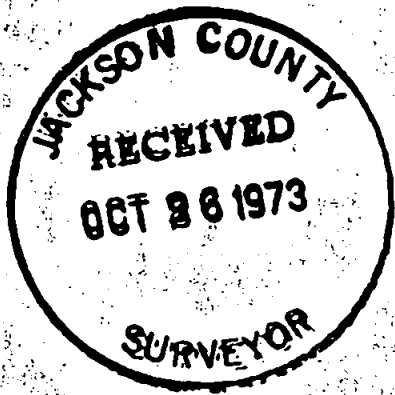

J. A. Hoffbuhr

