

SURVEY FOR:

WHITE CITY CORP.

LOCATED IN THE NORTH-HALF OF SEC. 19,

T. 36 S.R. 1 W., W.M.

BY: MARK E. BOYDEN

OCT. 8, 1973

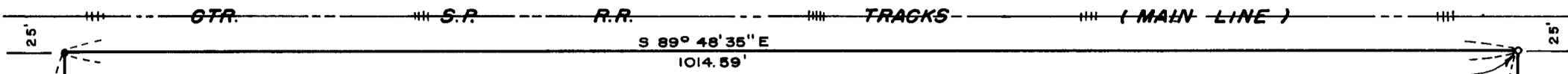

FD. 1/2" I. PIPE 6" DEEP WHICH BEARS SOUTH 2.69' AND WEST 2255.10' FROM THE NE. COR. OF SEC. 19

1211.66'

27.00 Ac.



SCALE 1"=100'

BASIS OF BEARINGS

RECORDED SURVEY NO. 4957

- ⊙ CONC. MON./ BR. DISK IN MON. CASE
- SET 3/4" x 24" I. PIN FLUSH
- FD. MON. AS INDICATED

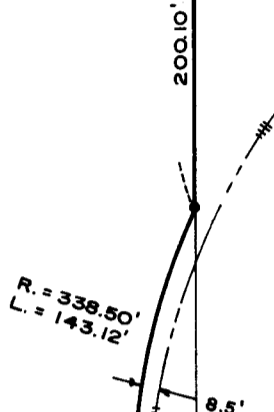
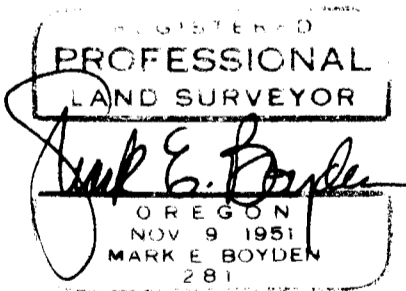
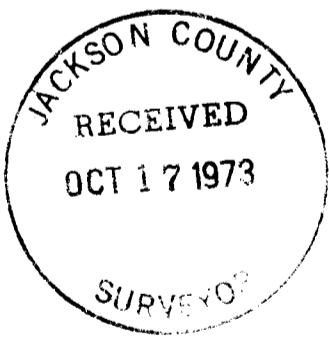

N 0° 11' 45" E

S 1° 03' 50" W

S 3° 10' W 41.03'

R=341.50' L=367.58'

FIR-PLY, INC. INSTRUMENT NO. 71-15059

Manhole

Manhole

POWER LINE

10' DRAINAGE EASEMENT

777.70' N 89° 48' 15" W AVE.

4TH ST.

7TH ST.

SURVEY NARRATIVE TO COMPLY WITH O. R. S. 209.250

FOR: White City Corporation
White City, Oregon

PURPOSE: To monument and describe a tract within the White City Corporation ownership proposed to be conveyed, being located in the North-half of Section 19, T36SR1W, W. M..

PROCEDURE: Utilizing a one-second theodolite, an electronic measuring instrument and chain, enclosed the subject tract. Ties were made to controlling monuments and the tract was then monumented at positions as shown on the map to accompany this report.

October 8, 1973

