

5379
5379

1/4 COR.
FD. PIPE
W/BR. CAP mkd.
T40S R2E
1/4 20/21 COR
RLS 759 1970
Re: R.S. No. 4250

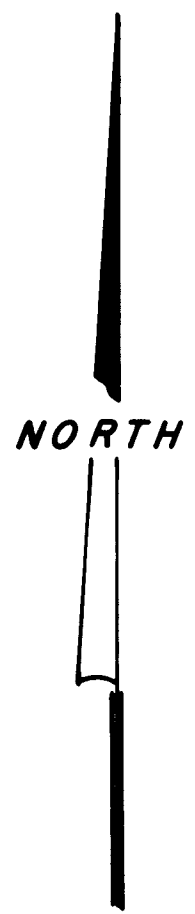
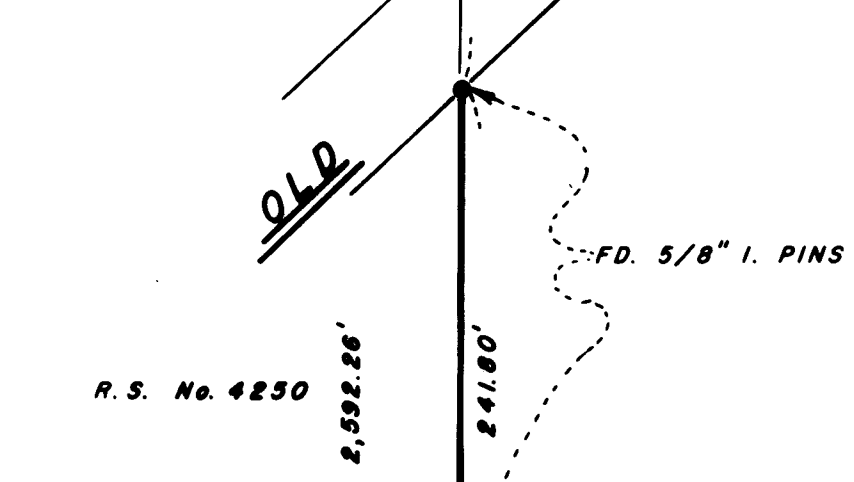

SISKIYOU

HWY. ALIGNMENT per
R.S. No. 3341

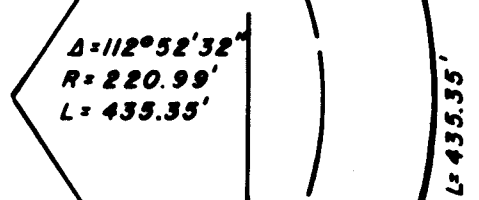

HIGHWAY

S 1/16 COR.
SET 1/2" PIPE
W/ALUM. CAP mkd.
T40S R2E
20/21
S 1/16
RLS 759 1973
FD. 1" I. ROD
BRS. N. 16°30'19" W
9.25'
N. 00°33'37" E
N. 00°26'28" E
1,296.13'
78°29'56" S. 78°03'28" E.
per STATE HIGHWAY

FD. PIPE
W/BR. DISK

INSTRUMENT No. 69-09657

746.75'

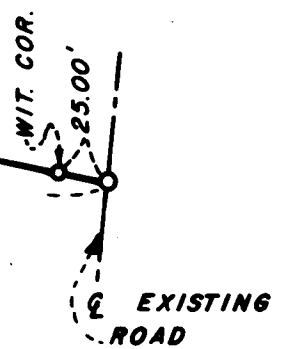

REGISTERED
PROFESSIONAL
LAND SURVEYOR

Everett L. Swain
OREGON
JULY 6, 1966
EVERETT L. SWAIN
759

MAP OF SURVEY

LOCATED IN
SW 1/4 OF SEC. 21, TWP. 40S., R. 2 E. W. M.
JACKSON COUNTY OREGON
FOR

ROBERT VAN VLEET

EVERETT L. SWAIN, R.L.S. ASHLAND, OREGON
JULY 30, 1973

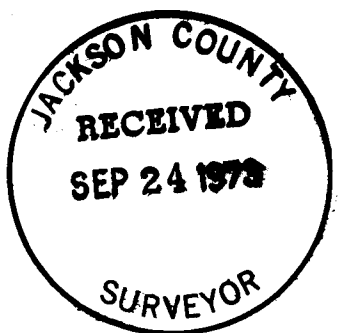

SCALE: 1" = 100'
BASIS OF BEARING
● FOUND MONUMENTS AS SHOWN
○ SET 5/8 x 24 INCH IRON PIN WITH ALUMN. CAP

5379

SURVEY NO. 5379

SURVEY NARRATIVE TO COMPLY WITH PARAGRAPH 209.250
OREGON REVISED STATUTES

SURVEY FOR: Robert Van Vleet
375 Lithia Way
Ashland, Oregon 97520

LOCATION: Situated in the Southwest quarter of Section 21, Township 40
South, Range 2 East of the Willamette Base and Meridian, Jackson
County, Oregon.

PURPOSE: To establish the Westerly and the Northeasterly boundary of those
tracts as designated by the client and shown on the accompanying
map.

PROCEDURE: From previous survey control, established on recorded survey No.
4250, surveyed the property lines as shown on the accompanying map.

At the South sixteenth corner common to Sections 20 and 21, said
Township and Range, set a ½ x 30 inch galvanized iron pipe with
2 inch alumn. cap, mkd.

T40S R2E
20|21
S1/16
RLS 759 1973

from which

Found a 1 inch iron rod which bears North 16°30'19" West, 9.25
feet. Origin of this iron rod unknown.

A Black Oak, 6½ inches in diam., bears South 70°48' East, 12.6
feet, scribed S 1/16 S21 BT.

A Fir, 15 inches in diam., bears South 23°06' West, 24.36 feet,
scribed S 1/16 S20 BT.

NOTE:

The 1 inch iron rod found in the vicinity of the South sixteenth
corner is referred to by the Oregon State Highway (Interstate
Highway No. 5) right of way maps and recorded survey No. 3341.

In computing the position of the sixteenth corner using state data,
this iron rod does not fall within acceptable accuracy limits as
specified in the "Manual of Surveying Instructions" dated 1947.
The sixteenth corner is to be midway and on the section line, but
falls considerable outside these requirements. Therefore, using my
own retracement data, I proceeded to set the south sixteenth as
heretofore described.

July 30, 1973

Everett L. Swain
Professional Land Surveyor
Ashland, Oregon

