

5320

5320

RIVER

ROGUE

RIVERDALE

Lot 2  
TRACTS

Survey 394

REGISTERED  
PROFESSIONAL  
LAND SURVEYOR

*Larry J. Friar*

OREGON  
JULY 16, 1971  
LARRY J. FRIAR  
961

SCALE 1" = 100'

○ = SET 5/8" IRON PIN (FLUSH)

⊗ = FD. 3/4" IRON PIPE SET  
IN CONCRETE

FD. 3/4" PIPE

FD. 1/2" PIPE  
IN CONC.

S. LINE  
D.L.C. No. 40

148.60' (REC. & MS.)  
551° 30' W

Survey  
No. 1506

(REC. & MS.)  
112.22'

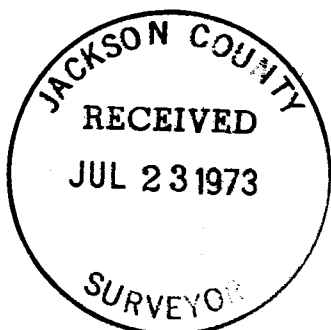

MAP of SURVEY  
for

HENRY C. BACON

located in lot 2 Riverdale Tracts  
Subdivision

Sec. 21, T.36S., R.4W., W.M.  
Jackson Co., Oregon

Basis of Bearing R.S. 1506  
June 1973

By L. J. Friar P.L.S. 961

5320

Survey No. 5320

SURVEY NARRATIVE TO COMPLY WITH PARAGRAPH 209.250  
OREGON REVISED STATUTES

FOR: Henry C. Bacon  
8284 Rogue River Hwy.  
Grants Pass, Oregon

PURPOSE: To Monument Property Lines.

PROCEDURE: Found monuments set in Survey No. 394 & recovered in  
Survey No. 1506. Also found monuments set in un-recorded survey.  
Using the found monuments for control I set monuments as shown  
on the attached map.

July 1973

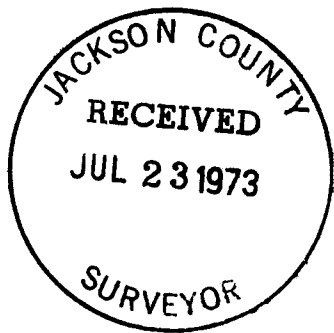

Larry J. Friar  
Professional Land Surveyor

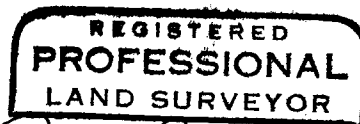

*Larry J. Friar*

