

Note:
This boundary was not established on the ground by this survey. The approx. position of said boundary as shown hereon was calculated from record based on O.S.H.D. coordinates of corners in Sec. 7 and 18.

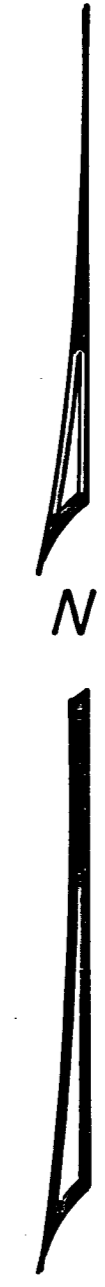

SCALE 1"=100'

Basis of Bearings: O.S.H.D. Grid bearings rotated 1° 32' 38" CCW

V 358 P321

72-15128 O.R.J.C.O.

LEGEND

- o = Set 5/8" x 30" Iron Pin (tagged R.L.S.638)
- = Found monument as shown
- - - = Boundary not established by this survey
- x-x-x = Existing fence

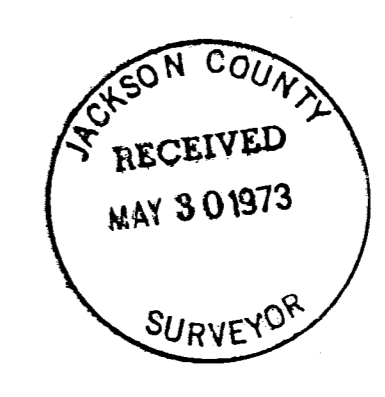

REGISTERED PROFESSIONAL LAND SURVEYOR
George Burrell
OREGON JULY 10, 1964
GEORGE R. BURRELL
E.S.

Map of Survey

Located in Sections 7 and 18, Twp 36S, R1E, W.M.
For: ROBERT EMERY WILLIAMS, OREGON
By: George Burrell Surveyor Mar. 1973

SURVEY NARRATIVE TO COMPLY WITH O.R.S. 209.250

FOR: Robert Emery
264 Norton Rd.
Williams, Ore.

PURPOSE: To monument and describe the tracts as shown on the accompanying map.

PROCEDURE: Bearing control was established from O.S.H.D. monuments along Highway No. 140. Using the reestablished section corner monuments the tracts were then located according to clients instructions. That portion of the Westerly Boundary of the tract described in Doc. 72-15128 was established according to the client and the adjoiners instructions and was finalized by agreement (see Doc. No. 73-06094) as the original boundary involved D.L.C. monuments not now in existence. The boundary of the tract described in Vol. 358, Page 321 was not established by this survey due to reasons of economy. Accordingly wooden stakes were set giving the directions of the lot lines established by this survey.

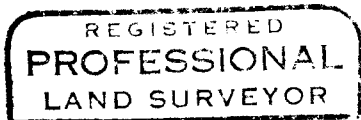

George Burrell

