

1/4 SECTION CORNER  
FD. 1" PIPE IN MOUND OF STONE

34 T.33S. R.1W.  
3 T.34S. R.1W.

4,821.48'

S.03°35'11" W.

No. 62 (MEDFORD-CRATER LAKE HIGHWAY)

ACRES

FD. 3/4" CRIMPED  
PIPE PER R.S. 2005

N.05°32'47"W.  
87.69'  
(R.S. NO. 2005  
N.14°43' W. 88.4')

PROPOSED  
BOUNDARY LINE AGREEMENT

V. 589 P. 10  
D.R. J.C.O.

350.0'

V. 529 P. 96  
D.R. J.C.O.

FD. 3/4" I. PIPE  
PER R.S. NO. 2005

S.87°23'E.

ROGUE RIVER

NORTH

HIGHWAY

ROGUE

REGISTERED  
PROFESSIONAL  
SURVEYOR

*Everett L. Swain*

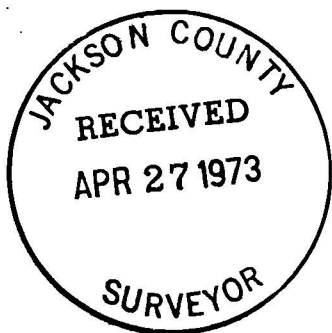

MAP OF SURVEY  
LOCATED IN  
SEC. 3, TWP. 34S. R. 1 W.W.M.  
JACKSON COUNTY OREGON  
FOR

ARTHUR WATKINS

EVERETT L. SWAIN, R.L.S.

ASHLAND, OREGON

SCALE: 1"=100'  
BASIS OF BEARING

MARCH 27, 1973  
RECORDED SURVEY No. 3506

- FOUND MONUMENTS AS SHOWN
- SET 1x39 INCH G.I. PIPE WITH 2 1/2 INCH BRASS CAP

SURVEY NO. 5201

SURVEY NARRATIVE TO COMPLY WITH PARAGRAPH 209.250  
OREGON REVISED STATUTES

SURVEY FOR: Arthur Watkins  
P. O. Box 237  
Shady Cove, Oregon 97539

LOCATION: Situated in Section 3, Township 34 South, Range 1 West of the  
Willamette Base and Meridian, Jackson County, Oregon.

PURPOSE: To survey the division line between Lots 35 and 36, Rogue Acres  
Subdivision per recorded survey no. 2005 and prepare a description  
for a boundary line agreement, per clients request.

PROCEDURE: The division line between Lots 35 and 36 of Rogue Acres Subdivision,  
per recorded survey no. 2005, was re-established per the request of  
Arthur Watkins, Shady Cove, Oregon. Due to the procedure used in  
recorded survey no. 2005, it was recommended to the client to seek a  
boundary line agreement, thereby eliminating the necessity of retracing  
the subdivision for excess and deficiency distribution.

March 27, 1973

Everett L. Swain  
Professional Land Surveyor  
Ashland, Oregon

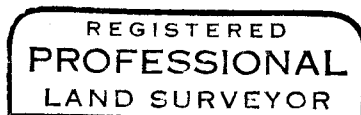
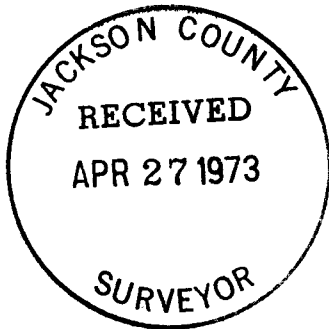

*Everett L. Swain*

