

JACKSON COUNTY  
 RECEIVED  
 FEB 26 1973  
 SURVEYOR

BERKLEY WAY

S 00° 15' 15" E

FOUND 5/8" IRON P.N.  
0.4' EAST OF LINE

SPRING STREET

S 89° 44' 40" E

30'

30'

153.00'

76.50'

72.07'

S 89° 44' 40" E

89° 29' 29"

30'

30'

FOUND 5/8" IRON PIN

LOT 21

N 00° 15' 15" W 290.78'

S 00° 15' 15" E 290.78'

163.00'

SETLEAD PLUG  
AND TACK

N 59° 44' 40" W

76.50'

SURVEY NO. 4296

REGISTERED  
 PROFESSIONAL  
 LAND SURVEYOR

*C. Hoffbuh*

OREGON  
 JAN 7 1947  
 J. A. HOFFBUHR  
 222

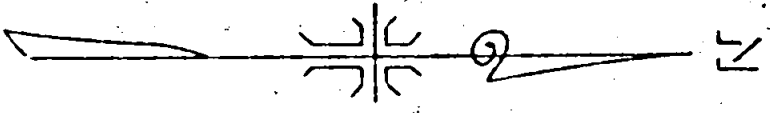

MAP OF SURVEY  
 LOCATED IN  
 "FAIRVIEW" S. CHILDERS EASTERN ADDITION  
 TO THE CITY OF MEDFORD  
 N.W. 1/4 OF SECTION 20, T. 37 S., R. 1 W., W.M.  
 JACKSON COUNTY OREGON

FOR  
**JAMES HALL**

J. A. HOFFBUHR, REG. L.S., MEDFORD, OREGON  
 SCALE: 1" = 50'  
 BASIS OF BEARING R/S NO. 4296  
 SET 5/8" X 24" IRON REINFORCING PIN

SURVEY NO. 5103

SURVEY NARRATIVE TO COMPLY WITH PARAGRAPH 209.250  
OREGON REVISED STATUTES

SURVEY FOR: Mr. James Hall  
1540 Spring St.  
Medford, Oregon

LOCATION: Tract situated in the Northwest One Quarter  
(1/4) of Section 20, Township 37 South, Range  
1 West, Willamette Meridian, in Jackson County,  
Oregon.

PURPOSE: To revise the dimensions of the tract previously  
surveyed and shown in Record of Survey No. 5083  
at the request of the client.

PROCEDURE: The Northeast and Southeast corner pins were  
removed and reset to conform with the attached map.

February 20, 1973

J. A. Hoffbuhr  
Professional Land Surveyor

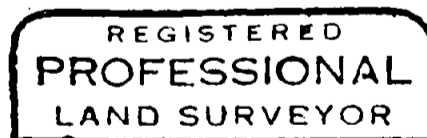
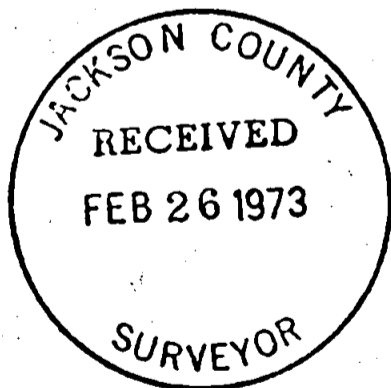

*J. A. Hoffbuhr*

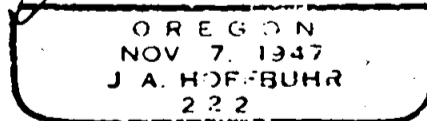

T37 S20 R14