

Date: October 25, 1972
By: Edward A. McGinty
For: Wayne Safley

ADDENDUM TO SURVEY NO. 4950: At request of Mr. Wayne Safley the following descriptions are to be added to the survey on file.

TRACT NO. 1: Commencing at the Southeast corner of Government Lot No. 3, Section 29, Township 35 South, Range 1 West, Willamette Meridian, Jackson County, Oregon, according to the official plat of record; thence North 0° 00' 06" West along the East line of said Lot, 1295.75 feet to a 5/8 inch iron pin at Point A; thence North 89° 38' 42" West, 42.12 feet to a 5/8 inch iron pin at Point B; thence North 0° 43' 00" East, 342.79 feet to a 5/8 inch iron pin, being the point of beginning; thence continuing North 0° 43' East, 294.00 feet to a 5/8 inch iron pin; thence North 86° 33' 50" West, 711.83 feet, more or less, to the average high water mark of the Rogue River; thence southerly along said high water mark, 339.60 feet, more or less, to a point from which the point of beginning bears South 89° 38' 42" East, 641.32 feet; thence South 89° 38' 42" East, 641.32 feet to the point of beginning. CONTAINS 4.81 acres more or less.

TRACT NO. 3: The Northerly 5 acres of a 20.75 acre tract: Commencing at the Southeast corner of Government Lot No. 3 in Section 29, Township 35 South, Range 1 West, Willamette Meridian, Jackson County, Oregon, according to the official plat of record, recorded in Jackson County; thence North 0° 00' 06" West along the center of said Section a distance of 1285.33 feet to the point of beginning; thence continuing North 0° 00' 06" West, 36.67 feet; thence North 89° 38' 42" West, 41.79 feet; thence North 0° 43' 00" East, 316.54 feet to a 5/8 inch iron pin; thence North 89° 38' 42" West, 641.32 feet more or less, to the average high water mark of the Rogue River; thence Southerly along said high water mark, 357.67 feet to a point from which the point of beginning bears South 89° 38' 42" East; thence South 89° 38' 42" East, 625.03 feet to the point of beginning. CONTAINS 5.00 acres more or less.

TRACT NO. 4: The South 5 acres of the North 10 acres of a 20.75 acres Tract: Commencing at the Southeast corner of Government Lot No. 3 in Section 29, Township 35 South, Range 1 West, Willamette Meridian, Jackson County, Oregon; according to the official plat of record, recorded in Jackson County; thence North 0° 00' 06" West along the center of said Section a distance of 1285.33 feet to the point of beginning; thence South 0° 00' 06" East, 367.65 feet; thence North 89° 38' 42" West, 563.32 feet, more or less, to the average high water mark of the Rogue River; thence Northerly along said mark, 373.36 feet to a point from which the point of beginning bears South 89° 38' 42" East; thence South 89° 38' 42" East, 625.03 feet to the point of beginning. CONTAINS 5.00 acres more or less.

TRACT NO. 5: The South 5 acres of the North 15 acres of a 20.75 acre tract. Commencing at the Southeast corner of Government Lot No. 3 in Section 29, Township 35 South, Range 1 West, Willamette Meridian, Jackson County, Oregon; thence North 0° 00' 06" West, 917.68 feet to the point of beginning; thence South 0° 00' 06" East, 406.10 feet; thence North 89° 38' 42" West, 510.44 feet, more or less, to the average high water mark of the Rogue River; thence Northerly along said mark, 409.86 feet to a point from which the point of beginning bears South 89° 38' 42" East; thence South 89° 38' 42" East, 563.32 feet to the point of beginning. CONTAINS 5.00 acres more or less.

ALSO ANY EXISTING RIGHTS - pertaining to the above descriptions - of any land abutting on the West side to the center of the Rogue River between the extension of the North and South line of the above described tracts.

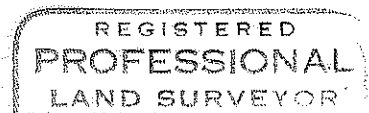
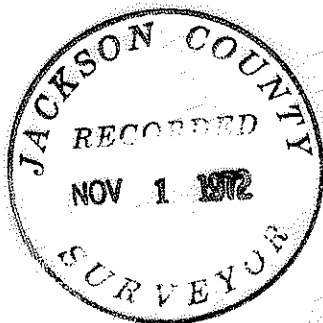

Edward A. McGinty

