

SURVEY NO 4911

SURVEY NARRATIVE TO COMPLY WITH O.R.S. 209-250

TO CORRECT PREVIOUS SURVEY NO 4785

Survey for: Robert Hawkins
208 Summit Ave.
Medford, Oregon

Survey by: Edward A. McGinty
Medford, Oregon
Feb. 18, 1972

Basis of Bearing: Prev. Survey

Location: NW x NE Sec. 6, T38S, R2W.

CORRECTION:

THE WEST LINE OF THE PROPERTY SHOWS THE BEARING TO BE
S. 18° 30' 00" W.

IT SHOULD READ - Deed Record
S. 0° 18' 30" W.

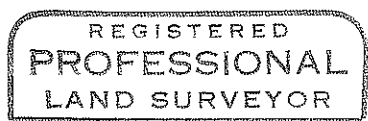
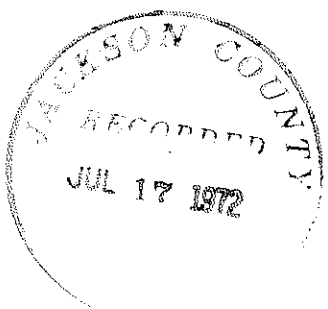

Edward A. McGinty

