

SCALE 1" = 40'

Basis of Bearings R.S. No. 3876

○ = Set 5/8" X 30" Iron Pin tagged RLS638

● = Found 1/2" I. Pipe (unless shown otherwise)

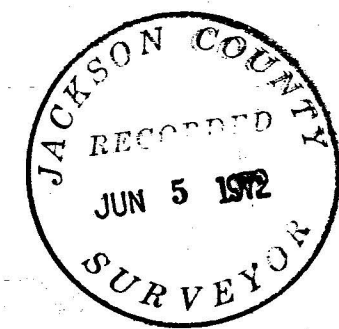

REGISTERED
PROFESSIONAL
LAND SURVEYOR

George Burrell

OREGON
JULY 10, 1964
GEORGE R. BURRELL
638

MAP OF SURVEY

Located in Gov. lot 1, Sec. 8 & D.L.C. No. 40, Twp 39S, R1E
For VAN VLEET & ASSOC. ASHLAND, OREGON

George Burrell Land Surveyor May 1972

SURVEY NARRATIVE TO COMPLY WITH O.R.S. 209.250

FOR: Robert VanVleet
375 Lithia Way
Ashland, Oregon

PURPOSE: To partition the Tract as shown on the accompanying map.

PROCEDURE: The monuments of recorded Survey No. 3876 were recovered and used for control in establishing the new boundary created by this Survey.

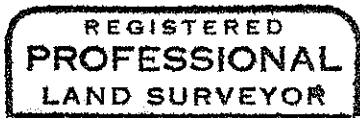

George R. Surrell

