



SURVEY NARRATIVE TO COMPLY WITH PARAGRAPH 209.250  
OREGON REVISED STATUTES

SURVEY FOR: Mr. & Mrs. Leslie Schneider  
900 Siskiyou Boulevard  
Medford, Oregon

LOCATION: Tract situated in the Southwest One Quarter (1/4)  
of Section 15, Township 39 South, Range 3 West,  
Willamette Meridian, Jackson County, Oregon.

PURPOSE: To partition into approximately 5-acre tracts the  
parcel of land indicated on the attached map.

PROCEDURE: The Section line perimeter of the West One Half (1/2)  
of Section 15 was traversed partly by traverse and tape and where  
possible the distances were obtained electronically with angular  
measurements being made by a T-2 Theodolite. The monuments set by  
Recorded Survey No. 2742 were found and checked for accuracy.

The dividing line between the East One Half (1/2) and West  
One Half (1/2) of the Southwest One Quarter (1/4) of the Southwest  
One Quarter (1/4) was established by the proportionment method  
using the North-South center of Section line and the West line of  
the Section. This was only a method to locate the line approximately  
because the tract lines were marked with Witness Corners to the line.

The existing average centerline of the Applegate River was  
traversed and described as shown.

The control obtained from the Jackson County Engineering  
Department was used for the Upper Applegate Road.

It was noted that the County had not vacated the original  
right of way for the road. They had revised the alignment but  
were in possession by record of both the new and the original  
right of ways.

This was called to the attention of the County Commissioners  
and a vacation order was placed of record eliminating the effects  
of the original right of way on these tracts.

The Section Corners were found as indicated on the attached  
map.

Basis of bearings--Oregon State Grid System - South Zone.

February 8, 1972

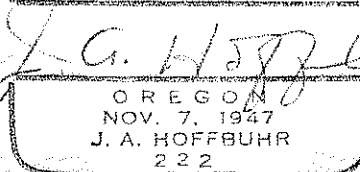
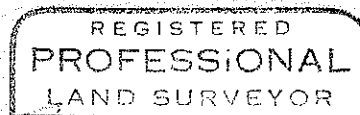
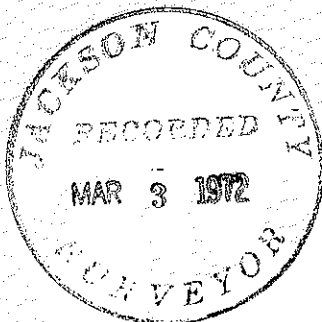

J. A. Hoffbuhr  
Registered Land Surveyor