

4758

Survey for:

HARRY ELMORE

Located in the S. 1/2 Sec. 2, & N. 1/2 Sec. 11

and in D.L.C. No. 56,

T. 37 S. R. 2 W., W.M.

By: Mark E. Boyden

Dec. 30, 1971



SCALE
1" = 200'
Basis of Bearings
Recorded Survey No. 1431

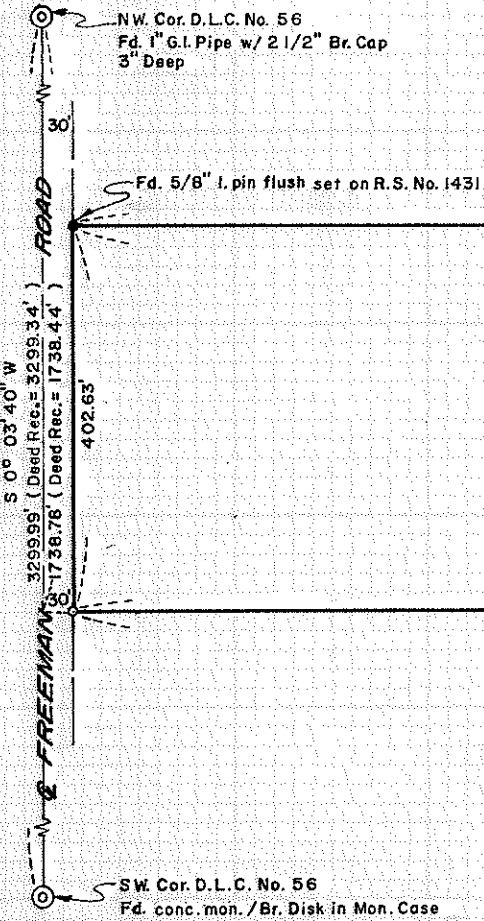

17.77 Ac.

WEST
1744.34'

2106.88'
N 89° 58' 00" E

LEGEND

- Set 3/4" x 30" Iron pin flush
- ⊙ Fd. Govt. Cor. Re-Estab'd by C.S.
- Fd. Mon as indicated

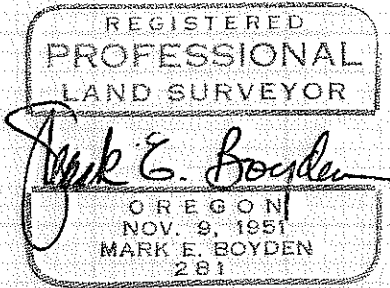
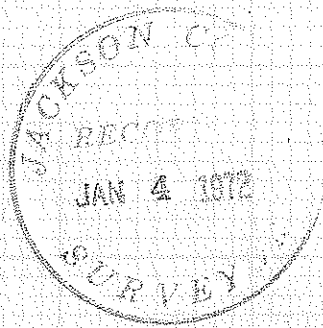
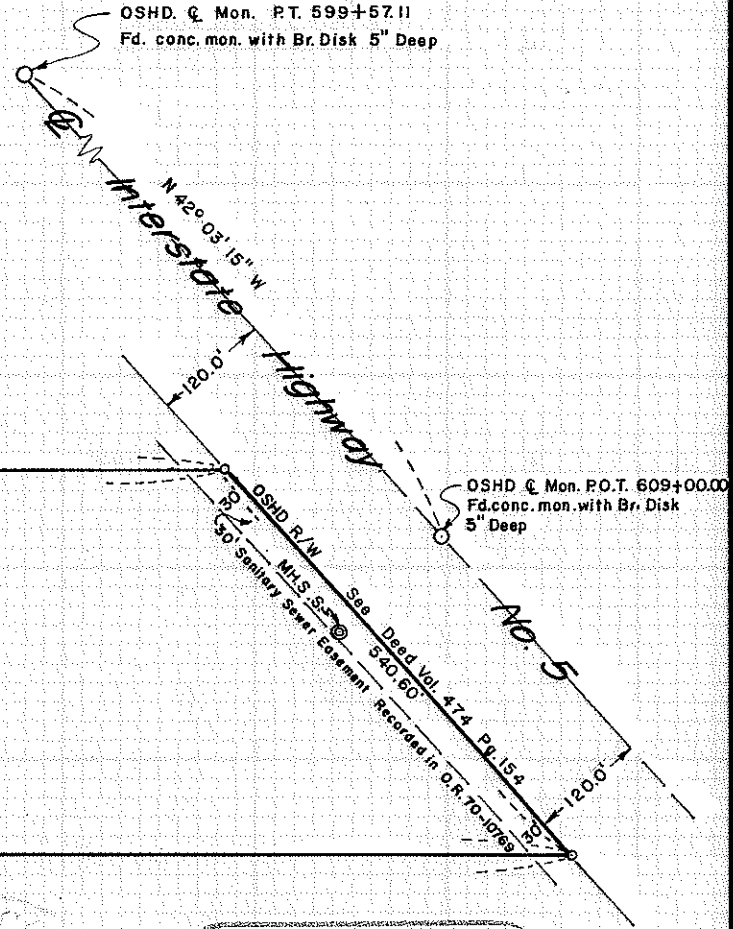

4758

It should be noted that procedures utilized on Recorded Survey Nos. 23 and 3187 appear to lack the "in depth" study required to position the original division lines and therefore the monuments set for the North boundary of these tracts were disregarded and not utilized on this survey.

From said controls, computed the positions of the remaining corners and monumented same as shown on the map to accompany this report.

December 30, 1971

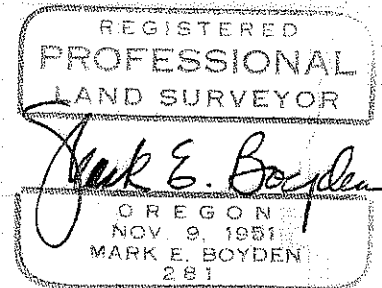
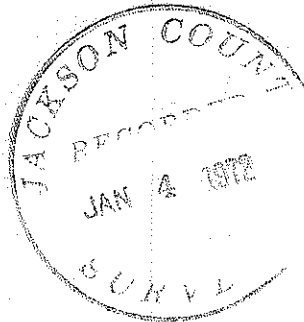

SURVEY NARRATIVE TO COMPLY WITH O.R.S. 209.250

FOR: Harry Elmore
831 Minnesota Avenue
Medford, Oregon 97501

PURPOSE: To monument the corners of that portion of the tract described in Instrument No. 67-04097, Official Records of Jackson County, Oregon lying Southwesterly from the Southwesterly right-of-way line of Interstate Highway No. 5 and lying Easterly from the East right-of-way line of Freeman Road.

PROCEDURE: Utilizing the T2 Theodolite and the HP 3800-A distance meter, tied in the Northwest and Southwest corners of DLC #56, Interstate Highway No. 5 centerline P.O.T. station 609+00 and the turned angle along said highway centerline to P.T. Sta. 599+57.11. Also turned the angle at the Northwest corner of DLC #56 to the stone at the North-Northeast corner of DLC #56 and to a point on the West boundary of DLC #56. Also made chain ties to monuments found on the South boundary of the tract monumented on Recorded Survey No. 1431 and to monuments set on the North boundary of tracts monumented on Recorded Survey Nos. 23 and 3187.

The procedures utilized on Recorded Survey No. 1431 were followed in establishing the Theoretical Southeast corner of Lot 3 of the Official plat of the "West-half of Donation Land Claim No. 56" showing the division among the heirs.

In order to establish the Southwest corner of said Lot 3, the original deeds of partitionment Recorded in Deed Volume 24, Pages 37 - 46 were compared with the plat lot distances and found that the West line of Lot 1 reports 8.83 chains wherein the plat shows 8.85 chains. A study of future deeds indicate the 8.83 chains dimension is the correct distance.

Refining the previous measurements of Recorded Survey No. 1431, the Southwest corner of Lot 3 was positioned by proportionate measurement, and the North boundary of the subject premises was located according to previous monuments set, which position falls 0.20' South from the position calculated from the more refined distances on this survey.