

9977

FD NE COR. DLG 46  
1 1/2" IRON PIPE



N BDY. D.R. 274-30 = WEST 1107.48'

COMPUTED WEST 1093.28'

D.R. 360-238,239

D.R. = S89°18'29" E 1063.49'

D.R. = N89°18'29" W 1063.39'

R.R. R/W

N 89° 47' 10" E 1093.78

D.R. = EAST 1106.75'

D.R. 89°54'

FD. 1/4 COR.  
"X" ON  
STONE

N 0°20'00" E

865.80'

D.R. = 869.9'

869.90'

SURVEY IN GOVT LOT 6, SECTION 21,  
T. 36S, R. 2W., W.M., JACKSON COUNTY, ORE.

FOR

REUBEN R. LARSON

SCALE 1" = 200'

SURVEY BY  
CHARLES H. HURST  
MEDFORD, OREGON

LEGEND

-x-x- FENCES  
● SET 5/8" X 24" IRON PINS

MEAS. N 0°06'50" W 2647.20'  
GOV'T REC. NORTH 2640.00'

5 1/2'

3 1/2'

1070.56'

WEST 1100.56' D.R. = 1106.75'

1703.50'

FD. SE COR. DLG 46  
1 1/2" CAPPED PIPE

REGISTERED  
OREGON  
LAND SURVEYOR

*Charles H. Hurst*

OCTOBER 30, 1959  
CHARLES H. HURST  
483

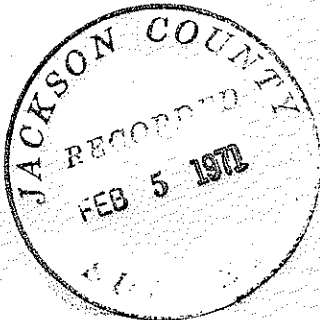

FEB 5 1971

21 22  
28 27

FD. SEC. COR. - CONC.  
MON. WITH BR. CAP

4466

SURVEY NARRATIVE TO COMPLY WITH PARAGRAPH 209.250

OREGON REVISED STATUTES

Survey for: Reuben R. Larson  
200 South Modoc  
Medford, Oregon 97501

Survey by : Charles H. Hurst, L.S.  
28 North Oakdale  
Medford, Oregon

Bearing : Based on the meridian for Recorded Survey No. 1486.

Purpose : To monument the south boundary of the tract shown on the attached plat.

PROCEDURE

Survey control was established on the section line at deed record. The DLC line was determined by double sighting at an intermediate point between both corners.

The client has been advised that a possible conflict of approximately one foot may exist along the southerly boundary of the railroad right-of-way as suggested by comparison with the dimensions shown on Recorded Survey No. 310.

Accordingly, the distance shown along said boundary are computer returned and have not been measured directly in the field since the latter was not commissioned by the client.

February 5, 1971

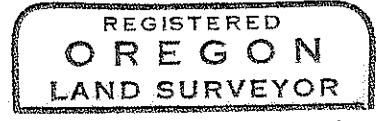
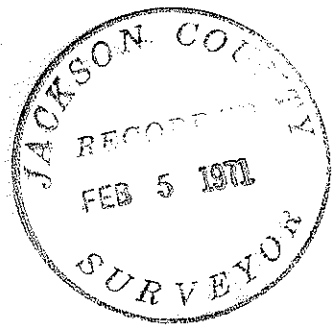

*Charles H. Hurst*

