

0787

1/4 COR. COMM. TO  
SEC'S 9 AND 16  
FD. BRASS DISC. FLUSH IN A.C.

EAST  
1601.43

D.R. VOL. 595 P. 486 J.C.O.

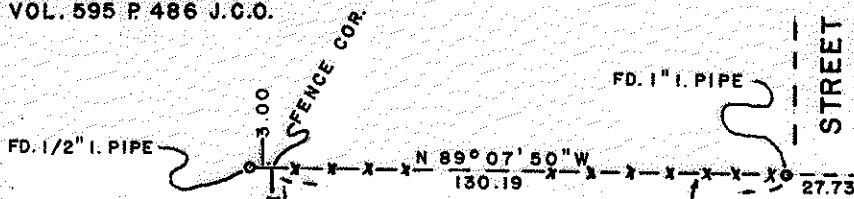

BOUNDARY LINE AGREEMENT  
SEE DOC. 70-08063 O.R. J.C.O.

STREET SOUTH  
1858.58  
BEACH  
N 0° 10' 00" W  
118.00

SCALE 1"=50'

BASIS OF BEARINGS  
R.S. NO. 4084

D.R. VOL. 351 P. 298 J.C.O.

D.R. VOL. 281 P. 608 J.C.O.

S 2° 20' 10" E  
360.53  
BOUNDARY LINE AGREEMENT  
SEE DOC. 70-09088 O.R. J.C.O.

N 0° 10' 00" W  
323.41  
RECORD NORTH  
186.32  
186.45

RECORDED SURVEY NO. 3081

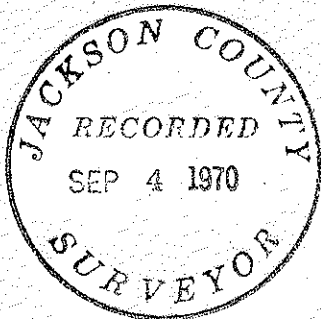

LEGEND

- = SET 5/8" X 24" I. PIN 4" DEEP
- X-X- = EXIST FENCE

N 89° 50' 00" E  
283.00

BOUNDARY LINE AGREEMENT SEE DOC. 70-08062 O.R. J.C.O.

15.00

D.R. 66-08129 O.R. J.C.O.

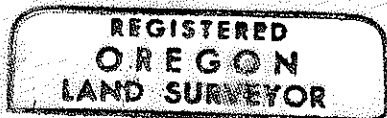

*George Burrell*

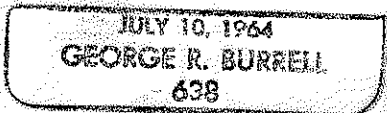

### MAP OF SURVEY

LOCATED IN THE S 1/2 N.E. 1/4 SEC. 16, T 39S R 1E  
FOR

W.E. BURNS

ASHLAND, ORE.

GEORGE BURRELL LAND SURVEYOR AUG. 23, 1970

4340

0787

SURVEY NARRATIVE TO COMPLY WITH O.R.S. 209.250  
REVISED BY CHAPTER 555, O.L. 1963

FOR: W.E. Burns  
c/o L.C. Ireland, Realtor  
1701 Siskiyou Blvd.  
Ashland, Oregon

PURPOSE: To monument and describe the present lines of occupation of the tract described in Vol. 351, Page 298, D.R., J.C.,O. as shown on the accompanying map for the purpose of establishment by mutual agreement, also to partition said tract as shown on the accompanying map.

PROCEDURE: The East line of said tract was established according to record, using the monuments of Recorded Survey No. 3081. The lines established by agreement were located according to the instructions of the parties involved. A search was made for the centerline monuments of Beach Street (see Vol. 444, Page 310, D.R., J.C.,O.) with negative results. In as much as these street monuments could not be recovered, the true position of said street and its Southerly terminus was therefore not determined by this survey.

REGISTERED  
OREGON  
LAND SURVEYOR

*George Burrell*

JULY 10, 1964  
GEORGE R. BURRELL  
638

JACKSON COUNTY  
RECORDED  
SEP 4 1970  
SURVEYOR