

JACKSON COUNTY
 RECORDED
 JUL 29 1969
 SURVEYOR

MAP OF SURVEY
 LOCATED IN
 N.E. 1/4 OF SECTION 13, T. 38 S., R. 2 W., W.M.
 JACKSON COUNTY OREGON
 FOR
 ROBERT E. TRETTIN

J. A. HOFFBUHR, REG. L.S., MEDFORD, OREGON
 SCALE: 1" = 100' JUNE 27 1969
 BASIS OF BEARING SOLAR OBSERVATION
 SET 5/8" X 24" IRON REINFORCING PIN

REGISTERED
 OREGON
 LAND SURVEYOR
J. A. Hoffbuhr
 NOVEMBER 7 1947
 J. A. HOFFBUHR
 232

T. 38 S., R. 2 W.
 T. 38 S., R. 1 W.
 137
 118
 WEST 683.39'

1/4 SECTION CORNER
 SET 5/8" X 24" IRON PIN
 50' W. CORNER AS PER
 5/8" X 24" IRON PIN
 BEARING OBSERVATION
 OF BEARING ON 2/7/5

The coordinated traverse was extended through the approximate locations of the two Westerly corners of the Claim line in question and around the perimeter of the tract to be surveyed. Ties were made to all the physical evidence that could be located in an attempt to retrace the original unrecorded and missing survey as nearly as possible.

After computing the traverse ties to the theoretical description corners and a 1 inch iron pipe was found, this corner is in the vicinity of the Northwest Corner of Donation Land Claim No. 51. Two unrecorded scribed Oak bearing trees were found near this erroneous corner.

It appeared that the Surveyor that prepared the clients description used a traverse hub of Surveyor Lovejoy's to prepare the descriptions, but not the Donation Land Claim Corner as stated. This made it necessary to then correlate the two surveys by bearing orientation in order that a retracement of the original survey could be made to avoid creating a conflict with the adjoining deeds. One other pipe was found, but due to the distance variations it was decided not to consider it.

As it is the policy of the Jackson County Engineer not to establish permanent right of way markers, it was found to be difficult and time consuming to re-establish the County right of way limits of Pioneer Road.

The North and West lines of the tract were positioned by the client as shown.

The centerline of the Water line Easement and the centerline of the Road Easement was traversed and described as shown.

July 28, 1969

J. A. Hoffbuhr
Registered Land Surveyor

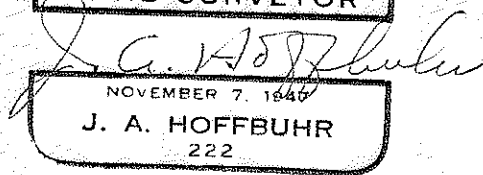
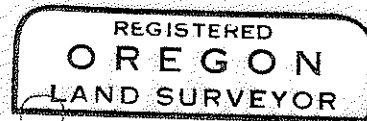
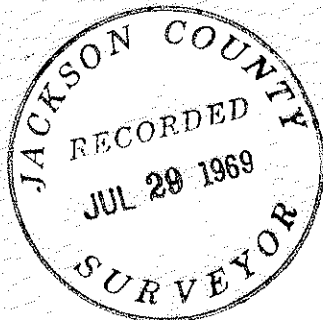

SURVEY NARRATIVE TO COMPLY WITH PARAGRAPH 209.250
OREGON REVISED STATUTES

SURVEY FOR: Robert E. Trettin
Route 4, Box 414C Pioneer Road
Medford, Oregon

LOCATION: Tract situate in the Northeast One Quarter (1/4)
of Section 13, Township 38 South, Range 2 West,
Willamette Meridian, Jackson County, Oregon.

PURPOSE: To monument the corners and prepare a description
of the parcel of land shown on the attached map,
also to define by legal descriptions the centerline
of the existing access road and the water line
easement as shown.

PROCEDURE: The description of the overall tract contains four
separate parcels and one exception as shown by the Recorded Deed
recorded in Jackson County Deed Records, Volume 601, Page 70. All
of the parcel descriptions, except Parcel #2, are described from the
Southwest Corner of Donation Land Claim No. 51.

A field search was made for this corner, but no evidence of
the corner or bearing trees could be found, although in March 1958,
Recorded Survey No. 1268 shows that Surveyor Lovejoy established a
record corner in this location. He does not indicate that he set
anything at the corner.

The client advised me at the first meeting, that the previous
owner had a map of a survey of the property and that the corners had
been set, a search was made, but none of them could be located and
the copy of the map was never produced.

Three solar observations were taken to obtain true bearing
control. The results of the three solars are as follows:

No. 1	S 47° 13' 39" E
No. 2	S 47° 13' 53" E
No. 3	<u>S 47° 14' 00" E</u>
Mean =	S 47° 13' 53" E

The results of the solars being well within the reasonable
tolerance limits were meaned as shown and this bearing was used as
a basis of bearings for the survey.

A coordinated control traverse was run from the re-established
One Quarter (1/4) Corner Common to Section 13, Township 38 South,
Range 2 West and Section 18, Township 38 South, Range 1 West,
Willamette Meridian. A 5/8 x 30 inch iron pin set 26 inches in the
ground was found for the corner and was verified by the recorded
distances to the bearing trees as shown in Recorded Survey No. 1357.
This corner was used because it was the nearest re-established corner
to the missing corner (Southwest Corner, Donation Land Claim No. 51).