

3853

3988'

FD. 1" IRON PIN
C-W-W 1/64 COR. PER
SURVEY NO. 1525

S 89°51'15" E

○ C 1/4 SEC. 25

25
26
FD. 1/4 COR.
2" IRON PIPE

GREGORY ROAD

D.R. 539-1

S 89°51'15" E

202.13'

121.75'

121.24'

EAST

202.13'

1323.67'

108.00'

108.00'

HAROLD ROAD

WEST

202.13'

S 0°03'20" W

HAROLD ROAD

202.84'

203.35'

N 89°51'15" W

202.13'

N 0°03'20" W

365.08'

SURVEY BY

CHARLES H. HURST, L.S.
MEDFORD, OREGON

FD. 1" IRON PIN
PER SURVEY NO. 1525

S 89°47'15" W

S 1/16 COR.

30.00'

GIBBON ROAD

ROAD

○ SW 1/16 COR.

FD. CONCRETE NAIL
SW-SW 1/64 COR.
PER SURVEY NO. 1525

SURVEY IN THE NW 1/4 SW 1/4
SECTION 25
T. 36 S., R. 2 W., W.M.
JACKSON COUNTY, OREGON

FOR

EVELYN TOMLINSON

&

C.H. CARLSON

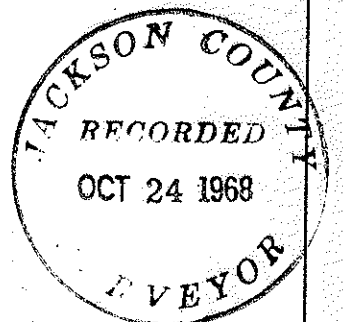

SCALE 1" = 100'

AUG 26 1968

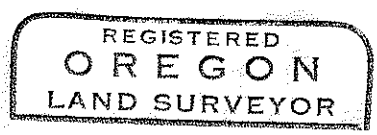

Charles H. Hurst

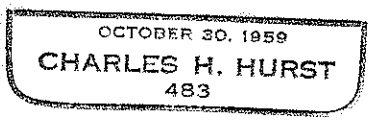

LEGEND

● SET 5/8" X 24" IRON PINS

- 3853

SURVEY NARRATIVE TO COMPLY WITH PARAGRAPH 209.250

OREGON REVISED STATUTES

Survey for Evelyn Tomlinson
6363 Harold Road & C. H. Carlson
Central Point, Oregon 6723 Chaparral
Central Point, Oregon

Survey by Charles H. Hurst, L.S.
28 North Oakdale
Medford, Oregon

Purpose To monument the corners and define the boundaries
of the tracts shown.

Bearing Based on the meridian of recorded survey No. 1525

PROCEDURE

Based on survey control previously established during the course of recorded survey No. 1525.

The south boundary of the most southerly tract established per senior deed per D.R. 571-494.

The south and north boundary of the center tract established per senior deed per D.R. 580-70.

The north boundary of the most northerly tract established per senior deed D.R. 539-1. Accordingly, the plus or minus call for the sideline lengths of said tract increases from 108 feet to close on south boundary of the tract to the north.

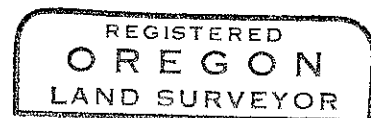
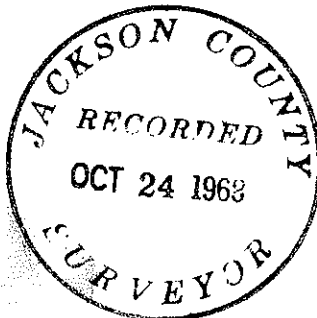

Charles H. Hurst

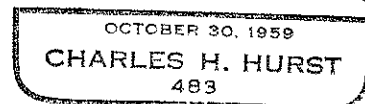

AUG 26 1968