

SCALE 1" = 100'

BASIS OF BEARING RECORDED SURVEY NO. 2641

- LEGEND
- SET 5/8" X 24" I. PIN
 - FND 3/4" I. PIPE UNLESS OTHERWISE NOTED

SURVEY
FOR

L.C. IRELAND ASHLAND, ORE.
OF TRACT
SITUATE IN SECTIONS 28 AND 29 T 38 S R 1 E WM.
GEORGE BURRELL L.S. ASHLAND, ORE.
JUNE 15, 1968



REGISTERED OREGON LAND SURVEYOR

George R Burrell

JULY 10, 1964
GEORGE R. BURRELL
638

SURVEY NARRATIVE TO COMPLY WITH O.R.S. 209.250
REVISED BY CHAPTER 555, O.L. 1963

FOR: L. C. Ireland
1200 Butler Creek Road
Ashland, Oregon

PURPOSE: To monument and describe the tract as shown on
accompanying map.

PROCEDURE: Using the monuments set in recorded survey 2641 as
control, I traversed the tract as shown on the
accompanying map. The Westerly Right of Way Line of
the Talent Irrigation District Canal was determined
by measuring 30 feet at right angles to the existing
center line. The 5/8 inch iron pin found near the
Southeast corner of said tract was apparently set in
recorded survey No. 2641 although not shown on that
survey map.

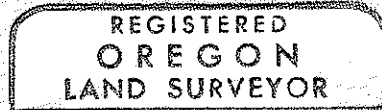
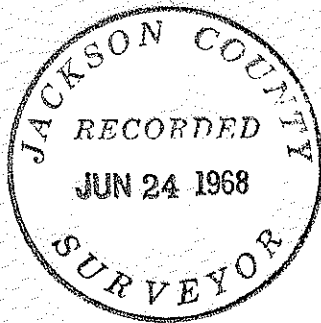

George R. Burrell

