

JACKSON COUNTY
RECORDED
JUN 17 1968
SURVEYOR

REGISTERED
OREGON
LAND SURVEYOR

Charles H. Hurst

OCTOBER 30, 1959
CHARLES H. HURST
483

JUN 3 1968

OREGON REVISED STATUTES

Survey for: Theodore & Agnes Werder
1312 Thomas Road
Medford, Oregon 97501

Survey by : Charles H. Hurst, L.S.
28 North Oakdale Avenue
Medford, Oregon 97501

Bearing : Based on meridian of recorded survey no. 291

Purpose : To define the boundary of D. R. 67-10443 minus
the exception parcel (D.R. 555-25).

PROCEDURE

Survey was made from previously set control established during the course of Recorded Survey No. 3456.

The south boundary of the tract shown was held at 180.00 feet north of the north boundary of D.R. 67-03442 per deed call based on computations from deed record.

Since iron monuments were found at the northeast and southwest corner of D.R. 345-101 as per deed call, said monuments were held superior and the west side thereof was determined by holding deed record frontage distance.

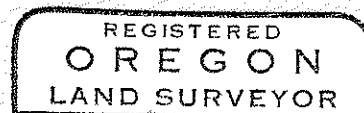
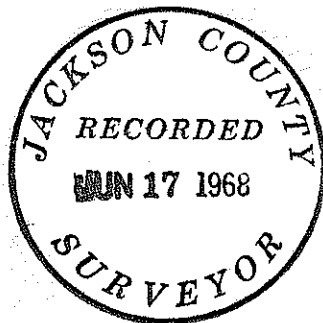

Charles H. Hurst

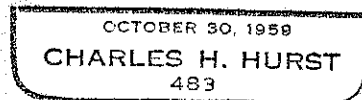

JUN 3 1968