

4026 3704

FD. 3/4" BOLT IDENTIFIED AS THE NW COR. OF DLC 70 PER SURVEY NO. 1667

FD. 1 1/4" IRON PIPE

FD. 1 1/4" IRON PIPE SHOWN AS THE NE COR. OF DLC 70 PER JACKSON COUNTY RD. DEPT. PLATS

FD. 1 1/2" IRON PIPE

TOP OF PIPE BENT 0.15' S OF LINE THRU BASE

FD. 1/2" IRON PIPE 15+48.14

BASIS OF BRG. SURVEY NO. 3193

FD. BR. CAPPED 1" IRON PIPE-REEST. NW COR. DLC 42 T. 38 S., R. 1 E.

FD. SPIKE 11+69.53 P.O.T.

SURVEY IN SECTION 24 T. 38 S., R. 1 W., W. M. JACKSON COUNTY, OREGON

FOR LYLE & LYDIA BEENEY SCALE 1"=100'

SURVEY BY: CHARLES H. HURST MEDFORD, OREGON

LEGEND ● SET 5/8" X 24" IRON PINS

SUNCREST ROAD

SUNCREST ROAD (NO. 56) PER JACKSON COUNTY RD. DEPT. FILE "B"

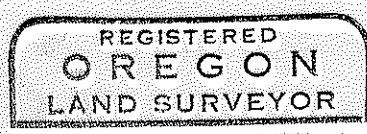
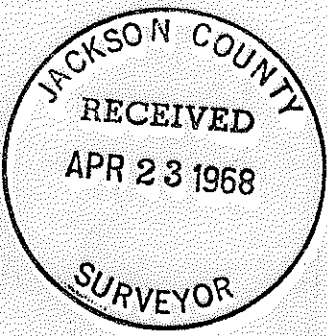

Charles H. Hurst

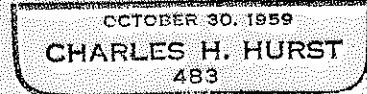

FEB 13 1968

4026 3704

SURVEY NARRATIVE TO COMPLY WITH PARAGRAPH 209-250

OREGON REVISED STATUTES

SURVEY FOR Lyle and Lydia Beeney  
Route 1, Box 263  
Talent, Oregon

SURVEY BY Charles H. Hurst, L.S.  
28 North Oakdale  
Medford, Oregon

BEARING Based on the meridian of Recorded Survey No. 3193.

PURPOSE To separate the parcel shown from the parent tract described in Volume 525, page 507 of Deed Records, Jackson County, Oregon.

PROCEDURE

The separated tract shown was defined at the request of the client who will retain contiguous ownership on three sides. Said tract was located by random line tie to the reestablished northwest corner of Donation Land Claim No. 42 according to the official record of the Jackson County Surveyor.

The north, east and south sides of said tract fall one foot outside a wood fence.

The county road center line was located from control established by the Jackson County Road Department during the course of a 1950 retracement of a 1910 road survey. The right-of-way width of 40 feet was held in the absence of information to the contrary and in view that several plats in the engineer's office indicate said width to be 40 feet. This conforms to the area excluded by fence lines adjacent to the county road.

The 1 1/4" iron pipe indicated as previously held for the northeast corner of Donation Land Claim No. 70 falls within reason to Government Record in relation to other corners in this area. No indication of original evidence per official notes remains. The northwest corner of Donation Land Claim No. 70 has been indicated to be a 1" iron pipe in times past. No pipe was found. However, the bolt shown falls at a fence intersection and has been held for the corner per Recorded Survey 1667. Distance South therefrom to the next corner is in harmony with that data secured by the Jackson County Road Department.

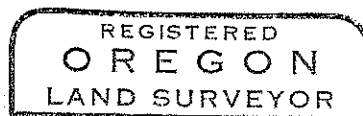
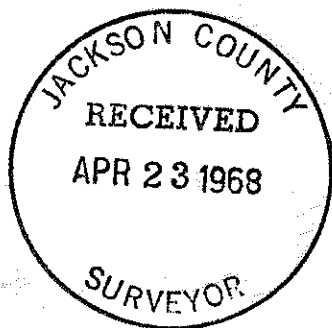

*Charles H. Hurst*

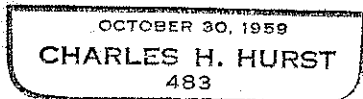

FEB 13 1968