

# CASCADE VILLAGE, UNIT No. 4

Being Located in A Portion of Vacated CASCADE VILLAGE,  
UNIT No. 2 and in the S.E. 1/4 of Sec. 17, T.36S., R.1W., W. M.

- o fd. 3/4" i. pin flush
- set 5/8" X 24" i. pin or set on Recorded Survey No. 3229
- x set 5/8" X 30" i. pin or set on Recorded Survey No. 3229

Basis of Bearings:  
CASCADE VILLAGE, UNIT No. 2

SCALE: 1" = 100'

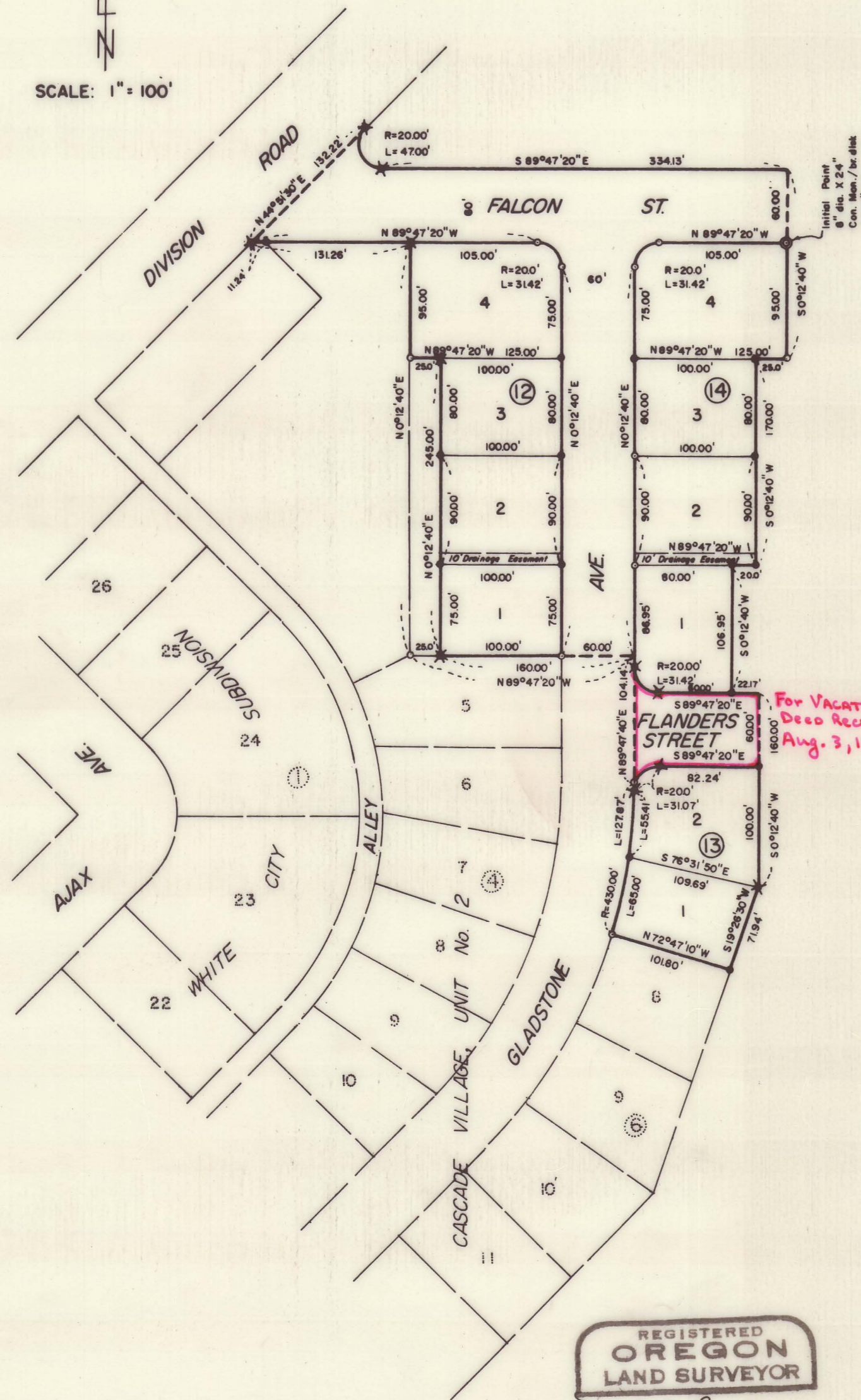

## DEDICATION

KNOW ALL MEN BY THESE PRESENTS, That we, White City Corporation, an Oregon Corp., Charles E. Kimmel and Gordon E. Peck, a co-partnership, dba, Kimmel and Peck Construction Company, David E. McClurg Jr. and Duane M. Ross, a co-partnership, dba, DAN-DE Construction Company and William Raymond Wilde and Wanda L. Wilde, husband and wife, are the owners in fee simple of the lands hereon described, and that we have subdivided the same into lots, blocks and streets as shown hereon, and the number and size of the lots and lengths of all lines are plainly set forth, and that this plat is a correct representation of the said subdivision, and we do hereby dedicate to the public for public use all streets and easements as shown hereon, and we do hereby designate said subdivision as, CASCADE VILLAGE, UNIT No. 4.

IN WITNESS WHEREOF, we have hereunto set our hands and seals this 13<sup>th</sup> day of February, 1967.

WHITE CITY CORPORATION

*Patrick Ford* Secretary  
*David M. Irving Sr.* Vice President

STATE OF OREGON } SS  
County of Jackson

On this 13<sup>th</sup> day of FEBRUARY, 1967, before me appeared David M. Irving Sr. and Patrick Ford, both to me personally known, who being duly sworn, did say that he, the said David M. Irving Sr. is the Vice President, and he, the said Patrick Ford, is the Secretary of the within named Corporation, and that the seal affixed to said instrument is the corporate seal of said Corporation, and that the said instrument was signed and sealed in behalf of said Corporation by authority of its Board of Directors, and David M. Irving Sr. and Patrick Ford acknowledged said instrument to be the free act and deed of said Corporation.

IN TESTIMONY WHEREOF, I have hereunto set my hand and affixed my official seal the day and year last above written.

*Shirley L. Benjamin*  
Notary Public for Oregon

My Commission expires the 1<sup>st</sup> day of SEPTEMBER, 1969.

KIMMEL & PECK CONSTRUCTION CO.

*Charles E. Kimmel* *Gordon E. Peck*  
Co-Partner Co-Partner

DAN-DE CONSTRUCTION CO.

*David E. McClurg Jr.* *Duane M. Ross*  
Co-Partner Co-Partner  
*William Raymond Wilde* *Wanda L. Wilde*

STATE OF OREGON } SS  
County of Jackson

Personally appeared the above-named Charles E. Kimmel and Gordon E. Peck, a co-partnership, Kimmel & Peck Construction Company, David E. McClurg Jr. and Duane M. Ross, a co-partnership, DAN-DE Construction Company and William Raymond Wilde and Wanda L. Wilde, husband and wife, and acknowledged the foregoing instrument to be their voluntary act and deed. Before me:

*Patrick Ford*  
Notary Public for Oregon

My commission expires the 1<sup>st</sup> day of October, 1967.

Examined and approved by the Rogue River Valley Irrigation District in regular session this 2<sup>nd</sup> day of May, 1967.

*Louise A. Beard* Secretary  
*Otto Bohner* President

Examined and recommended for approval by the Jackson County Court this the 10<sup>th</sup> day of April, 1967.

*Richard L. Jupp*  
Josephine County Surveyor

## SURVEYOR'S CERTIFICATE

STATE OF OREGON } SS  
County of Jackson

I, Mark E. Boyden a duly registered surveyor of the State of Oregon, being first duly sworn, do hereby certify that I have correctly surveyed and marked with proper monuments as provided by law the tract of land hereon shown and the said plat is a correct representation of the same, and the following is an accurate description of the boundary lines: Commencing at the quarter corner common to sections 19 and 20, Township 36 South, Range 1 West, Willamette Meridian, Jackson County, Oregon; thence North 3302.86 feet; thence East 4608.26 feet to an 8" diameter by 24" concrete monument with bronze disk set 6" below the ground surface for the initial point of beginning; thence South 0°12'40" West, 95.00 feet; thence North 89°47'20" West, 25.00 feet; thence South 0°12'40" West, 170.00 feet; thence North 89°47'20" West, 20.00 feet; thence South 0°12'40" West, 106.95 feet; thence South 89°47'20" East, 22.17 feet; thence South 0°12'40" West, 160.00 feet; thence South 19°26'30" West, 71.94 feet to an intersection with the North-easterly boundary of Lot 8, Block 6, CASCADE VILLAGE UNIT No. 2, according to the official plat thereof; thence along said Lot boundary, North 72°47'10" West, 101.80 feet to the most Northerly corner of said Lot; thence along the Easterly boundary of Gladstone Avenue, along the arc of a curve left 127.87 feet, (which arc has a radius of 430.00 feet and a long chord of North 8°43'50" East, 127.40 feet); thence along said Avenue boundary, North 0°12'40" East, 104.14 feet; thence North 89°47'20" West, 160.00 feet to and along the North-erly boundary of Lot 5, Block 4, of said CASCADE VILLAGE UNIT No. 2; thence North 0°12'40" East, 245.00 feet; thence North 89°47'20" West, 25.00 feet; thence North 0°12'40" East, 95.00 feet; thence North 89°47'20" West, 131.26 feet to the Southeastery boundary of Division Road; thence along said Road boundary North 44°51'30" East, 132.22 feet, thence along the arc of a curve left 47.00 feet (which arc has a radius of 20.00 feet and a long chord of South 22°27'55" East, 36.91 feet); thence South 89°47'20" East, 334.13 feet; thence South 0°12'40" West, 60.00 feet to the initial point of beginning.

EXCEPTING THEREFROM that portion of Gladstone Avenue presently dedicated.

*Mark E. Boyden*  
Surveyor

Subscribed and sworn to before me this 13<sup>th</sup> day of FEBRUARY, 1967.  
My Commission expires the 1<sup>st</sup> day of SEPTEMBER, 1969.

*Shirley L. Benjamin*  
Notary Public for Oregon

Examined and approved this 25<sup>th</sup> day of SEPTEMBER, 1967.

*Thad W. Watten*  
County Assessor

All taxes paid in full to date this the 20<sup>th</sup> day of May, 1967.

*Robert F. High*  
County Sheriff

Examined and approved for the use of Community Water Facilities and Community Sewage Disposal Facilities this the 3 day of May, 1967.

*Erin Markel, M.D.*  
County Health Officer

Examined and approved by the Jackson County Planning Commission in regular session this 21<sup>st</sup> day of JUNE, 1967.

Attest: *Gary Sumner* Secretary  
*Dorel K. Deenan* President

For Order of the County Court approving this plat see Volume \_\_\_\_\_ page \_\_\_\_\_ of County Commissioners Journal of Proceedings.

*Emm V. Cade*  
County Clerk

Filed for record this the 5 day of July, 1967 at 2:44 O'Clock P.M.

and recorded in Volume 11 of Plats at page 2 of Records of Jackson County Oregon.

*Emm V. Cade*  
County Clerk

I hereby certify that this tracing is an exact copy of the original plat filed with the County Clerk.

*Mark E. Boyden*  
Surveyor

Survey No. 3475

SURVEY NARRATIVE TO COMPLY WITH O.R.S. 209.250,  
REVISED BY CHAPTER 555, O.L. 1963

**FOR:** White City Corporation, Kimmel and Peck Construction  
Company, Dan-De Construction Company and William  
Raymond Wilde, et ux  
P. O. Box 526  
White City, Oregon

**PURPOSE:** To monument and plat a subdivision to be known as  
CASCADE VILLAGE UNIT NO. 4.

**PROCEDURE:** The land included in this subdivision is a part  
of that vacated portion of CASCADE VILLAGE UNIT NO. 2 and  
Falcon Street.

This survey simply entailed an adjustment in the  
size and depth of lots and established Falcon Street from  
Division Road to the Easterly boundary of this unit. Controls  
established on Unit No. 2 were used for this survey.

April 7, 1967

