

1/6 Cor. Set 1/2"x24" Iron Pipe
18" B. Oak brs. N. 18 1/2° E. 158.8'
Power Pole brs. S. 39 1/4° W. 138.0'
1/2" Iron Pipe unmarked and not
recorded brs. N. 38° 40' E. 2.00'

Fd. 1 1/2" Iron Pipe
as per Sur. *2535

W.C. Set 3/4"x30" Iron Pin
30" Maple brs. N. 75° W. 51.9'
30" B. Oak brs. S. 53° E. 41.6'

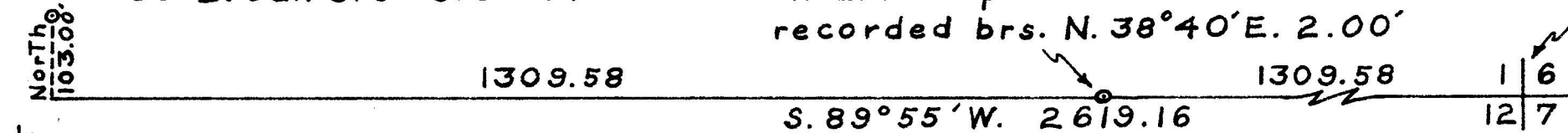

1/4 Cor.

PLAT

of a survey of north line of N.E. 1/4, Sec. 12
T. 35 S., R. 4 W., W.M., Jackson County Oregon

Meridian by Solar Observation

Scale 1" = 200'

Surveyed April 15, 1967

for

RICHARD OLYMPIUS
RT 1 Box 91
Rogue River, Oregon

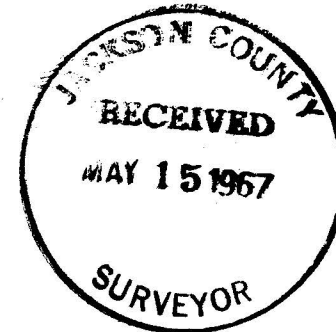

REGISTERED
OREGON
LAND SURVEYOR

Claude E. Masters

OCTOBER 24, 1958
CLAUDE E. MASTERS
457

SURVEY NARRATIVE to comply with paragraph 209.250, Oregon Revised Statutes.

SURVEY FOR: RICHARD OLYMPIUS
Rt. 1, Box 91
Rogue River, Oregon

PURPOSE: To establish the N.E. corner of the N.W. $\frac{1}{4}$, N.E. $\frac{1}{4}$, Section 12, T. 35 S., R. 4 W., W.M. Jackson County Oregon.

PROCEDURE: Commencing from the north east corner of section 12 proceeded west on a random traverse to a point for the witness corner to the north $\frac{1}{4}$ corner section 12. At the witness corner set a $\frac{3}{4}$ " x 30" iron pin from which;
30" Maple with blaze healed over brs. N. 75° W. 51.9'
The west fork of a 30" Black Oak with blaze healed over brs. S. 53° E. (record S. 53° W.) 41.6'
Opened the blaze on the Black Oak and found old chop marks and scribe marks.
Calculated the position of the true corner 103.00 ft. due south of the witness corner as per record re-established by County Surveyor. Returned to the calculated position of the 1/16 corner and finding no evidence of the corner as set by A. T. Brown in 1915, set said corner as shown on the Plat.

