

SURVEY IN SW. 1/4 SEC. 32 T.35S., R.1W., W.M.
 N.W. 1/4 SEC. 5 T.36 S., R.1W., W.M.

FOR
 FAYREX, INC.

66-28

BY EDWARD MCGINTY
 MEDFORD OREGON
 JANUARY 1967

SCALE 1" = 200'
 ● = 5/8" I.PIN SET
 ○ = 5/8" I.PIN FD.
 ⊙ = 1" I.PIPE FD.

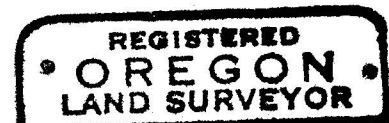
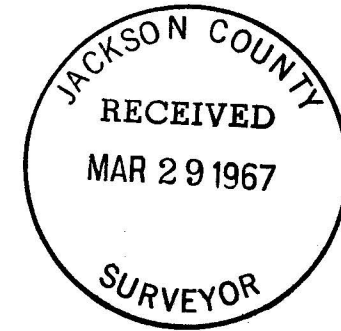

Edward A. McGinty
 JULY 10, 1953
 EDWARD A. MCGINTY
 301

Survey No. 3390

Survey Narrative to comply with O. R. S. 209-250:

Survey for: Faydrex, Inc.
1054 So. Riverside
Medford, Oregon

Survey by: Edward A. McGinty, L.S.
Medford, Oregon
Jan. 1967

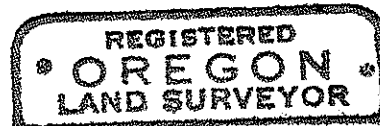

Edward A. McGinty



BASIS OF BEARING: Previous survey;

PRECEDENCE OF SURVEY:

Exterior boundaries were determined on previous survey.

Divided larger parcel into 13 tracts, as shown.

