

SURVEY NARRATIVE TO COMPLY WITH ORS 209.250,  
AMENDED BY CHAPTER 555, O. L., 1963.

FOR: OREGON STATE HIGHWAY DEPARTMENT  
P. O. BOX 368, MEDFORD, OREGON

PURPOSE: To re-establish and perpetuate the section corner common to Sections 5, 6, 7 and 8, Township 37 South, Range 1 West, Willamette Meridian.

PROCEDURE: During the reconstruction and widening of the Crater Lake Highway in this vicinity the original section corner was removed by the new construction. Prior to this time cross references were established and the corners were re-established after the new construction.

At the corner point, as re-established, a three quarter inch iron pin 42 inches long was driven in the ground. Said pin was placed inside a standard monument box set in the asphalt paving near the intersection of Coker Butte Road and the Crater Lake Highway.

Original referencing was done on October 21, 1965 and re-established points were set on November 22, 1966.

*B. E. Brown*

B. E. Brown  
Res. Engr.  
Oregon State Hwy Dept.  
Reg. Surveyor 375

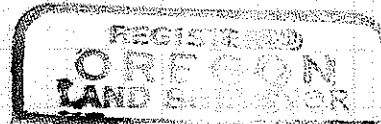
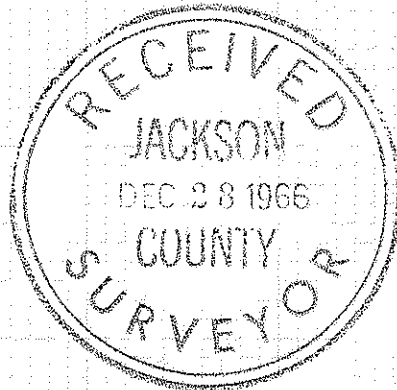

*Billy Eric Brown*

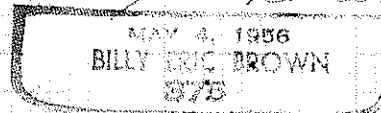

3301

12.79  
119.22  
132.01

OREGON STATE HIGHWAY DEPARTMENT  
TRANSIT SHEET

Form E23-20M-2-50-2321

Reference Trig. Sec. Cor.

6	5
7	8

7.275 EIM  
 In section  
 cover double end  
 6  
 113 center line Aug

Nail Shiner  
Cummins Diesel  
Asphalt Drive

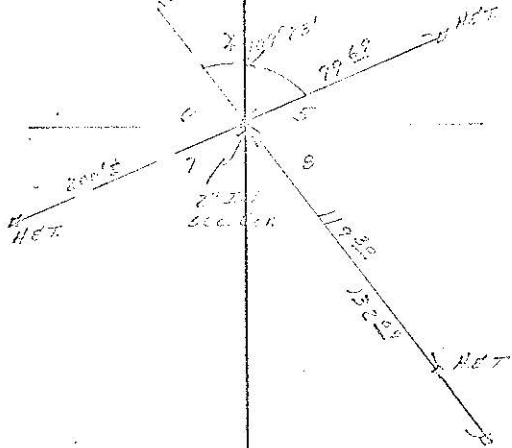

Re-established  
Nov. 22, 1900  
B. Brown

old 487 in danger  
of being lost  
Reference line  
extended 12.79  
132.01 total