

RESTORED CORNER FOR STATE OF OREGON-DEPARTMENT OF FORESTRY

One quarter corner common to Sections 4 and 5, T33S, R1E, W.M., Jackson County, Oregon.

ORIGINAL

Black Oak Post (rotted wood in hole in place) from which a:

- 20" Black Oak bears N82E 21 lks.; now 22" badly rotted stump in place, rotted log on ground with axe work remaining.
- 8" Black Oak bears N78W 63 lks.; now 16" rotted stump in place, rotted log on ground with axe work remaining.

RESTORATION by C. Z. Boyden, Dep. C. S. (no date)

Found original BT to NE with $\frac{1}{4}$ S scribe damaged by fire etc. (see records)

- 22" Black Oak bears N53 $\frac{1}{2}$ E 21.1 ft.; now 26", scribes CS BT.
- 14" Black Oak bears S40 $\frac{1}{2}$ W 96.6 ft.; now 20", face covered.
- 6" x 6" granite stone bears S24 $\frac{1}{2}$ E 5.2 ft.; found in place, large X on top.

RESTORED

Set 1 $\frac{1}{2}$ " x 36" galvanized iron pipe with 3" bronze cap marked "OREGON STATE BOARD OF FORESTRY $\frac{1}{4}$ S4 S5 1964 RS359", and from which a:

24" Ponderosa Pine bears N64W 49.7 ft.; scribed $\frac{1}{4}$ S5 BT RS 359.

Set 4 x 4 x 72" white painted Cedar post 1.0 ft. SW of corner pipe. Oregon State Forestry Department metal location poster on 20" Fir S3W 34.2 ft.

Dated January 21, 1965

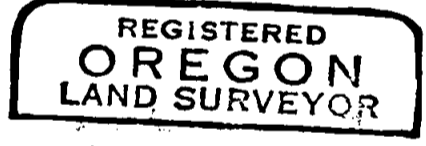

Restored by

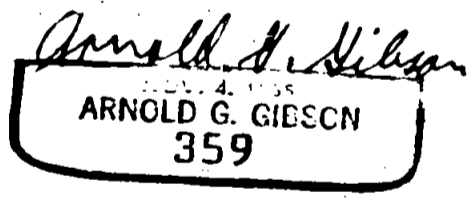

Present and witnessed by R. Olson
M. Pounds

