

2683

Survey For:
ROBERT C. TAYLOR
Located in the
SE 1/4 Sec. 24, T37SRIW, WM
By: Mark E. Boyden
Jan. 15, 1965

1/4 Sec. Cor.
fd. both orig. B.T.'s.
Set 1" i. pipe/br. cap
exp. 6" with new
re-estab. B.T.'s.

REGISTERED
OREGON
LAND SURVEYOR
Mark E. Boyden
NOVEMBER 9 1961
MARK E. BOYDEN
281

RECEIVED
JACKSON
JAN 19 1965
S COUNTY
SURVEYOR



SCALE: 1" = 400'

● Set 5/8" X 24" i. pin
flush

Basis of Bearings:
Recorded Survey #557
Rotated 0°00'40" Clockwise
For Convergency

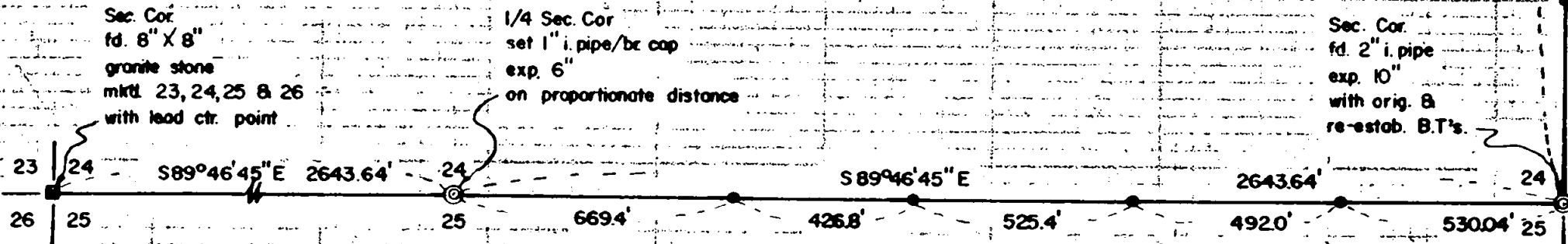

Sec. Cor.
fd. 8" X 8"
granite stone
mk'd 23, 24, 25 & 26
with lead ctr. point

1/4 Sec. Cor.
set 1" i. pipe/br. cap
exp. 6"
on proportionate distance

Sec. Cor.
fd. 2" i. pipe
exp. 10"
with orig. &
re-estab. B.T.'s.

2683

Survey No. 2683

SURVEY NARRATIVE TO COMPLY WITH O.R.S. 209.250
REVISED BY CHAPTER 555, O.I. 1963

FOR: Robert C. Taylor
2177 South Pacific Hwy.
Medford, Oregon

PURPOSE: To establish the true South and East boundaries of the Southeast quarter of Section 24, Township 37 South, Range 1 West, and set line pins along said boundaries as shown.

PROCEDURE:

Began the survey at the Southwest corner of Section 24, and foresighting the 6" x 6" concrete monument with bronze disk located at the Northwest corner of the section, traversed by transit-chain to the Southeast corner and then to the East quarter corner of said section.

Coordinated the random traverses, and at a point midway and on line between the Southwest and Southeast corners of said Section 24, after finding no evidence of the original quarter corner of its accessories, set a 1" galvanized iron pipe with bronze cap for corner and established new bearing trees (see corner re-establishment volume - County Surveyor's office).

Also calculated offsets from the random traverse to true line and set iron pins for line control as shown.

January 15, 1965

