

SURVEY FOR SOUTHERN OREGON TITLE CO. 112 W. MAIN ST. MEDFORD, OREGON
 LOCATED IN N.W 1/4 S 8, T 37 S. R. 1 W. JACKSON COUNTY, OREGON.
 DATE NOV 3, 1964 Bearings from Survey 24-64

SCALE 1" = 200'

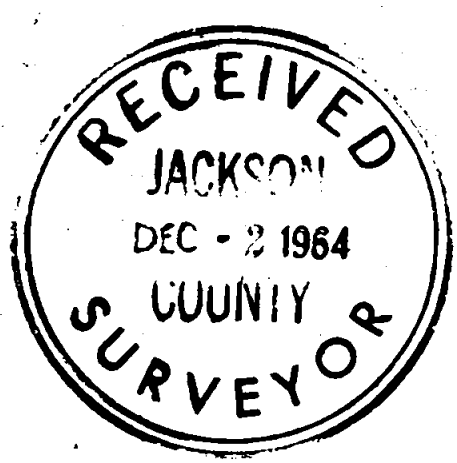

REGISTERED
 OREGON
 LAND SURVEYOR
L. N. Dow
 MAY 6, 1949
 L. N. DOW
 251

COKER BUTTE ROAD

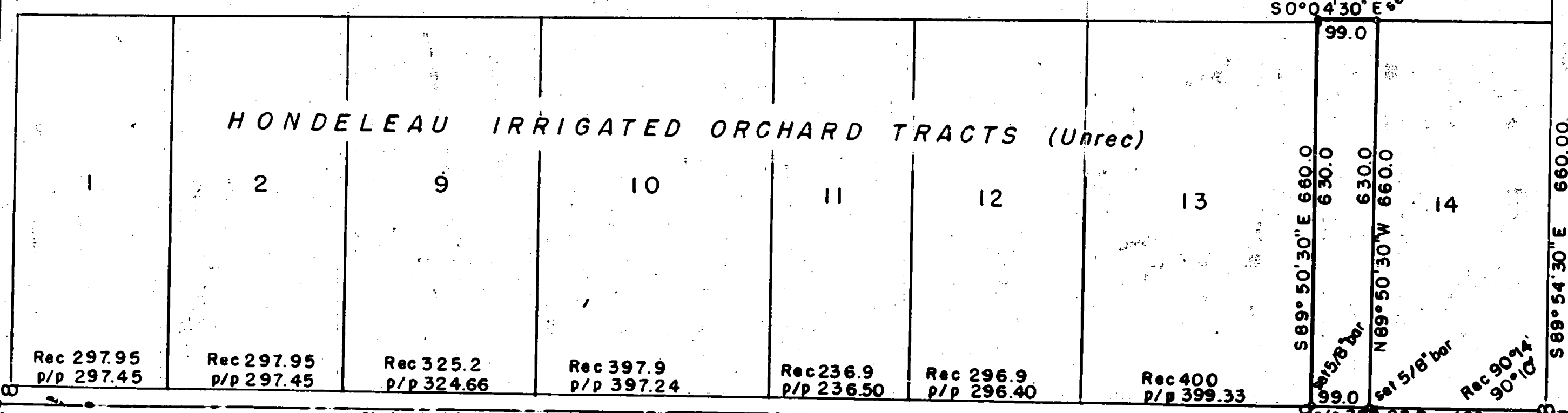

1	2	9	10	11	12	13	14
Rec 297.95 p/p 297.45	Rec 297.95 p/p 297.45	Rec 325.2 p/p 324.66	Rec 397.9 p/p 397.24	Rec 236.9 p/p 236.50	Rec 296.9 p/p 296.40	Rec 400 p/p 399.33	

Chained 2646.37 HONDELEAU (unrec) 2652.8
 CRATER LAKE AVE
 50°04'30" E
 Rec South
 5/8" Bar found

Written narrative to accompany plat for Survey No. 2647

2647

Survey for Southern Oregon Title Co. 112 W Main St. Medford, Oregon.

Date November 3, 1964 Bearings from Survey No. 2464

Purpose to locate the north 1 1/2 Acres of Lot 14 Hondeleau Irrigated Orchard tracts.

Having previously used the Section corner 5,6,7 & 8 at the intersection of Crater Lake Avenue and Coker Butte Road, and also the 1/4 Section corner 1/2 mile south of the above. we rechecked the distance between said points, and check our previous filed distance for this item.

Then from the distances given on the Hondeleau Irrigated Orchard tracts (unrecorded) we set up the prorate distances as shown on the attached plat.

From the above controls we then set 5/8" x 24" bars for the corners as shown.

