

SEC 31

55

52

FIRST ST

ST

SUR. NO. 1673

PROPOSED OREGON ST

60

ELM ST

56

OAK ST

53

FIR ST

29

PINE ST

28

MAIN ST

CALIFORNIA ST

FD 3/4" PIPE

369.67'

431.50'

398.50'

S 43° 40' 40" W

389.00'

405.50'

OREGON ST

200.0'

27

206.25'

S 22° 34' 20" W

S 88° 42' 30" W 24.35'

N 0° 22' 40" E 528.00'

61

57

54

APPROX 1869 LOCATION

30

1909 RD. LOCATION

1909 RD

1/4 COR

58

S 22° 34' 20" W

62

1909 RD

THIRD ST

62

SURVEY IN CITY OF JACKSONVILLE  
FOR  
CITY OF JACKSONVILLE

BY EDWARD A MCGINTY  
MEDFORD OREGON  
J.A.N 1964

SCALE 1" = 100'  
1/2" I.PIN FD = ○  
5/8" I.PIN = ●  
3/4" I.PIN = ○

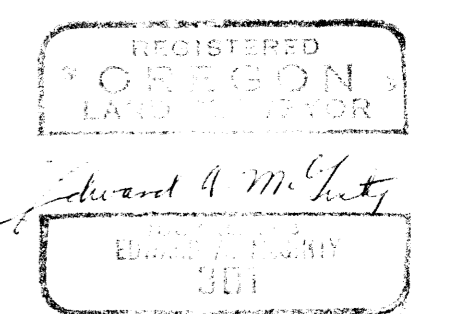
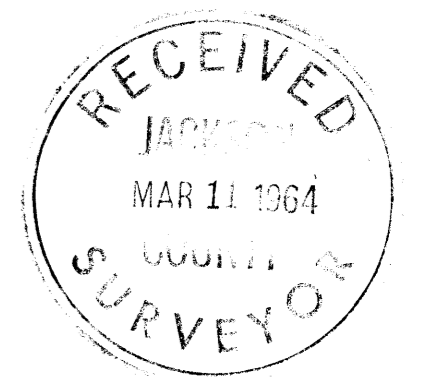

Survey No. 2449

Survey Narrative to comply with O.R.S. 209-250:

Survey for: City of Jacksonville

Survey by: Edward A. McGinty, L.S.

2/1/64

LOCATION: City of Jacksonville, in the Northwest corner of Section 32  
Township 37 South, Range 2 West, WM.

BASIS OF BEARING: Survey No. 1339

PRECEDENCE OF SURVEY:

At the request of the City of Jacksonville, surveyed and monumented Oregon Street.

This was done, taking into consideration the following evidence:

1. The plat of the City of Jacksonville and ties along Oregon St. to the Section line.
2. Existing older fence lines which have been recognized as property lines along the westerly side of Oregon St. and Blk. 26, 29 & 53.
3. 2 iron pins and 3 iron pipes found close to the westerly line of Oregon Street.
4. Record bearing in road petition and deed records.

From this survey found that in Blk. 56 the fence line bears westerly approx. 1.0 feet and 2.0 to 3.0 feet in the center of Blk. 60 (note; this Blk. survey was made by Ager, approx. in 1945 for Hartman)

A large portion along the easterly side of Oregon St. near the southerly end is now fenced by adjacent owners.

Made a search on older deed recitals, found calls of property to the easterly line of Oregon St., but later deed calls, holding distance, would over-lap in Oregon St.

Made a search on possible vacation and found none.

The un-recorded survey by L. Ager in block 60 shows an angle point in Oregon St., also Blk. 60 being in excess of 55 feet longer than the plat indicates, also that the section line as shown by Ager, varies considerable further west. His survey does not show the tie to Section corner north or south.

Agers map would be in considerable conflict with this survey, survey No. 1673, City of Jacksonville plat, and old deeds and monuments.

Improvements on Lot 3 Blk. 29 and Lot 1, Blk. 30 extend approx. 7.5 ft. into Pine St., also frontage as occupied extended the same, also the conflict in deed recital from metes and bounds in said deed holding distance are in conflict with the plat about approx. the same amount.

The following monuments were set:

At an angle point in Oregon St., set a 3/4 in. x 30 in. iron pin, 6 in. deep.

At Oregon at Pine St., set a 5/8 in. x 24 in. iron pin, 6 in. deep.

At Oregon St. at Fir St., set a 3/4 in. x 30 in. iron pin, 6 in. deep.

At the end of Oregon St., set 2 iron pins 5/8 in. x 30 in. 6 in. deep.

On the center line of a 1909 road location, S. 89°42'30"W., 24.35 ft. (record West 24.00) set a 5/8 in. x 24 in. iron pin in a sand stone being a 1909 road point, 6 ins. deep.

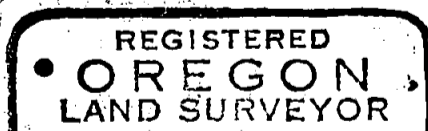

*Edward A. McGinty*

JULY 10, 1953  
EDWARD A. MCGINTY  
301

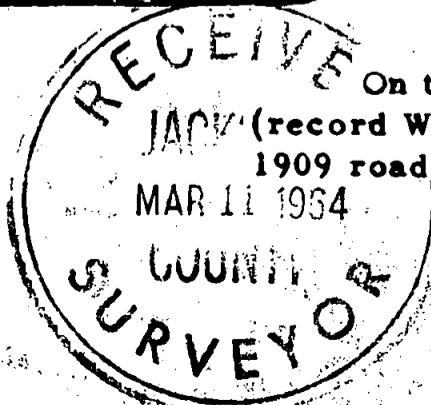

SEC 31

55

52

FIRST ST

ST

SUR. NO. 1673

PROPOSED OREGON ST

60

ELM ST

56

OAK ST

53

FIR ST

29

PLINE ST

26

369.67'

60.0'

60.0'

60.0'

60.0'

431.50'

398.50'

389.00'

405.50'

235.87'

S 43° 40' 40" W

OREGON ST

200.01'

54

APPROX 1869  
LOT LOCATION

57

27

30

S 89° 42' 30" W 24.35'

N 10° 22' 40" E 52.8.00'

61

1909 RD. LOCATION

1909 RD

1/4 COR

58

S 82° 34' 20" W

62

1909 RD

THIRD ST

62

SURVEY IN CITY OF JACKSONVILLE  
FOR  
CITY OF JACKSONVILLE

BY EDWARD A MCGINTY  
MEDFORD OREGON  
JAN 1964

SCALE 1" = 100'  
1/2" 1 PIN FD  
5/8" 1 PIN  
3/4" 1 PIN

