

SURVEY FOR:
KAREN HOBBS
PO BOX 1332
JACKSONVILLE, OR 97530

SURVEY BY:
L.J. FRIAR & ASSOCIATES, P.C.
CONSULTING LAND SURVEYORS
PO BOX 1947
PHOENIX, OR 97535
PHONE: (541) 772-2782
LJFRIARANDASSOCIATES@CHARTER.NET

DATE:
DECEMBER 27, 2023

MAP OF SURVEY

In Lot 4, Block 49 of the Town of Central Point
& located in the S.W. 1/4 of Sec. 2, T.37S., R.2W., W.M.
City of Central Point Jackson County, Oregon

LEGEND:

- = FD. 5/8" IRON PIN & PLASTIC CAP MKD. KAISER RLS803 PER FS15881.
- = SET 5/8" IRON PIN & PLASTIC CAP MKD. L.J. FRIAR & ASSOC.
- ORJCO = OFFICIAL RECORDS OF JACKSON COUNTY, OREGON.
- X- = FENCE LINE.
- () = RECORD DATA PER PLAT OF CENTRAL POINT.
- FS = FILED SURVEY #.

BASIS OF BEARINGS:

SURVEY NO. 15881 AS SHOWN HEREON.

UNIT OF MEASUREMENT = FEET

SCALE: 1" = 10'

SURVEY NARRATIVE TO COMPLY WITH O.R.S. 209.250

PURPOSE: TO SURVEY AND MONUMENT THE EXTERIOR BOUNDARY OF THAT PROPERTY SET FORTH IN DOC. 2018-000418, ORJCO.

PROCEDURE: USING 2 TRIMBLE R10 G.P.S. RECEIVERS, MADE TIES TO MONUMENTS OF RECORD AS SHOWN HEREON. USED MAP RECORD DATA PER FS15881 TO POSITION THE MOST NLY. CORNER OF THE SUBJECT TRACT AND SET MONUMENT AS SHOWN HEREON.

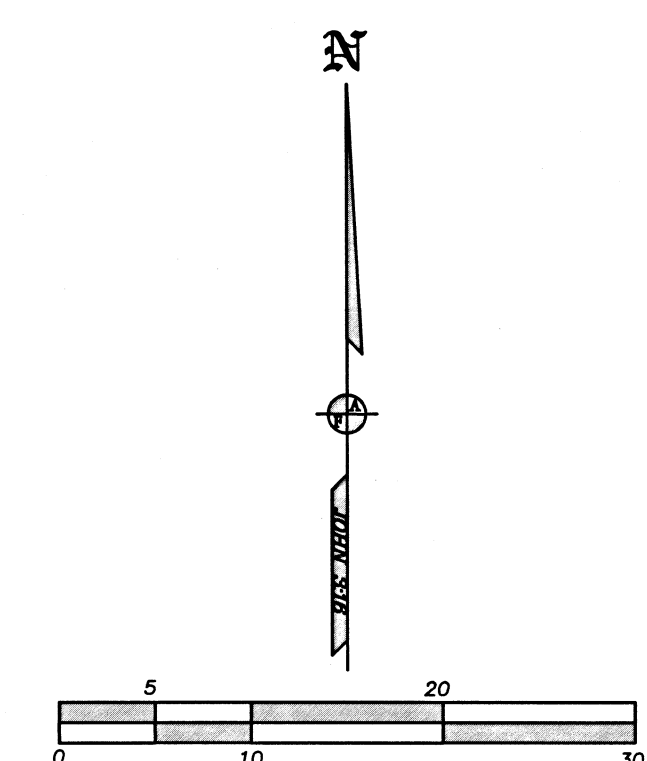

REGISTERED PROFESSIONAL LAND SURVEYOR
J. Friar
 OREGON
 JULY 17, 1986
 JAMES E. HIBBS
 2234
 RENEWAL DATE: 6-30-25

FILED
 Date 1/24/24 By *JB*
 This Survey Consists Of:
 1 sheet(s) Map
 0 page(s) Narrative
 JACKSON COUNTY SURVEYOR